

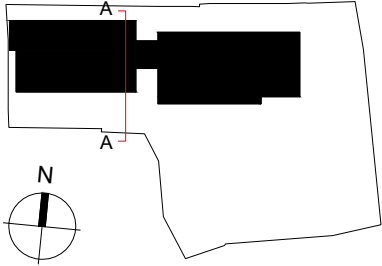

Section AA

KEY PLAN



**DRAWING NOTES**

1. filename: -

2. Use figured dimensions only. Detailed site survey to be carried out to establish tolerances. Figured dimensions are in mm. All dimensions shall be verified on site before proceeding with the work. The architect shall be notified of any discrepancies.

3. This drawing has been produced for sole use on this project and is not intended for use by any other person or for any other purpose. © Copyright RSS (U.K.)

4. All printed copies should be made at 100% of the original page size. Use scale bars, where included, to check that the drawing has been printed to the intended scale as identified in the drawing title block.

5. This drawing is not intended for construction unless specifically described as such.

REVISIONS		
REV	DATE	STATUS
C07	12.11.24	Issued for Planning
Changes since last issue:		
-		

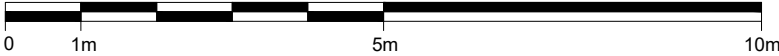

28 NAVIGATION ROAD LONDON E3 3TG

T : 020 7739 8945

E : rss@rssa.co.uk

www.rivingtonstreetstudio.co.uk

rivingtonstreetstudio

job title

Burnside Secondary School

drawing title

Proposed Section AA

drawn by

job no.

suitability

revision

PROJECT

ORIGIN

VOLUME

LEVEL

TYPE

ROLE

NUMBER

TO

1026

S4

C07

SRP1055

RSS

\_XX

\_ZZ

\_D

\_A

\_1310

scale

1:100 @ A3