

Copyright Hawkins\Brown Architects
 No implied licence exists. This drawing should not be used to calculate areas for the purposes of valuation. Do not scale this drawing. All dimensions to be checked on the site by the contractor and such dimensions to be their responsibility. All work must comply with relevant British Standards and Building Regulations requirements. Drawing errors and omissions to be reported to the architect. To be read in conjunction with Architect's specification and other consultant information.

Rev	Description	Date
P1	Planning Submission	August 2021
P2	Updated for Planning Submission	December 2021
P3	NMA Planning Submission	May 2023
P4	Updated for NMA Planning Submission	June 2023
P5	Section 73 Planning Submission	July 2023
P6	Updated for S73 application (2024)	November 2024

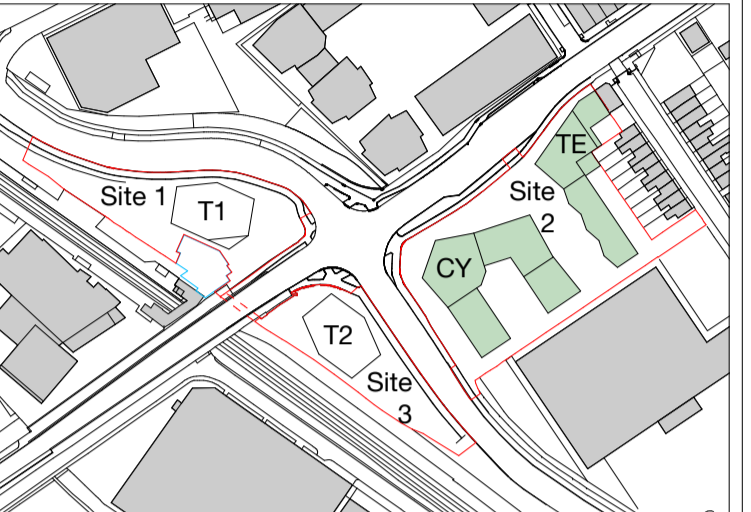

Key	
1B1P	Access for maintenance only
1B2P	Residential Amenity Roof
2B3P	Biodiverse Roof
2B4P	
3B4P	
3B5P	
4B5P	
—	Site Boundary
—	Consented Lea Bridge Station

North
 Please refer to Landscape Architect's Drawings for further details of the Proposed Landscape.
 159 St John Street London EC1V 4JQ
 mail@hawkinsbrown.com
 hawkinsbrown.com

Hawkins\Brown

Project
Lea Bridge Station Sites
 Argall Way
 London E10 7PG
 United Kingdom

Drawing
Site 2 - Proposed Roof Access Plan

Scale @ A1 1:200	Date November 2024
---------------------	-----------------------

Drawn By LP	Checked By JC
----------------	------------------

Job Number 190109	Status A2	Purpose of Issue For Planning
----------------------	--------------	----------------------------------

Drawing No. LEABR-HBA-S2-11-DR-A-08-0191	Rev P6
---	-----------

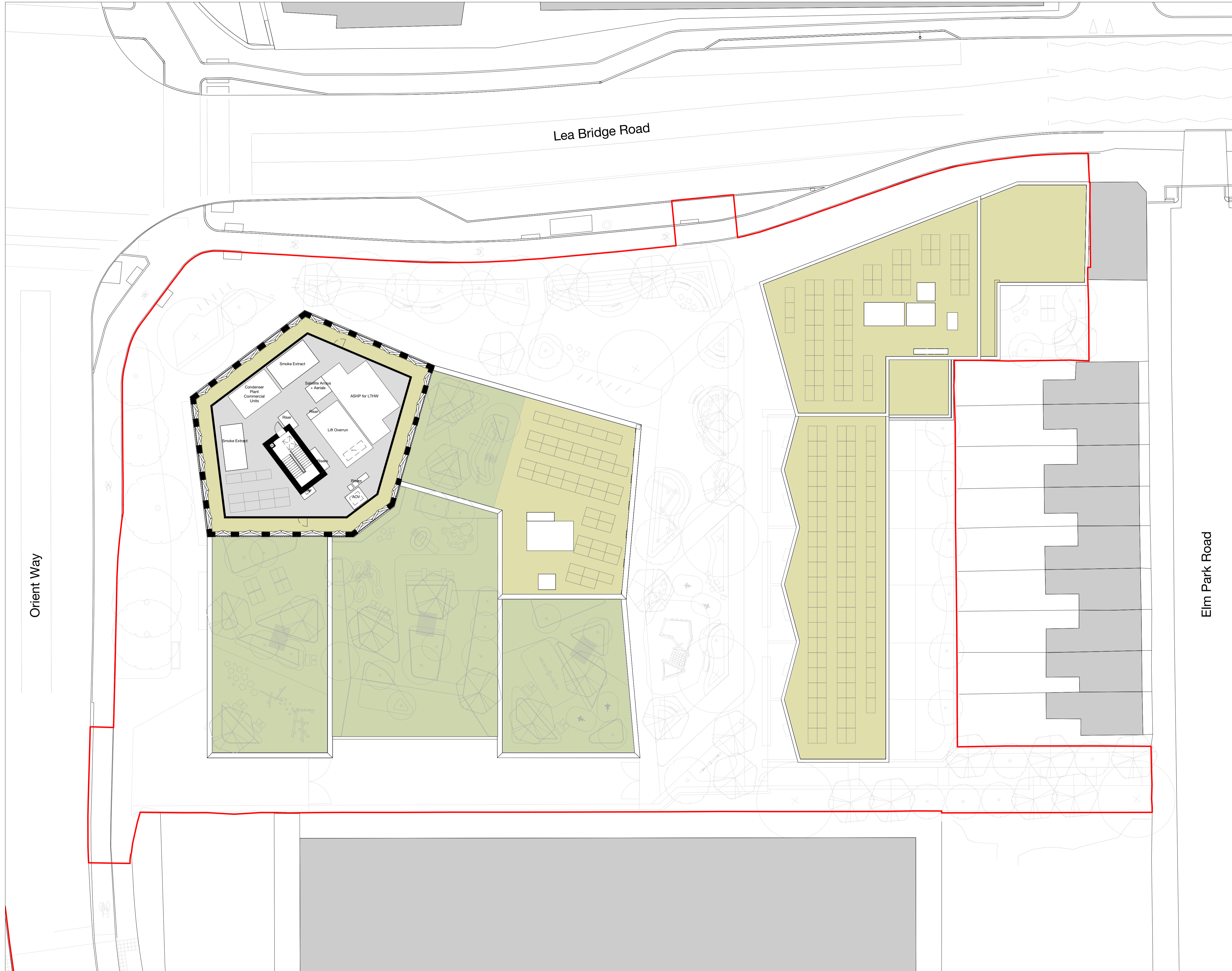

1 Site 2 - Proposed Roof Access Floor Plan
 1 : 200

