

Copyright Hawkins\Brown Architects  
 No implied licence exists. This drawing should not be used to calculate areas for the purposes of valuation. Do not scale this drawing. All dimensions to be checked on the site by the contractor and such dimensions to be their responsibility. All work must comply with relevant British Standards and Building Regulations requirements. Drawing errors and omissions to be reported to the architect. To be read in conjunction with Architect's specification and other consultant information.

Rev	Description	Date
P1	Planning Submission	August 2021
P2	Updated for Planning Submission	December 2021
P3	NMA Planning Submission	May 2023
P4	Updated for NMA Planning Submission	June 2023
P5	Section 73 Planning Submission	July 2023
P6	Updated for S73 application (2024)	November 2024

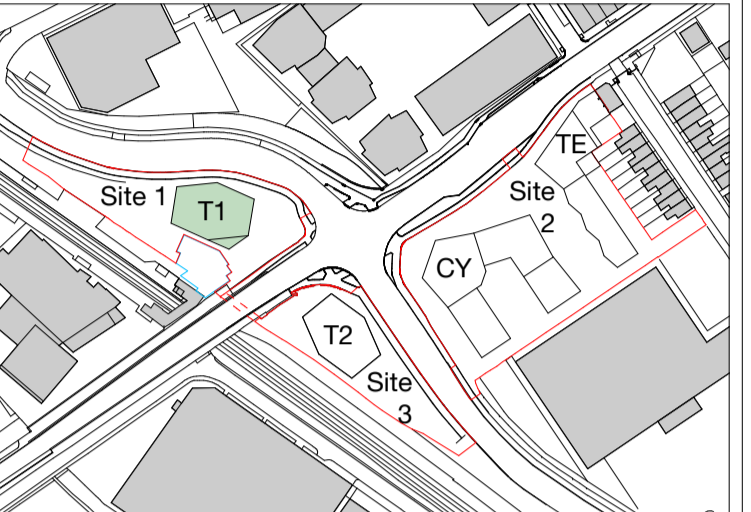

Key	
1B1P	Access for maintenance only
1B2P	Residential Amenity Roof
2B3P	Biodiverse Roof
2B4P	
3B4P	
3B5P	
4B5P	
—	Site Boundary
—	Consented Lea Bridge Station

North  
 Note: The Consented Lea Bridge Station Proposal is shown on the drawings.  
 Please refer to Landscape Architect's Drawings for further details of the Proposed Landscape.  
 159 St John Street London EC1V 4QJ  
 mail@hawkinsbrown.com  
 hawkinsbrown.com

# Hawkins\Brown

Project  
 Lea Bridge Station Sites  
 Argall Way  
 London E10 7PG  
 United Kingdom

Drawing  
 Site 1 - Proposed Seventeenth Floor Plan

Scale @ A1  
 1:200  
 Date  
 November 2024

Drawn By  
 PQC  
 Checked By  
 JC

Job Number  
 190109  
 Status  
 A2  
 Purpose of Issue  
 For Planning

Drawing No.  
 LEABR-HBA-S1-17-DR-A-08-0167  
 Rev  
 P6

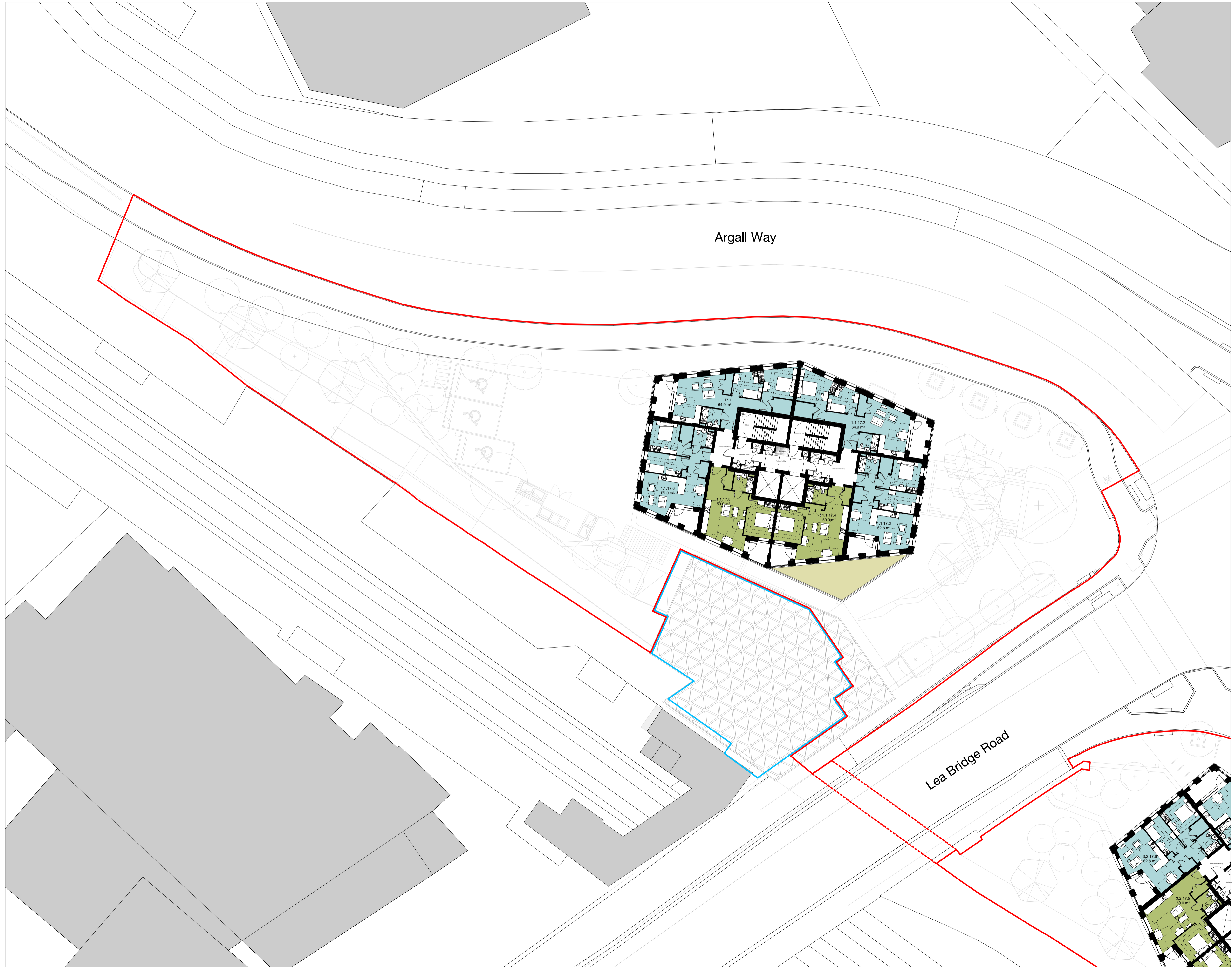

**1** Site 1 - Proposed Seventeenth Floor Plan  
 1 : 200

