

Copyright Hawkins\Brown Architects
 No implied licence exists. This drawing should not be used to calculate areas for the purposes of valuation. Do not scale this drawing. All dimensions to be checked on the site by the contractor and such dimensions to be their responsibility. All work must comply with relevant British Standards and Building Regulations requirements. Drawing errors and omissions to be reported to the architect. To be read in conjunction with Architect's specification and other consultant information.

Rev	Description	Date
P1	Planning Submission	August 2021
P2	Updated for Planning Submission	December 2021
P3	NMA Planning Submission	May 2023
P4	Updated for NMA Planning Submission	June 2023
P5	Section 73 Planning Submission	July 2023
P6	Updated for S73 application (2024)	November 2024

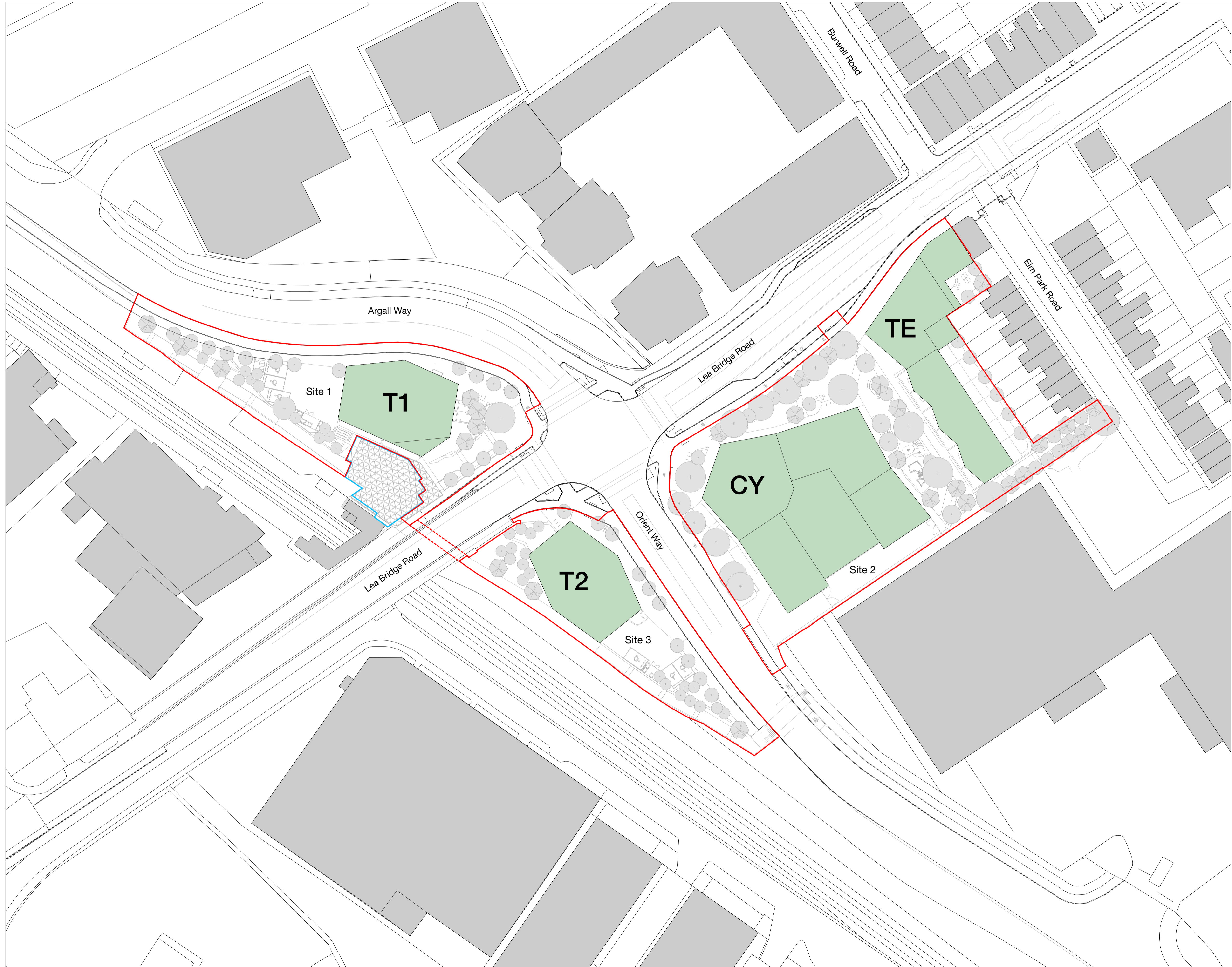

Key
 — Site Boundary
 — Consented Lea Bridge Station

Note: The Consented Lea Bridge Station Proposal is shown on the drawings.

North
 Please refer to 1:200 Plan drawings for proposed levels.
 Please refer to Landscape Architect's Drawings for further details of the Proposed Landscape.

159 St John Street London EC1V 4QJ
 mail@hawkinsbrown.com hawkinsbrown.com

Hawkins\Brown

Project
 Lea Bridge Station Sites
 Argall Way
 London E10 7PG
 United Kingdom

Drawing
 Proposed Site Plan

Scale @ A1 1:500 Date November 2024

Drawn By PQC Checked By JC

Job Number 190109 Status A2 Purpose of Issue For Planning

Drawing No. LEABR-HBA-00-XX-DR-A-08-0020 Rev P6

1 Proposed Block Plan
 1 : 500

