

ACCESS CONTROL PANEL FOR BUSINESS CENTRE UNDERCROFT 100m2

ACCESS CONTROL PANEL FOR CYCLE STORE

GROUND FLOOR

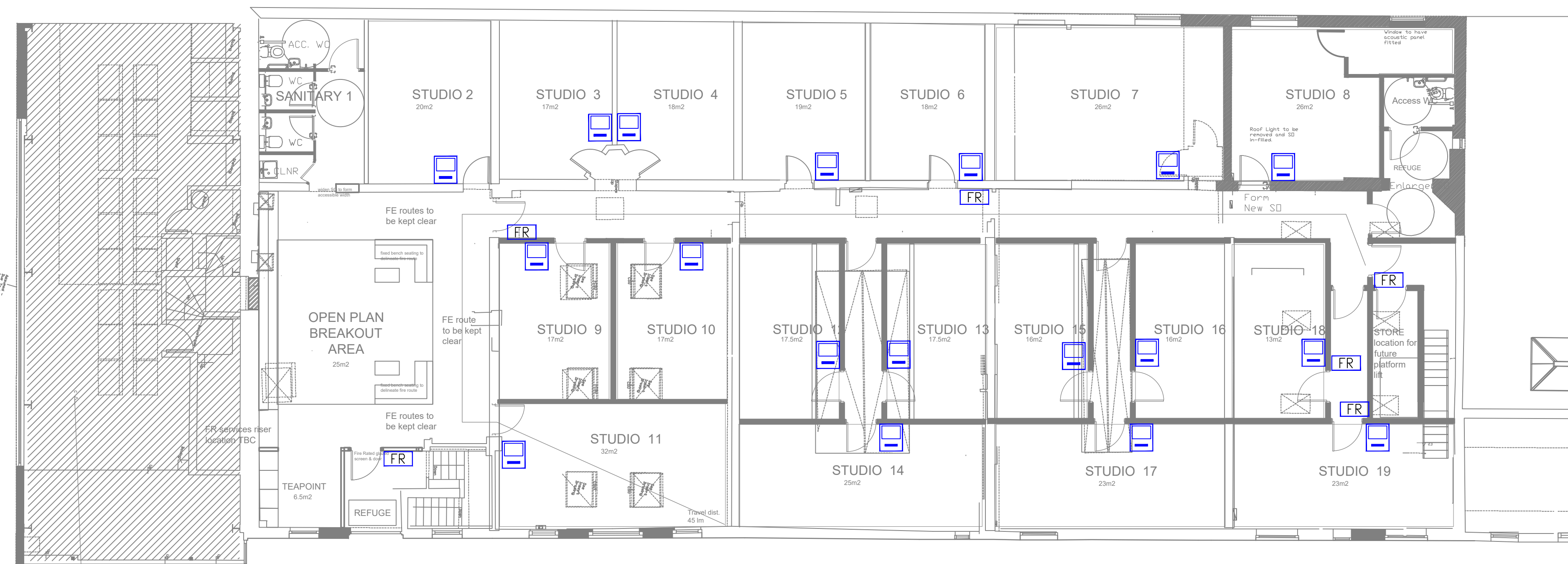

PHOTO OF THE PROPOSED VIDEO INTERCOM UNIT INBUILT FOD READER

Notes:

1. THIS DRAWING IS PRODUCED FOR USE IN THIS PROJECT ONLY AND MAY NOT BE USED FOR ANY OTHER PURPOSE. NPS PROPERTY CONSULTANTS LTD ACCEPT NO LIABILITY FOR THE USE OF THIS DRAWING OTHER THAN THE PURPOSE FOR WHICH IT WAS INTENDED IN CONNECTION WITH THIS PROJECT AS RECORDED IN THE 'PURPOSE FOR ISSUE' AND 'FILE STATUS CODE'.
2. THIS DRAWING MAY NOT BE REPRODUCED IN ANY FORM WITHOUT PRIOR WRITTEN AGREEMENT OF NPS PROPERTY CONSULTANTS LTD.
3. DO NOT SCALE FROM THE DRAWING. USE WRITTEN DIMENSIONS ONLY.
4. DRAWING SHALL BE READ IN CONJUNCTION WITH ALL SPECIFICATIONS / SCOPE OF WORKS / REPORTS.

NOTE: HATCHED AREAS NOT IN SCOPE. ALL UNITS THAT ARE NOT IN SCOPE, THE EXISTING SERVICES ARE TO REMAIN AND UNINTERRUPTED. ANY SERVICES WORKS RELATED TO UNITS OCCUPIED OR UNITS NOT IN SCOPE, TENANT / CLIENT ARE TO BE ADVISED OF WORKS IN ADVANCE IN WRITING.



FIRST FLOOR

LEGEND

- ACP
- FOB READER
- DOOR RELEASE PUSH BUTTON/SWITCH
- EMERGENCY BREAK GLASS UNIT
- DOOR MAGNET HOLDING DEVICE
- OVER DOOR PIR SENSOR
- VIDEO INTERCOM UNIT C/W FOB READER
- VIDEO INTERCOM UNIT RECEIVER TO OPEN THE 2NO. ENTRANCE DOORS REMOTELY

FIRST ISSUE					
P1	DATE	CHECKED	DATE	APPROVED	DATE
REV	DRAWN	DATE	CHECKED	DATE	APPROVED



Evolve Norse
280 Filers Lane, Norwich, NR5 8EQ
Tel: 01603 894100 web: www.norsegroup.co.uk

CLIENT
London Borough of Waltham Forest

PROJECT
Hatherley Mews Refurbishment Project
Walthamstow E17 4QP

TITLE
Proposed Access Control Services

SCALES	DISCIPLINE	PROJECT NUMBER
1:100	ELECTRICAL ENG	116233

DRAWING NUMBER	REV CODE	
EVO-ZZ-00-DR-E-011	P 1	
STATUS CODE	PURPOSE OF ISSUE	DRAWN BY
S0	INFORMATION	IW