

This drawing and the design are the copyright of **ON Architecture Ltd**. This drawing should not be copied or reproduced without written consent.  
 All dimensions are to be checked on site prior to setting out and fabrication and **ON Architecture Ltd** should be notified of any discrepancy prior to proceeding further.  
 For Construction & Fabrication Purposes - Do not scale from this drawing, use only the illustrated dimensions herein. Additional dimensions are to be requested and checked directly.  
 Illustrated information from 3rd party consultants/specialists is shown as indicatively only. See other consultant / specialist drawings for full information and detail.

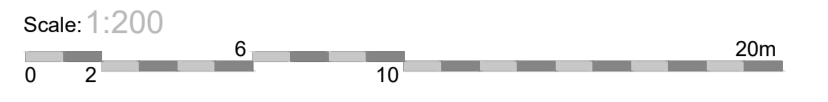

**NOTES**  
 - Landscape shown indicatively, refer to BD Landscapes drawing set for further information

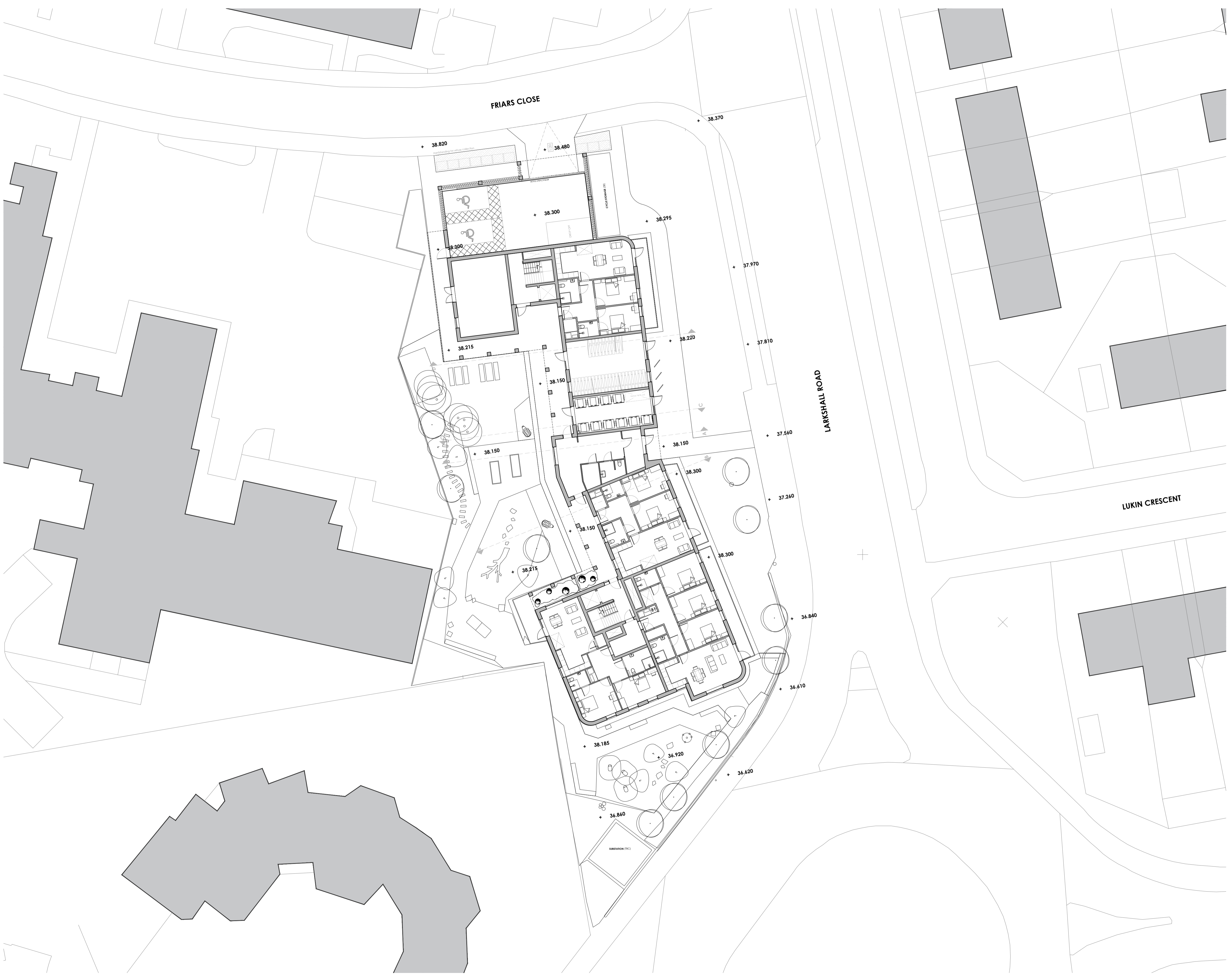

Revision Note & Date		Amended	Checked
Rev	Date	CS	RH
01	02/03/2022		
02	12/04/2022		

**ON ARCHITECTURE**

Canterbury Studio  
 Logan House, St Andrews Close  
 Canterbury, CT1 2RP  
 info@onarchitecture.co.uk  
 onarchitecture.co.uk  
 01227 634334

Project Title  
**HIGHAMS COURT  
 CHINGFORD, LONDON  
 NEWLON HOUSING TRUST**

Drawing Title  
**PROPOSED SITE PLAN**

BM Number  
**20.049-ONA-XX-00-DR-A - 0100**  
 Scale Date Drawn Checked  
 1:200 @ A1 MARCH 2022 CS RH

Drawing Status  
**FOR PLANNING**

Project No.	Drawing No.	Status	Revision
20.049	0100	S0	002

PROPOSED SITE PLAN