

Planting Mix Type 1 - Rain Garden Planting
Area = 41m²

Number	Abbrev.	Species	Size	Specification	Density
24	Ls	Lythrum salicaria	2L	Full Pot: C	9/m ²
22	Ip	Iris pseudacorus	2L	Full Pot: C	9/m ²
22	Or	Osmunda regalis	2L	Full Pot: C	9/m ²
22	So	Sanguisorba officinalis	2L	Full Pot: C	9/m ²
22	Ec	Eupatorium cannabinum	2L	Full Pot: C	9/m ²
22	Paf	Persicaria amplexicaulis 'Firedance'	2L	Full Pot: C	9/m ²
22	Fu	Filipendula ulmaria	2L	Full Pot: C	9/m ²
22	Sfc	Silene flos-cuculi	2L	Full Pot: C	9/m ²
22	Cp	Angelica sylvestris	2L	Full Pot: C	9/m ²

Planting Mix Type 2 - Ornamental Planting Area = 15m²

Number	Abbrev.	Species	Size	Specification	Density
9	VVF	Veronicastrum virginicum 'Fascination'	3L	Full Pot: C	9/m ²
9	MC	Molinia caerulea	3L	Full Pot: C	9/m ²
9	PAA	Persicaria amplexicaulis 'Alba'	3L	Full Pot: C	9/m ²
9	VvD	Veronicastrum virginicum 'Alba'	3L	Full Pot: C	9/m ²
9	HMB	Helenium 'Moonheim beauty'	3L	Full Pot: C	9/m ²
9	HRT	Helenium 'Ruby Tuesday'	3L	Full Pot: C	9/m ²
9	KPOV	Kniphofia poggipole 'Orange Vanilla'	3L	Full Pot: C	9/m ²
9	VB	Verbena bonariensis	3L	Full Pot: C	9/m ²
9	SS	Sisyrinchium striatum	3L	Full Pot: C	9/m ²
9	AM	Anemanthella lessouliana	3L	Full Pot: C	9/m ²
9	NS	Nassella tenuissima	3L	Full Pot: C	9/m ²
9	MCM	Molinia caerulea 'moonhew'	3L	Full Pot: C	9/m ²
9	MSA	Miscanthus sinensis 'Abundance'	3L	Full Pot: C	9/m ²
9	MCA	Molinia caerulea subsp. arundinacea 'transparent'	3L	Full Pot: C	9/m ²
9	CAKF	Calamagrostis acutiflora 'Karl Foerster'	3L	Full Pot: C	9/m ²

Proposed Tree Planting

Number	Abbrev.	Species	Size	Type	Height	Density
1	Bp	Betula pendula	30-35cm girth	Container grown. Single 2m clear stem. RootRain Urban irrigation system & AnchorPlate Arborguy	5-6m	As shown
1	Ag	Alnus glutinosa	18-20cm girth	strapped anchor system by Green Blue Urban	4-5m	As shown
1	Amla	Amelanchier lamarckii	3-3.5m	Container grown. Multi-stem (minimum 3 stems breaking at ground level) Umbrella form trees. RootRain Urban irrigation system & AnchorPlate Arborguy strapped anchor system by Green Blue Urban	3-3.5m	As shown

Specimen Shrubs - At Entrance

Number	Abbrev.	Species	Size	Specification	Density
2	Amla	Amelanchier lamarckii	1.5-2m height	Container grown. Multi-stem (minimum 3 stems breaking at ground level) Umbrella form trees. RootRain Urban irrigation system & AnchorPlate Arborguy strapped anchor system by Green Blue Urban	As shown

- Softworks Maintenance**
General Tasks
- Maintenance visits to be made fortnightly during the growing season and as necessary thereafter.
 - Keep all beds clear of weeds by hand cultivation. Do not use herbicides within planting beds.
 - Keep all beds clear of litter and rubbish.
 - Ensure plants have adequate supply of water.
 - Planters beneath colonnade to be hand watered as per the maintenance schedule
 - Ensure all trees & shrubs are checked for wind damage including staking requirements.

Remove all arisings from site and do not fertilise

Proposed Ornamental Grasses and Perennial Planting
Leave grass standing through winter for the visual interest of the stems and cut all of the foliage from the plant in early spring as grasses start growing early in season therefore if cut in March, there will not be a long period of time without greenery.
This can be done down to 2 to 3 inches above the ground by strimming and raking and collecting the cuttings. Make sure these tools are sharp and try to minimize trafficking.
Cutting this area in spring, allows the remaining stems & leaves to provide winter interest. There is less of an issue of material covering the growing plants in a layer of rotting plant material in these areas as plants specified should not collapse easily.
Remove all arisings from site and do not fertilise.

Large Shrubs
Prune in late winter or early spring. No routine pruning necessary. Remove diseased, damaged, congested or crossing shoots. Shoots that are growing in unwanted directions can also be pruned out.

Tree Planting
Water as required. Re-mulch, fertilize and prune, removing any dead or damaged wood.

Topsail Requirements
Ornamental grasses & perennials require a minimum of 300mm topsail to BS3882:2015.
All topsail to meet the requirements of BS3882:2015. All aspects of the standard must be complied with, including soil handling and storage.

Rosebay House - Blackhorse View

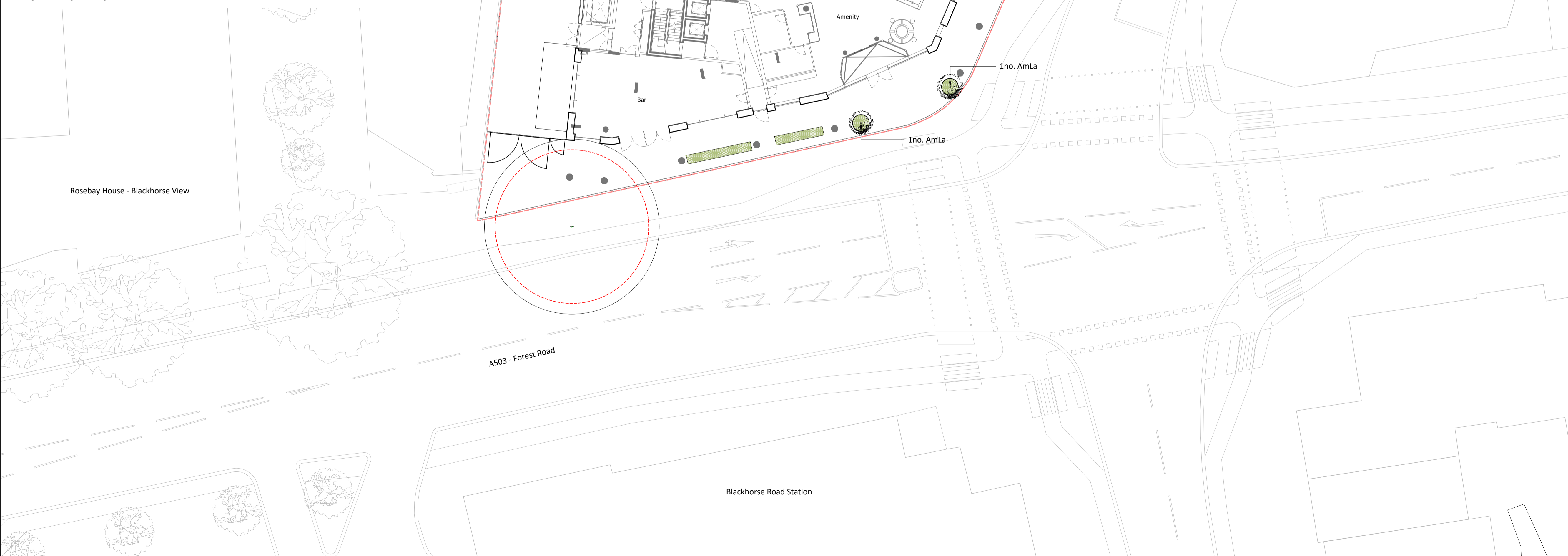

Student Roost - Mannequin House

1no. Ag
1no. Amla

1no. Bp

1no. Amla

1no. Amla

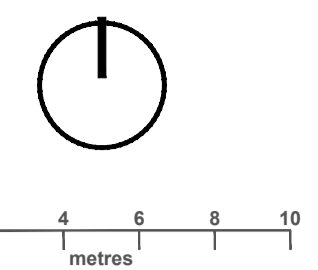

This drawing is not to be scaled. All dimensions to be checked on site. Discrepancies, ambiguities and / or omissions between this drawing and information given elsewhere must be reported immediately to head office for clarification before proceeding.

- GENERAL**
- Site Boundary
- SOFTWORKS**
- Planting Mix Type 1
Rain garden planting
Refer planting plan for specification
 - Planting Mix Type 2
Ornamental planting
Refer planting plan for specification
 - Grass Seeding to grasscrete car parking
100% perennial ryegrass, sown at 50 grams per sq/m.
 - Existing tree for retention
Refer to Arboricultural report
 - Existing tree Root protection area
Refer to Arboricultural report
 - Proposed Tree
Refer to Planting Schedule
 - Extent of SuDs Tree Pit Infrastructure
All proposed trees to have 2.5m² of soil in RootSpace pavement support system by GreenBlue Urban.
 - Proposed Multi-stem specimen shrub/Multi-Stem Tree
Refer to Planting Schedule

Note
Existing Tree to southwest of site to be retained - refer to 0189-LIC-ZZ-00-DR-L-0045 - Paving Strategy & Site Sections & Refer to Arboricultural Impact Assessment (A. T. Coombes Associates Ltd 28 July 2022)

Pre-emptive root pruning undertaken in June 2023. Canopy reduction to be agreed with Local Authority and crown lifting to be undertaken prior to piling / foundations.

Arboricultural method statement is required to establish a pavement support system to protect roots and prevent soil compaction, due to refuse vehicles exiting the site from the proposed service route. Arbor Raft system (or similar) to be installed under pavement around existing tree.

For Planning - Updated Planting Spec	S4	P03	GST	EGA	23/04/24
For Planning	S4	P02	EGA	AGA	26/01/24
Draft Issue - For Comment	S2	P01	EGA	EGA	20/12/23
Revision	POI	Rev	Author	Apvrs	Date

Lichen Studio
Three Storeys, Old Bristol Road, Nailsworth, GL6 0JE
t. 01453 393101
e. hello@lichenstudio.co.uk
w. www.lichenstudio.co.uk

Client: SCAPE (Blackhorse UK Propco Limited)
Project: Blackhorse Lane
Title: Ground Level - Planting Plan
Dwg. No. 0189-LIC-ZZ-00-DR-L-1400 Scale: 1:200 @A1
Revision: P03 Date: December 2023