

Bay Study Key

1. Glazed brick
2. Soldier course stock brick infill panel
3. Metal panel (RAL 3009 or similar)
4. Textured/profiled metal panel (RAL 3009 or similar)
5. Metal mullion (RAL 3009 or similar)
6. Glazing
7. Red stock brick blend
8. Red stock brick
9. White concrete finish
10. Buff stock brick
11. Metal window
12. Textured brick panel
13. Metal balcony (RAL 3009 or similar)
14. Metal Screen (RAL 3009 or similar)
15. Louvre system
16. Metal balustrade

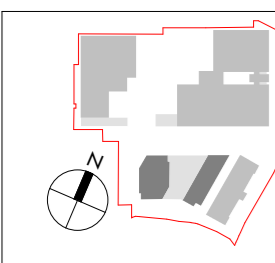
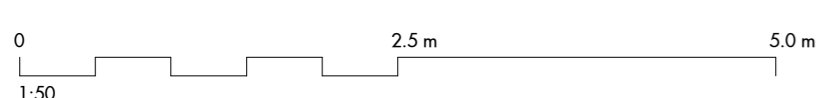

Figured dimensions are in millimetres unless noted otherwise. All dimensions and levels shall be verified on site before proceeding with works. Detailed site survey to be carried out to verify positions and level relationships with site features and ordnance survey. The Architect must be notified of any discrepancy. Boundaries are indicative only and are to be verified by others.

Allies & Morrison LLP is not responsible for any errors caused by the transmission, translation, software or computer systems. Allies & Morrison LLP is not responsible for nor shall be liable for the consequences of any use made of the drawings or models other than that for which they were produced by Allies & Morrison LLP for the Client.

All Intellectual Property Rights reserved

REV	DATE	DESCRIPTION	CD
P1	13/07/22	PLANNING APPLICATION ISSUE	AS
P2	16/06/23	PLANNING APPLICATION ISSUE	DA

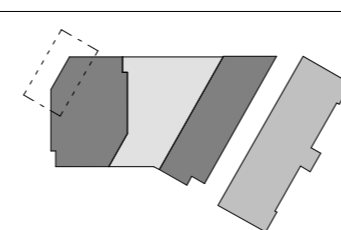

Allies and Morrison LLP

85 Southwark Street
London SE1 0HX
telephone 020 7921 0100
facsimile 020 7921 0101
email studio@alliesandmorrison.com

A&M JOB No: 19029

Uplands Business Park

Bay - B1 Study Axonometric
DETAILED APPLICATION BLOCK B
19029-AAM-B_07_404

SCALE 1: 50 @A1 1: 100 @A3

FOR APPROVAL

P2

Revision