

Blackhorse Lane      Block A2      Goldsmith Yard      Block A1      Eden Girls School

Boundary fence - North elevation



Eden Girls School      Block A1      Goldsmith Street      Romano Group site

Boundary fence - West elevation

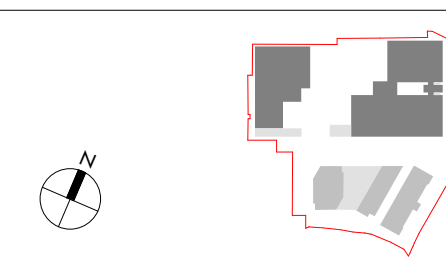
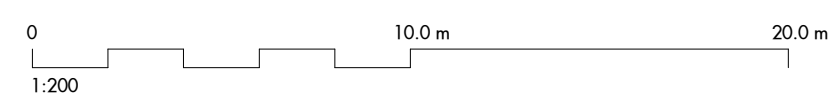

Figured dimensions are in millimetres unless noted otherwise. All dimensions and levels shall be verified on site before proceeding with works. Detailed site survey to be carried out to verify positions and level relationships with site features and ordnance survey. The Architect must be notified of any discrepancy. Boundaries are indicative only and are to be verified by others.  
 Allies & Morrison LLP is not responsible for any errors caused by the transmission, translation, software or computer systems. Allies & Morrison LLP is not responsible for nor shall be liable for the consequences of any use made of the drawings or models other than that for which they were produced by Allies & Morrison LLP for the Client.  
 All Intellectual Property Rights reserved

REV	DATE	DESCRIPTION	CD
P1	13/07/22	PLANNING APPLICATION ISSUE	AS
P2	16/06/23	PLANNING APPLICATION ISSUE	DA

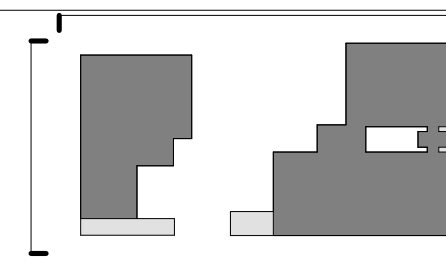

**Allies and Morrison LLP**  
 85 Southwark Street  
 London SE1 0HQ  
 telephone 020 7921 0100  
 facsimile 020 7921 0101  
 email studio@alliesandmorrison.com  
 A&M JOB No: 19029

Uplands Business Park  
 Boundary fence Elevations  
 DETAILED APPLICATION BLOCK A  
 19029-AAM-A\_07\_203  
 SCALE 1 : 200 @A1 1 : 400 @A3

**FOR APPROVAL**

**P2**  
 Revision