



WEST ELEVATION  
1 : 100

MATERIALS KEY:

1. BRONZE COLOUR METAL CLADDING
2. BRONZE COLOUR POWDER COATED WINDOW FRAMES
3. DARK CONTRASTING MULTI BUFF BRICK
4. LIGHT MULTI BUFF BRICK
5. PRIVATE AMENITY GARDEN METAL GATE. COLOUR TBC
6. LOW BRICK WALL WITH POWDER COATED METAL RAILING. COLOUR TO MATCH GATE
7. BRICK PIER WITH COPING
8. BRICK WALL TO SCREEN PRIVATE BINS

9. BRONZE COLOUR POWDER COATED METAL BALCONY WITH RAILING
10. SOLDIER COURSE BRICK BANDING TO GROUND FLOOR
11. BRICK DETAILING
12. BRONZE COLOUR POWDER COATED ACCENT PANEL
13. PRIVATE ENTRANCE DOOR WITH SIDE AND TOP LIGHT
14. COMMUNAL ENTRANCE DOOR WITH VISION PANEL
15. ORIEL WINDOWS. FRAME COLOUR TO MATCH WINDOW FRAMES ELSEWHERE
16. BOLLARD LIGHTING
17. ENTRANCE LIGHTING

18. COMMUNAL ENTRANCE SIGNAGE
19. PRIVATE SIGNAGE
20. METAL GATE TO CAR PARK
21. PEDESTRIAN GATE
22. GABION WALL OR SIMILAR RETAINING STRUCTURE TBC
23. EDGE PROTECTION RAILING
24. COMMUNAL DOOR TO ROOF AMENITY
25. RAIN WATER PIPES AND HOPPER, COLOUR TO MATCH WINDOW FRAMES ELSEWHERE
26. STONE EFFECT COPING

NOTES

This drawing to be read in accordance with the specification/Bill of Quantities and related drawings.  
No Dimensions to be scaled from this drawing. All stated dimensions to be verified on site and the Architect notified of any discrepancies.

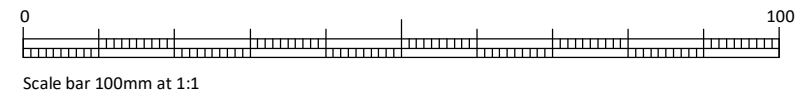

NOTE:

- BASE DRAWING PROVIDED BY OTHERS
- SITE BOUNDARY TO BE CONFIRMED
- ARBORICULTURE CONSTRAINTS AND ROOT PROTECTION AREAS TO BE CONFIRMED
- ALL LEVELS SUBJECT TO SURVEY AND INSPECTION.
- ALL BACK TO BACKS TO BE ASSESSED AGAINST LOCAL AUTHORITY GUIDELINES.
- DISTANCE FROM EXISTING BOUNDARY TO BE ASSESSED AGAINST LOCAL AUTHORITY GUIDELINES.

KEY PLAN:

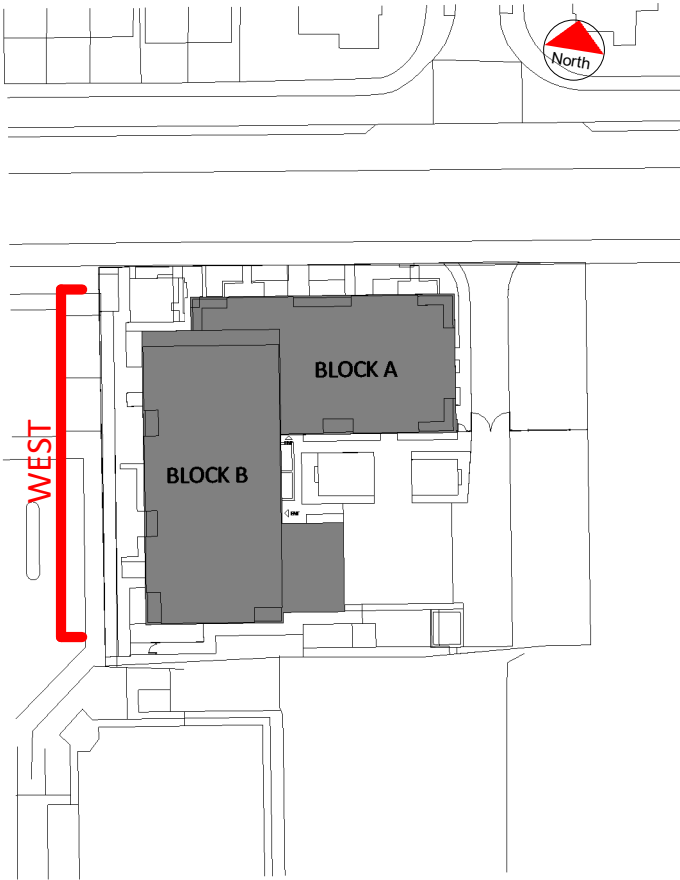

LANDSCAPING SHOWN INDICATIVELY.  
REFER TO LANDSCAPE ARCHITECTS  
DETAILS.

A	31/03/23 UPDATED TO REFLECT REVISED BUILDING DESIGN & POSITION			AC
	Rev	Date	Note	

PLANNING ISSUE

Project

PROPOSED RESIDENTIAL  
DEVELOPMENT  
NEW ROAD CHINGFORD

Title

PROPOSED WEST ELEVATION

Scale 1:100 @A1 Date 12/21/21

Drawn SD Checked DF

Drawing Number  
8126\_P803

Revision  
A

**Saunders**  
Architecture + Urban Design