



Notes

Key

 Boundary line

 Land also under applicant's control

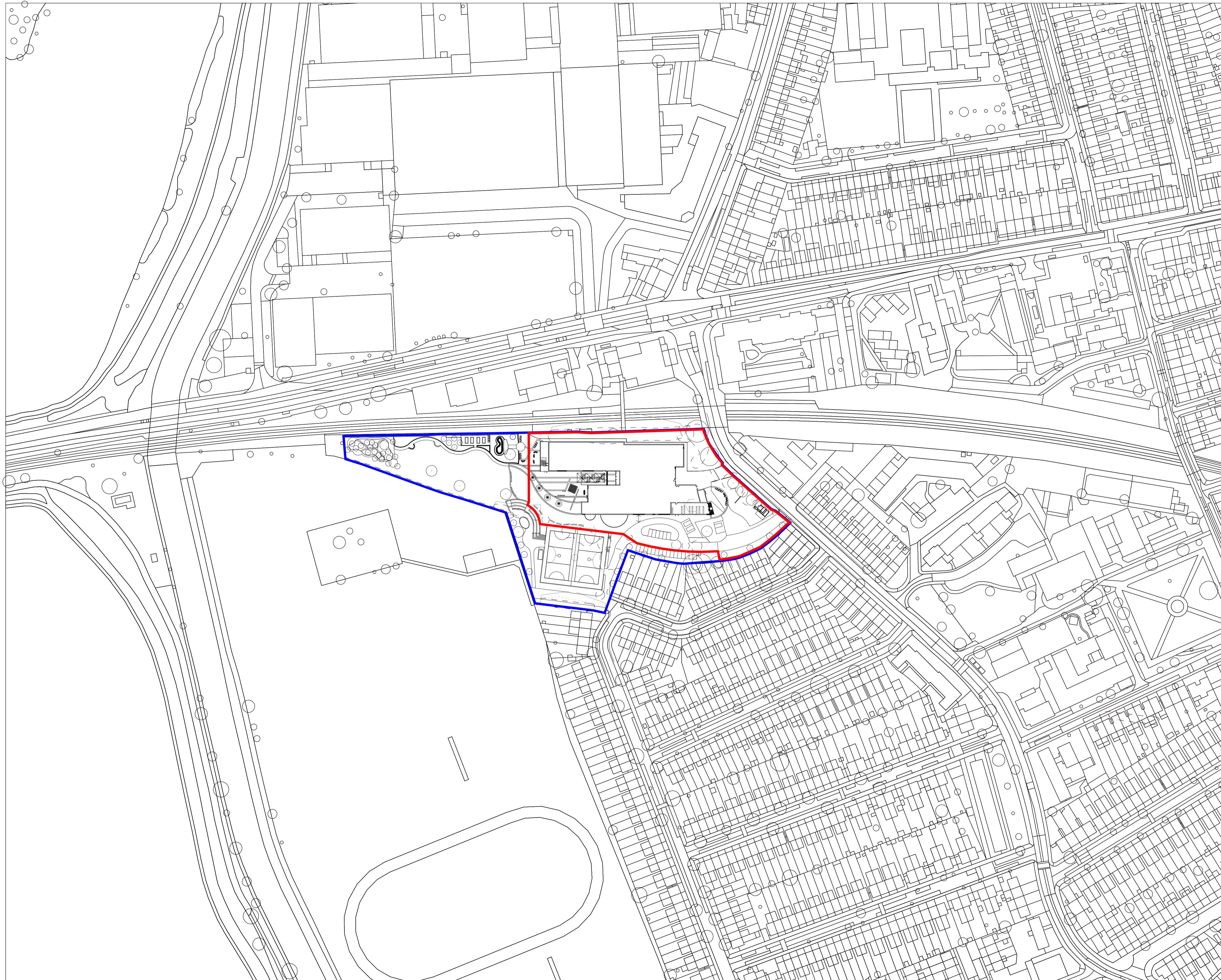
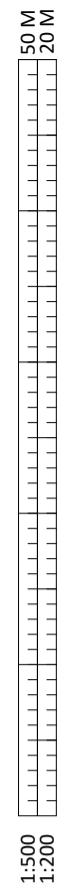

P02	ISSUE FOR PLANNING	200821	GS	CB
Rev	Change Name	Date	By	Chk
Revisions				Suitability
Project	S2 INFORMATION			

WILLOWFIELD SCHOOL

Client



Title

EXISTING LOCATION PLAN

Drawing No.	Revision
WIL-HLM-ZZ-00-DR-A-00001	P02

Scale @ A1	Drawn
1:1250	CB
Date	Checked
26/04/2021	CW



© HLM Architects
 Wool + Tailor Building
 Fifth Floor
 10-12, Alie Street
 London E1 8DE

www.hlmarchitects.com
 T. +44 (0) 20 7921 4800
 F. +44 (0) 20 7921 4850
 london@hlmarchitects.com

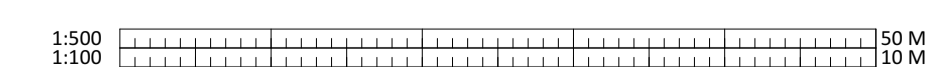

N

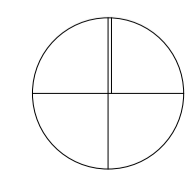

© HLM Architects. The Qualification Group 2010 License No. LAY004.001000010110