

This drawing is copyright and owned by Dan Worden Architecture and may not be reproduced or used unless accepted in writing.

This drawing is prepared solely for design and planning submission purposes. It is not intended or suitable for other Building Regulations or Construction purposes and should not be used for such. Contractors must check all dimensions from site.

All other design discipline elements other than specified architectural elements, have been imported from the relevant consultants' drawings and reference should be made to the individual consultant's drawings for their specific elements of work.

Discrepancies and / or ambiguities within this drawing, between it and information given elsewhere, must be reported immediately to Dan Worden Architecture for clarification before proceeding.

All works are to be carried out in accordance with the latest CDM Safety Standard, Building Regulations, British Standards and relevant Codes of Practice unless specifically directed otherwise.

Responsibility for the reproduction of this drawing in paper form, or if saved in electronic format, lies with the recipient to check that all information has been replicated in full and is correct when compared to the original paper or electronic image. Graphical representations of equipment on this drawing have been coordinated, but are approximate only. Please refer to the Specifications and / or Details for actual sizes and / or specific contractor construction information.

This original document is issued for the purpose indicated below and contains information of confidential nature. Further copies and circulation will be strictly in accordance with the confidentiality agreement under the contract. This original must be destroyed or returned to the contractor.

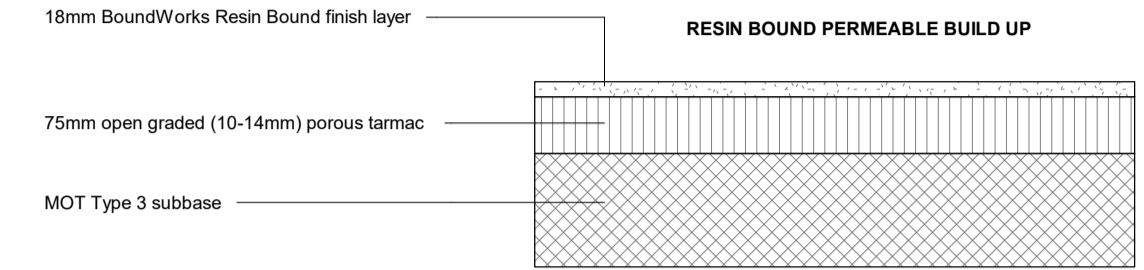
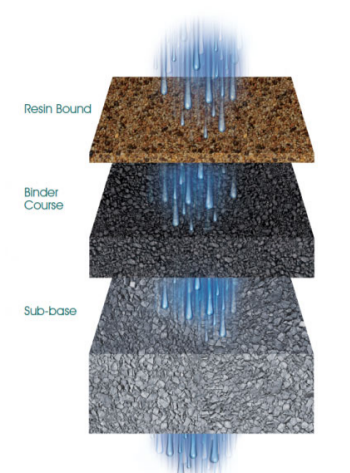

External Materials Legend

- 1** BoundWorks Resin Bound System
Finish: 6mm Amazon
Approximate Area: 200m²
- 2** Uhlmann 4 x 3m outdoor umbrella with fixed post and motorised opening / close canopy
Finish: Black canopy
- Marshalls Fairstone Sawn Granite Eclipse Setts
Finish: Light
- Marshalls Drexus 100 Drainage Channel with cast iron grate



1 Proposed Rear Elevation
1 : 50

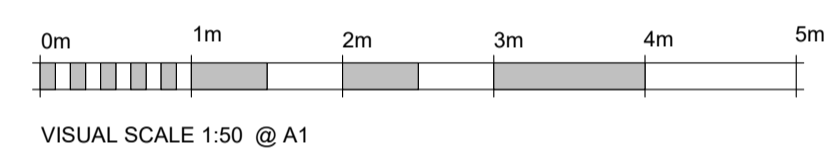

New resin bound surface to fall away from the building to a minimum fall of 1:80.

The new resin bound surface should not extend above the existing surface level, this is especially important at the abutment with the existing building. Provide a strip of DPM between the new resin bound system build up and the existing walls / timber sleepers.

Outdoor umbrella to be installed in accordance within manufacturers instructions and Structural Engineers design.

The existing timber sleepers to the raised plant beds may require additional / temporary support when excavating the ground in close proximity.

Contractor to provide aluminium edging strips to perimeter of the resin bound system. Granite setts to be bedded on a suitable ST1 concrete base.

Contractor to provide method statements and health and safety information to the client in line with HSE regulations. Phasing and accessibility to be considered in relation to public and staff access to the building during the construction works.

Work should not commence until the relevant statutory approvals are in place, including Planning Approval, Listed Building consent and Building Regulations Approval.

Existing below ground service cables and drainage to be assessed/surveyed by the contractor prior to construction. Drainage channels to connect to existing below ground surface water drainage system.

ALL DIMENSIONS AND AREAS TO BE CHECKED ON SITE BY CONTRACTOR PRIOR TO CONSTRUCTION

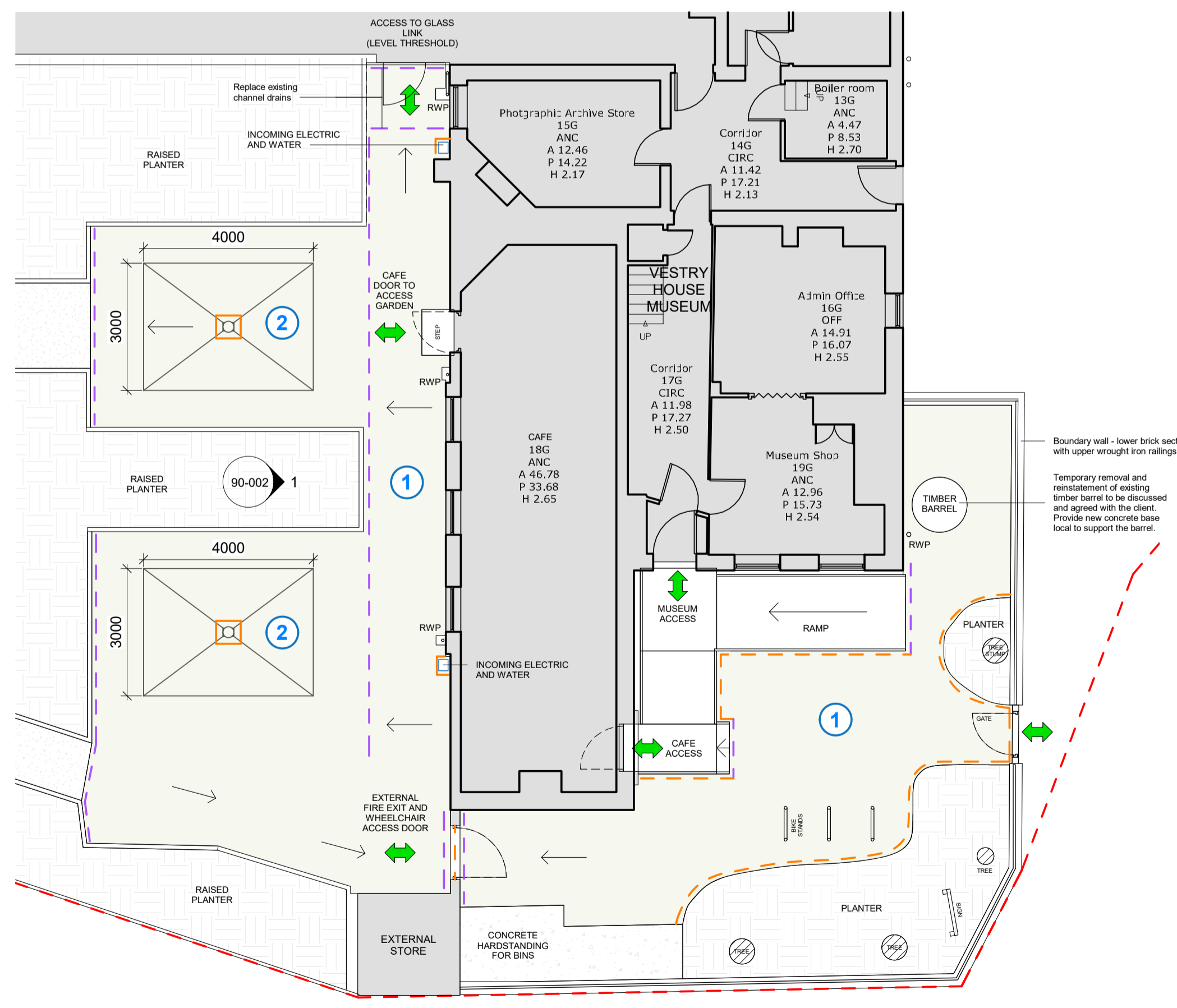

2 Proposed External Plan
1 : 100

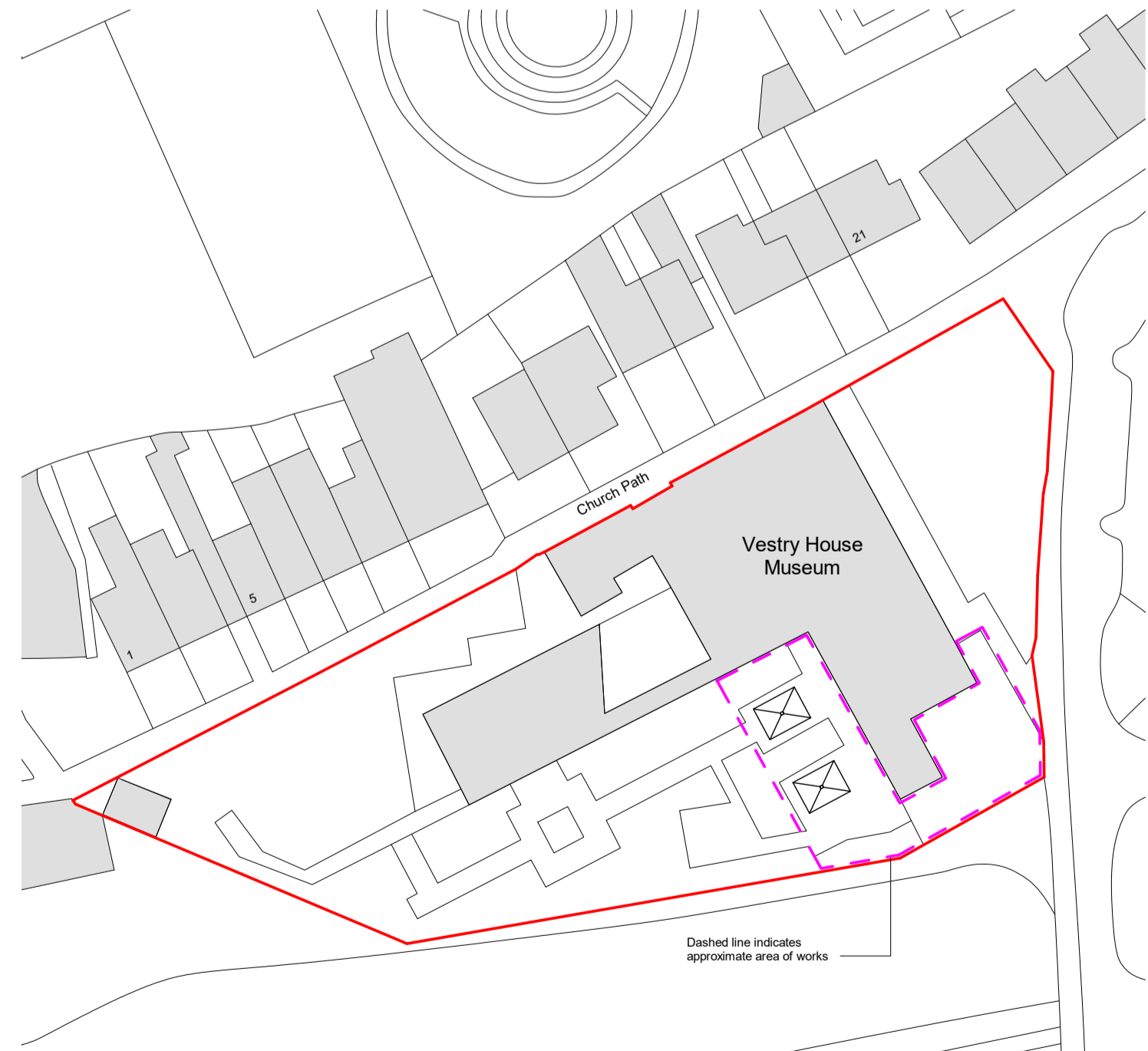
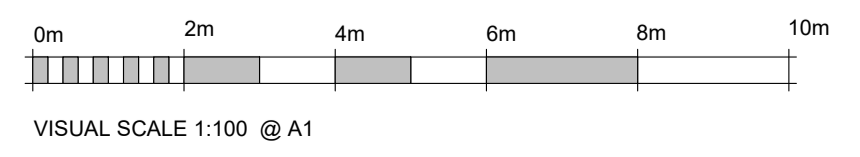

3 Proposed Site Plan
1 : 500

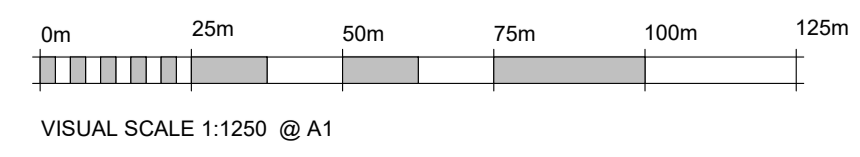

PO1	Updated following comments from Planners	18/01/22	DW
Rev	Description	Date	Drawn
Revision Schedule			
client			

Waltham Forest Council

project:
Vestry House Museum - Hard Landscaping and Parasols

title:
Proposed Plan and Elevations

project no:	scale:	date:
VHM-21	As Indicated @A1	18/01/22
drawing no:	Status:	Rev:
VHM-DWA-XX-XX-DR-A-90-002	S0	P01