

NOTES
 This drawing is not to be scaled for anything other than planning purposes only. It is not to be used for building regulations or construction purposes. All dimensions are to be confirmed on site. Architect to be informed of any discrepancies before any action is taken. This drawing is copyright © Smith & Newton Architects Ltd.

REV DATE	ISSUED BY - CK
00	06.07.21 KP CS Initial Issue
01	14.09.21 KP DN Revised Issue

NOTES
 Drawing Scales (for planning use only)

0 25m 50m
1:1250

0 5m
1:200

- Application Site Boundary
- Building/s
- Existing Building



SITE LOCATION PLAN
 Scale: 1:1250 @ A3

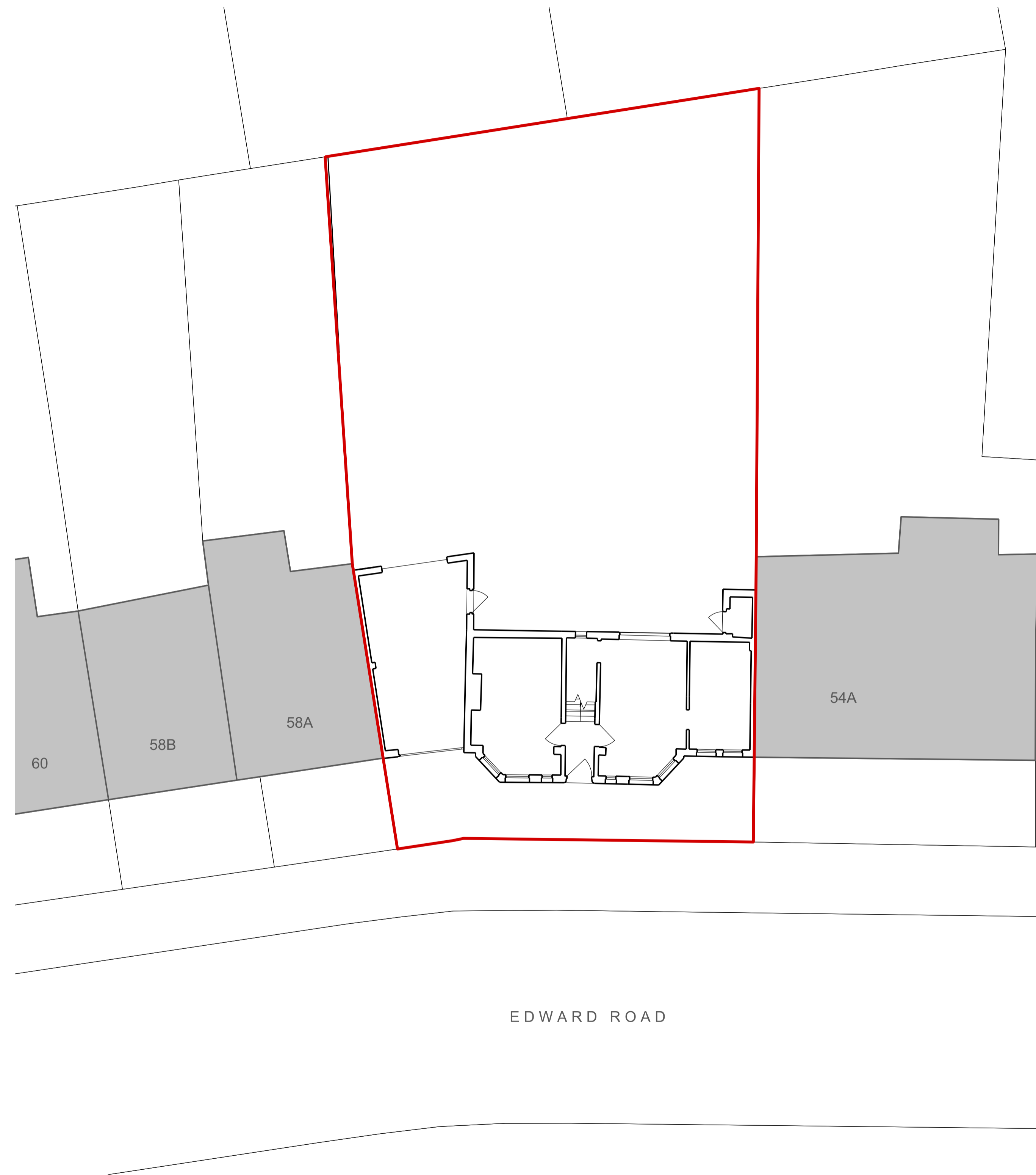

BLOCK PLAN
 Scale: 1:200 @ A3

SMITH & NEWTON ARCHITECTS

A Studio 26, Hatherley Mews, Walthamstow, London, E17 4QP
 T +44 (0)20 8520 3867
 E info@smith-newton.com

Project EDWARD ROAD	Site Address 56 Edward Road, Walthamstow, E17 6LU
Drawing Title Site Location & Existing Block Plan	
Status Preliminary	Scale(s) at A3 As Shown
DRAWING 0439-02-0050	REVISION 01

NOTES
 This drawing is not to be scaled for anything other than planning purposes only. It is not to be used for building regulations or construction purposes. All dimensions are to be confirmed on site. Architect to be informed of any discrepancies before any action is taken. This drawing is copyright © Smith & Newton Architects Ltd.

REV DATE	ISSUED BY - CK	ISSUED
00	15.10.19 KP CS	Initial Issue
01	31.10.19 DN CS	Updated Issue
02	20.04.20 KP CS	Updated Issue
03	23.07.21 KP CS	Updated Issue
04	14.09.21 KP DN	Revised Issue

NOTES
 Drawing Scales (for planning use only)

0 25m 50m
 1:1250

0 5m
 1:200

 Application Site Boundary

 Building/s



SITE LOCATION PLAN
 Scale: 1:1250 @ A3

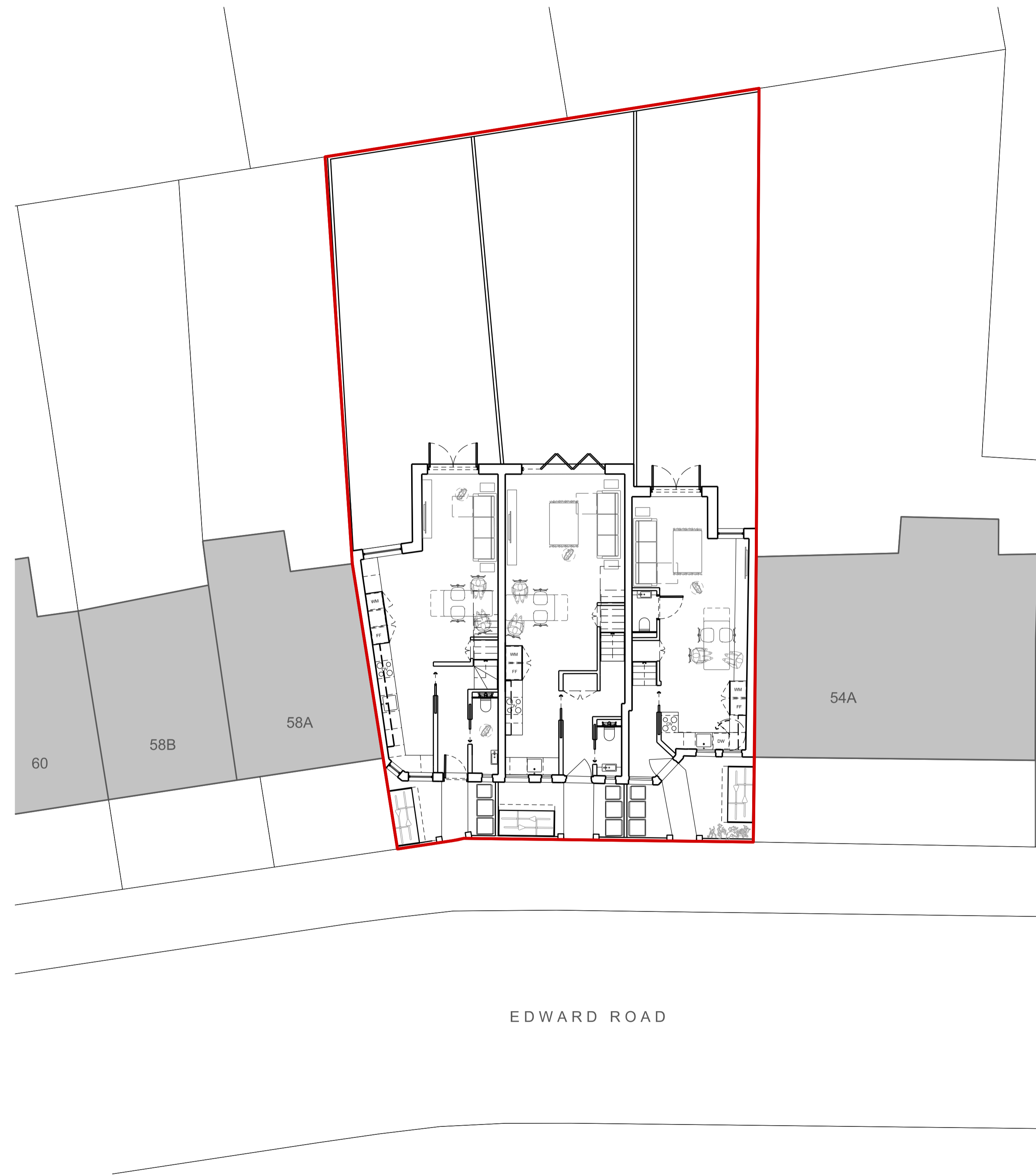

PROPOSED BLOCK PLAN
 Scale: 1:200 @ A3

SMITH & NEWTON ARCHITECTS



A Studio 26, Hatherley Mews, Walthamstow, London, E17 4QP
 T +44 (0)20 8520 3867
 E info@smith-newton.com

Project EDWARD ROAD	Site Address 56 Edward Road, Walthamstow, E17 6LU
Drawing Title Site Location & Proposed Block Plan	
Status Planning	Scale(s) at A3 As Shown
DRAWING 0439-02-0100	REVISION 04

NOTES
 This drawing is not to be scaled for anything other than planning purposes only. It is not to be used for building regulations or construction purposes. All dimensions are to be confirmed on site. Architect to be informed of any discrepancies before any action is taken. This drawing is copyright © Smith & Newton Architects Ltd.

REV DATE	ISSUED BY - CK	DESCRIPTION
00	04.10.19 CS DN	Initial Issue
01	20.04.20 KP DN	Updated Issue
02	16.04.21 KP CS	Pre-Application Revision
03	14.09.21 KP DN	Revised Issue

NOTES
 Drawing Scales (for planning use only)

-  Site Boundary
-  Surrounding Buildings
-  Existing House 3 Bedroom 100sqM GIA over two floors





SMITH & NEWTON ARCHITECTS
 A Studio 26, Hatherley Mews, Walthamstow, London, E17 4QP
 T +44 (0)20 8520 3867
 E info@smith-newton.com

Project	Edward Road	Site Address	56 Edward Road, Walthamstow, E17 6LU
Drawing Title	Ground Floor Plan Existing		
Status	Preliminary	Scale(s) at A3	1:100
Drawing Reference	0439-02-0200	Revision	03

NOTES
 This drawing is not to be scaled for anything other than planning purposes only. It is not to be used for building regulations or construction purposes. All dimensions are to be confirmed on site. Architect to be informed of any discrepancies before any action is taken. This drawing is copyright © Smith & Newton Architects Ltd.

REV DATE	ISSUED BY - CK	DESCRIPTION
00	04.10.19 CS DN	Initial Issue
01	20.04.20 KP DN	Updated Issue
02	16.04.21 KP CS	Pre-Application Revision
03	14.09.21 KP DN	Revised Issue

NOTES
 Drawing Scales (for planning use only)

-  Site Boundary
-  Surrounding Buildings
-  Existing House 3 Bedroom 100sqM GIA over two floors

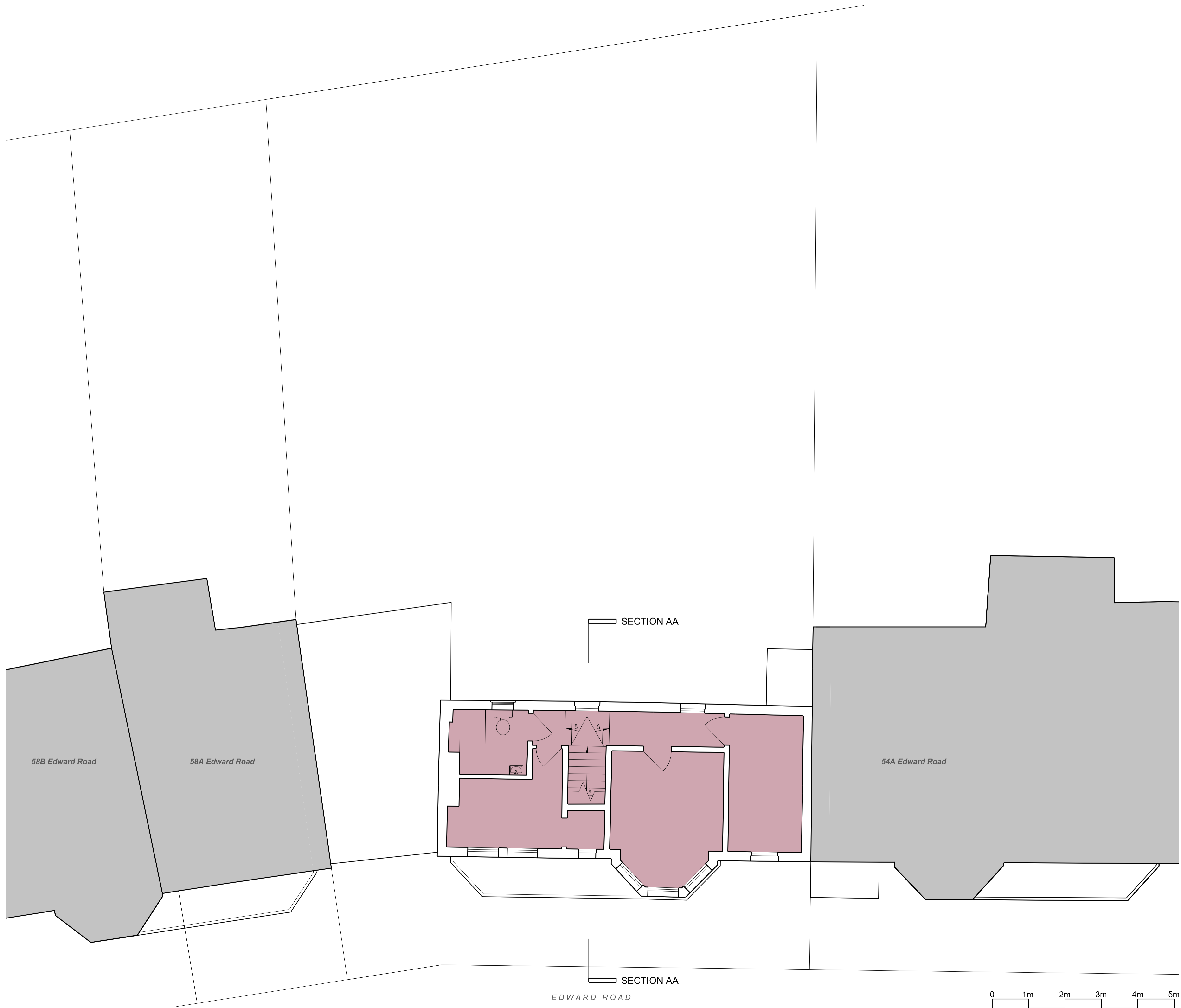

SMITH & NEWTON ARCHITECTS

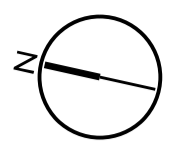

A Studio 26, Hatherley Mews, Walthamstow, London, E17 4QP
 T +44 (0)20 8520 3867
 E info@smith-newton.com

Project Edward Road	Site Address 56 Edward Road, Walthamstow, E17 6LU
Drawing Title First Floor Plan Existing	
Status Preliminary	Scale(s) at A3 1:100
Drawing Reference 0439-02-0201	Revision 03



NOTES
 This drawing is not to be scaled for anything other than planning purposes only. It is not to be used for building regulations or construction purposes. All dimensions are to be confirmed on site. Architect to be informed of any discrepancies before any action is taken. This drawing is copyright © Smith & Newton Architects Ltd.

REV	DATE	BY	ISSUED
00	20.04.20	KP CS	Initial Issue
01	16.04.21	KP CS	Pre-Application Revision
02	14.09.21	KP DN	Revised Issue

- NOTES**
 Drawing Scales (for planning use only)
-  Site Boundary
 -  Surrounding Buildings
 -  Existing House 3 Bedroom 100sqM GIA over two floors









SMITH & NEWTON ARCHITECTS
 A Studio 26, Hatherley Mews, Walthamstow, London, E17 4QP
 T +44 (0)20 8520 3867
 E info@smith-newton.com

Project	Edward Road	Site Address	56 Edward Road, Walthamstow, E17 6LU
Drawing Title	Roof Plan Existing	Status	Preliminary
Scale(s) at A3	1:100	Drawing Reference	0439-02-0202
Revision	02		

NOTES
 This drawing is not to be scaled for anything other than planning purposes only. It is not to be used for building regulations or construction purposes. All dimensions are to be confirmed on site. Architect to be informed of any discrepancies before any action is taken. This drawing is copyright © Smith & Newton Architects Ltd.

REV DATE	ISSUED BY - CK	DESCRIPTION
00	15.10.19 KP CS	Initial Issue
01	31.10.19 KP CS	Updated Issue
02	08.11.19 AM DN	Updated Issue
03	12.11.19 AM DN	Updated Issue
04	20.04.20 KP CS	Updated Issue
05	16.04.21 KP DN	Pre-Application Revision
06	05.05.21 KP DN	Pre-Application Revision
07	23.07.21 KP DN	Planning Application

NOTES
 Drawing Scales (for planning use only)

-  Site Boundary
-  Surrounding Buildings
-  House 1 (2 bed / 3 person) 73 sq M GIA
-  House 2 (3 bed / 4 person) 87 sq M GIA
-  House 3 (2 bed / 3 person) 70 sq M GIA
-  Amenity Space
-  Circulation
-  Bicycle Storage
-  Refuse & Recycling Store (240 litre Refuse, 240 litre recycling, 140 litre organic waste)

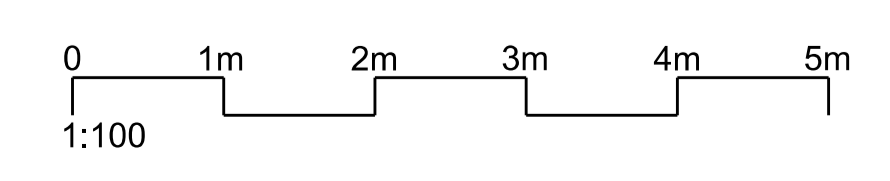







SMITH & NEWTON ARCHITECTS

A Studio 26, Hatherley Mews, Walthamstow, London, E17 4QP
 T +44 (0)20 8520 3867
 E info@smith-newton.com

Project	Edward Road	Site Address	56 Edward Road, Walthamstow, E17 6LU
Drawing Title	Ground Floor Plan Proposed		
Status	Planning	Scale(s) at A3	1:100
Drawing Reference	0439-02-0260	Revision	07

NOTES
 This drawing is not to be scaled for anything other than planning purposes only. It is not to be used for building regulations or construction purposes. All dimensions are to be confirmed on site. Architect to be informed of any discrepancies before any action is taken. This drawing is copyright © Smith & Newton Architects Ltd.

REV DATE	ISSUED BY - CK	DESCRIPTION
00	15.10.19 KP CS	Initial Issue
01	31.10.19 KP CS	Updated Issue
02	08.11.19 AM DN	Updated Issue
03	20.04.20 KP CS	Updated Issue
04	16.04.21 KP DN	Pre-Application Revision
05	05.05.21 KP DN	Pre-Application Revision
06	23.07.21 KP DN	Planning Application
07	14.09.21 KP DN	Revised Drawing

- NOTES**
 Drawing Scales (for planning use only)
-  Site Boundary
 -  Surrounding Buildings
 -  House 1 (2 bed / 3 person) 73 sq M GIA
 -  House 2 (3 bed / 4 person) 87 sq M GIA
 -  House 3 (2 bed / 3 person) 70 sq M GIA
 -  Amenity Space



SMITH & NEWTON ARCHITECTS

A Studio 26, Hatherley Mews, Walthamstow, London, E17 4QP
 T +44 (0)20 8520 3867
 E info@smith-newton.com

Project Edward Road	Site Address 56 Edward Road, Walthamstow, E17 6LU
Drawing Title First Floor Plan Proposed	
Status Planning	Scale(s) at A3 1:100
Drawing Reference 0439-02-0261	Revision 07

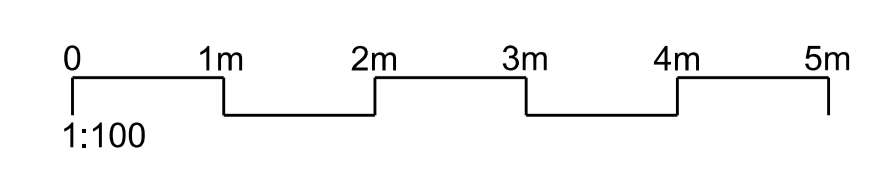

NOTES
 This drawing is not to be scaled for anything other than planning purposes only. It is not to be used for building regulations or construction purposes. All dimensions are to be confirmed on site. Architect to be informed of any discrepancies before any action is taken. This drawing is copyright © Smith & Newton Architects Ltd.

REV DATE	ISSUED BY - CK	Initial Issue
00	17.04.20 KP CS	Initial Issue
01	16.04.21 KP DN	Pre-Application Revision
02	23.07.21 KP DN	Planning Application
03	14.09.21 KP DN	Revised Issue

NOTES
 Drawing Scales (for planning use only)

 Site Boundary

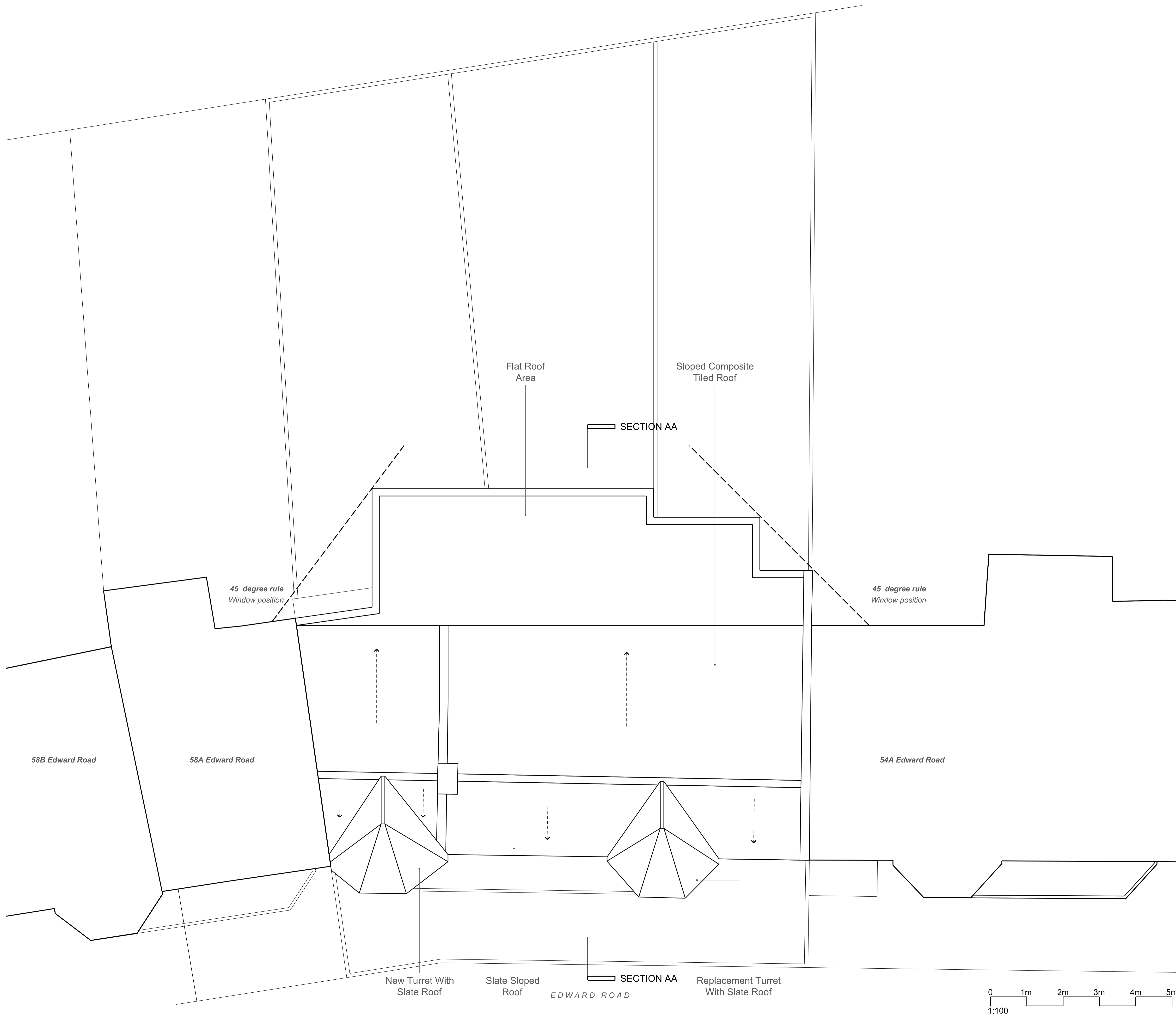

SMITH & NEWTON ARCHITECTS

A Studio 26, Hatherley Mews, Walthamstow, London, E17 4QP
 T +44 (0)20 8520 3867
 E info@smith-newton.com

Project Edward Road	Site Address 58 Edward Road, Walthamstow, E17 6PB
Drawing Title Roof Plan Proposed	
Status Planning	Scale(s) at A3 1:100
Drawing Reference 0439-02-0262	Revision 03

NOTES
 This drawing is not to be scaled for anything other than planning purposes only. It is not to be used for building regulations or construction purposes. All dimensions are to be confirmed on site. Architect to be informed of any discrepancies before any action is taken. This drawing is copyright © Smith & Newton Architects Ltd.

REV DATE	ISSUED BY - CK	DESCRIPTION
01	20.04.20 KP CS	Updated Issue
02	23.07.21 KP CS	Revised Issue
03	14.09.21 KP DN	Revised Issue
04	15.02.22 KP DN	Updated Planning Issue

- NOTES**
 Drawing Scales (for planning use only)
- Existing House 3 Bedroom 100sqM GIA over two floors
 - House 1 (2 bed / 3 person) 71sqM GIA
 - House 2 (3 bed / 4 person) 84sqM GIA
 - House 3 (2 bed / 3 person) 70sqM GIA
 - Amenity Space
 - Circulation
 - Bicycle Storage
 - Refuse & Recycling Store

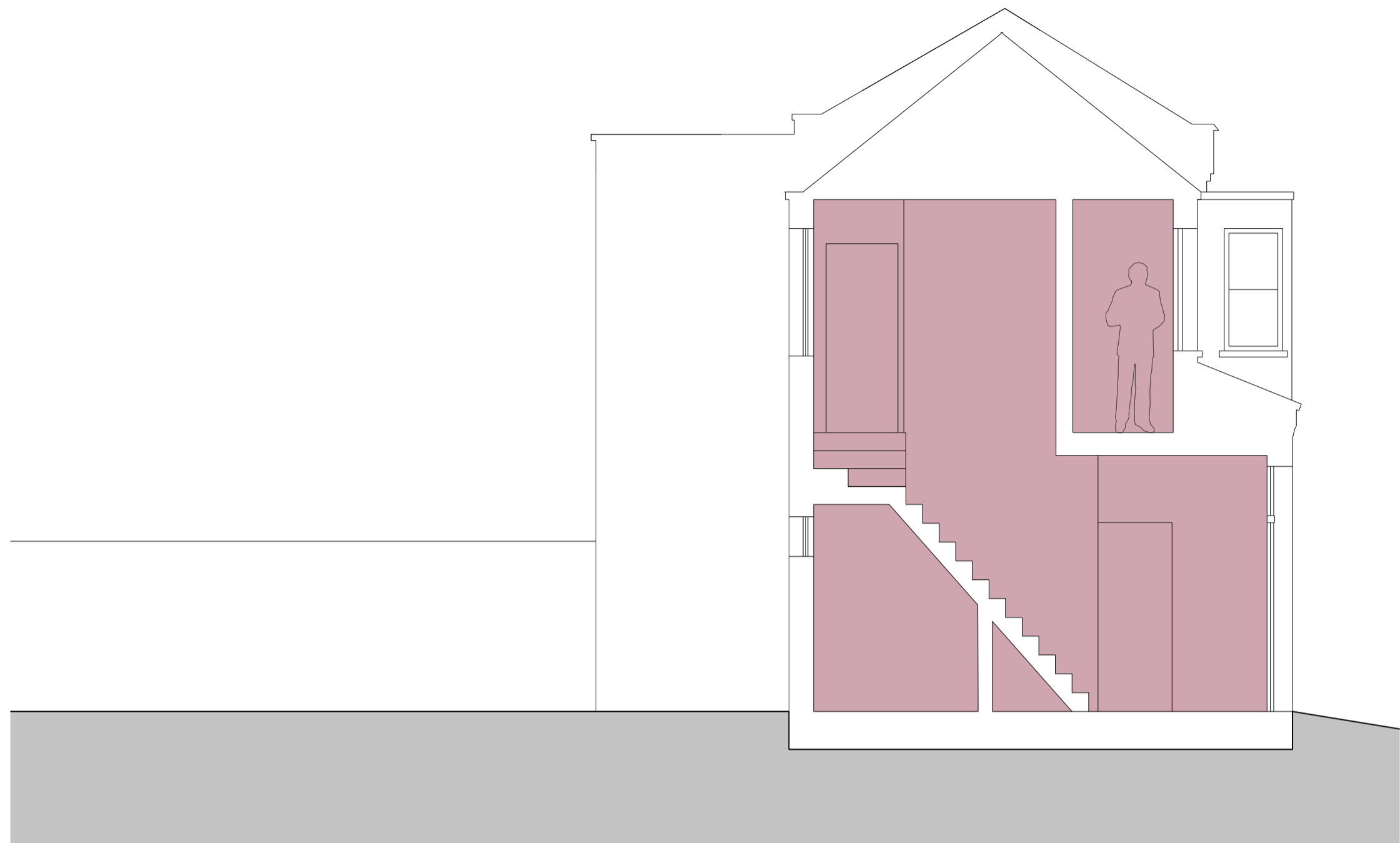

SECTION AA
Existing

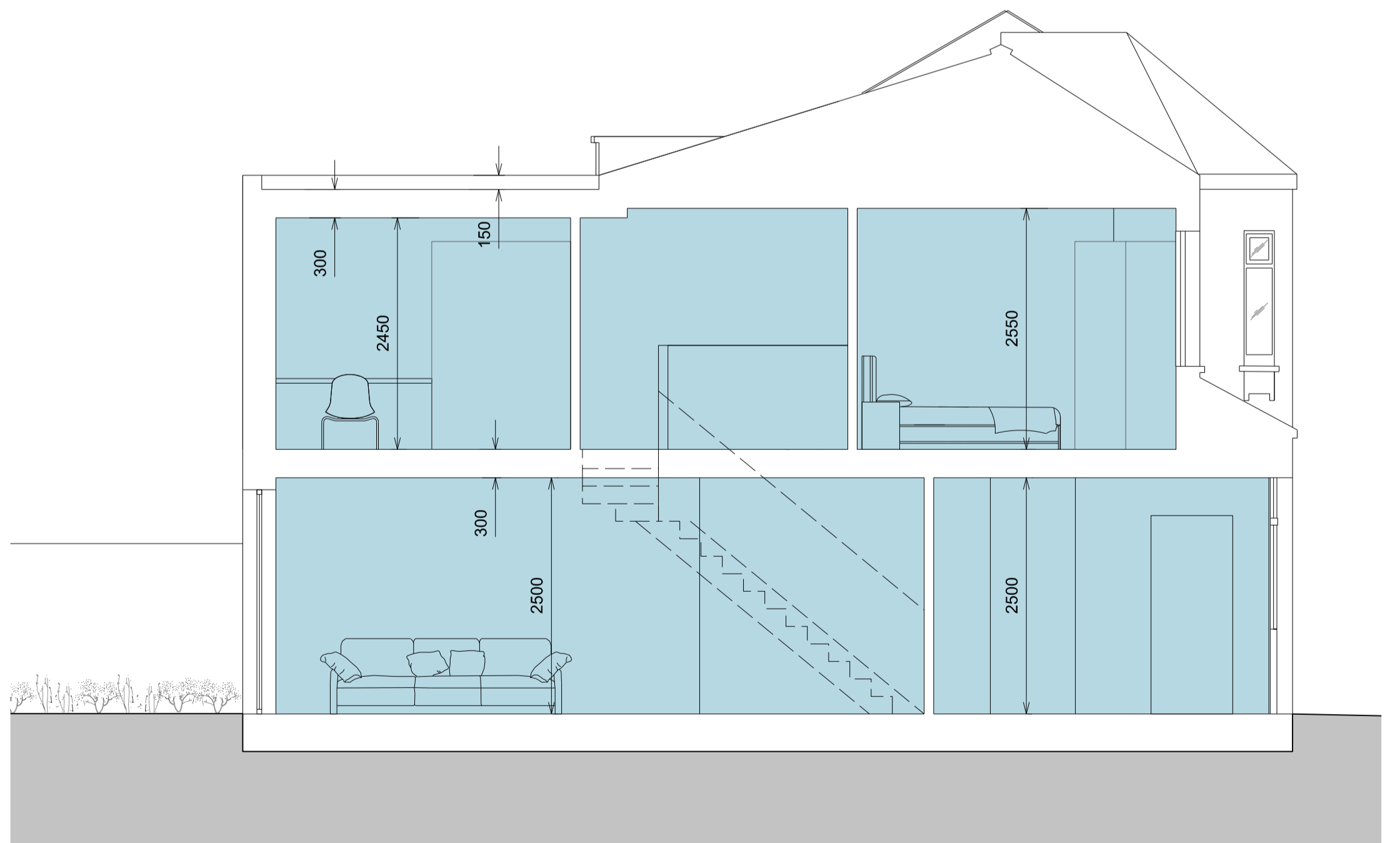

SECTION AA
Proposed

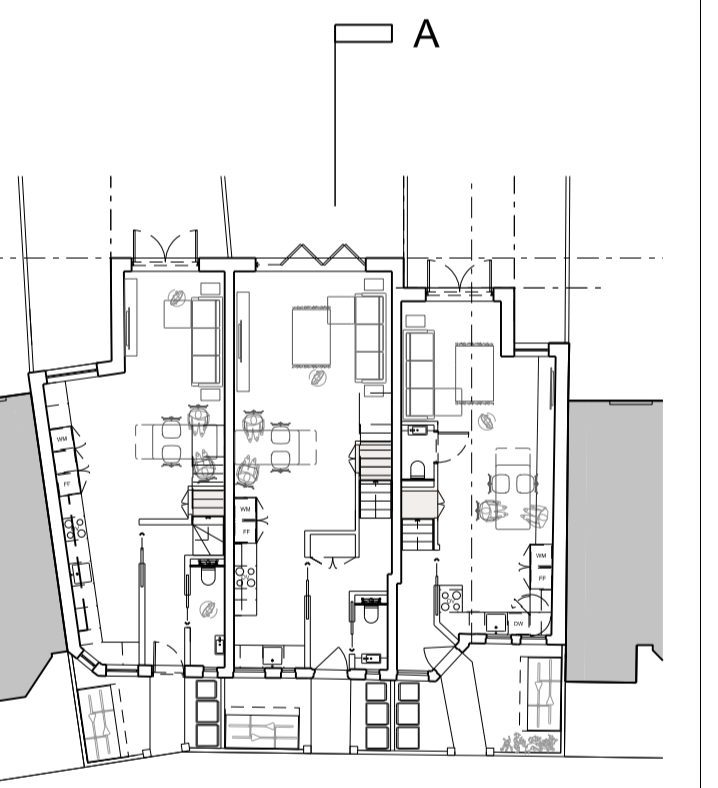

PROPOSED PLAN

SMITH & NEWTON ARCHITECTS
 A Studio 26, Hatherley Mews, Walthamstow, London, E17 4QP
 T +44 (0)20 8520 3867
 E info@smith-newton.com

Project Edward Road	Site Address 56 Edward Road, Walthamstow, E17 6LU
Drawing Title Section AA Existing & Proposed	
Status Planning	Scale(s) at A3 1:100
Drawing Reference 0439-02-0450	Revision 04

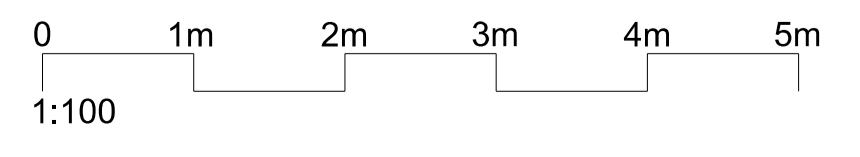

NOTES
 This drawing is not to be scaled for anything other than planning purposes only. It is not to be used for building regulations or construction purposes. All dimensions are to be confirmed on site. Architect to be informed of any discrepancies before any action is taken. This drawing is copyright © Smith & Newton Architects Ltd.

REV	DATE	BY	CK	ISSUED
00	15.10.19	KP	CS	Initial Issue
01	28.10.19	KP	CS	Updated Issue
02	08.11.19	AM	DN	Updated Issue
03	20.04.20	KP	CS	Updated Issue
04	16.04.21	KP	CS	Pre-Application Revision

NOTES
 Drawing Scales (for planning use only)



FRONT ELEVATION
 Existing



REAR ELEVATION
 Existing

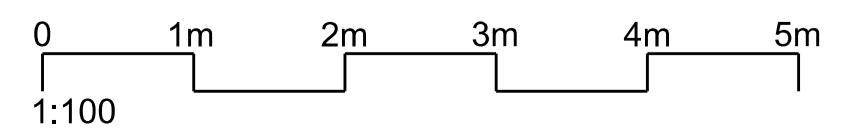

SMITH & NEWTON ARCHITECTS
 A Studio 26, Hatherley Mews, Walthamstow, London, E17 4QP
 T +44 (0)20 8520 3867
 E info@smith-newton.com

Project	Edward Road	Site Address	56 Edward Road, Walthamstow, E17 6LU
Drawing Title	Front & Rear Elevation Existing		
Status	Preliminary	Scale(s) at A3	1:100
Drawing Reference	0439-02-0500	Revision	04

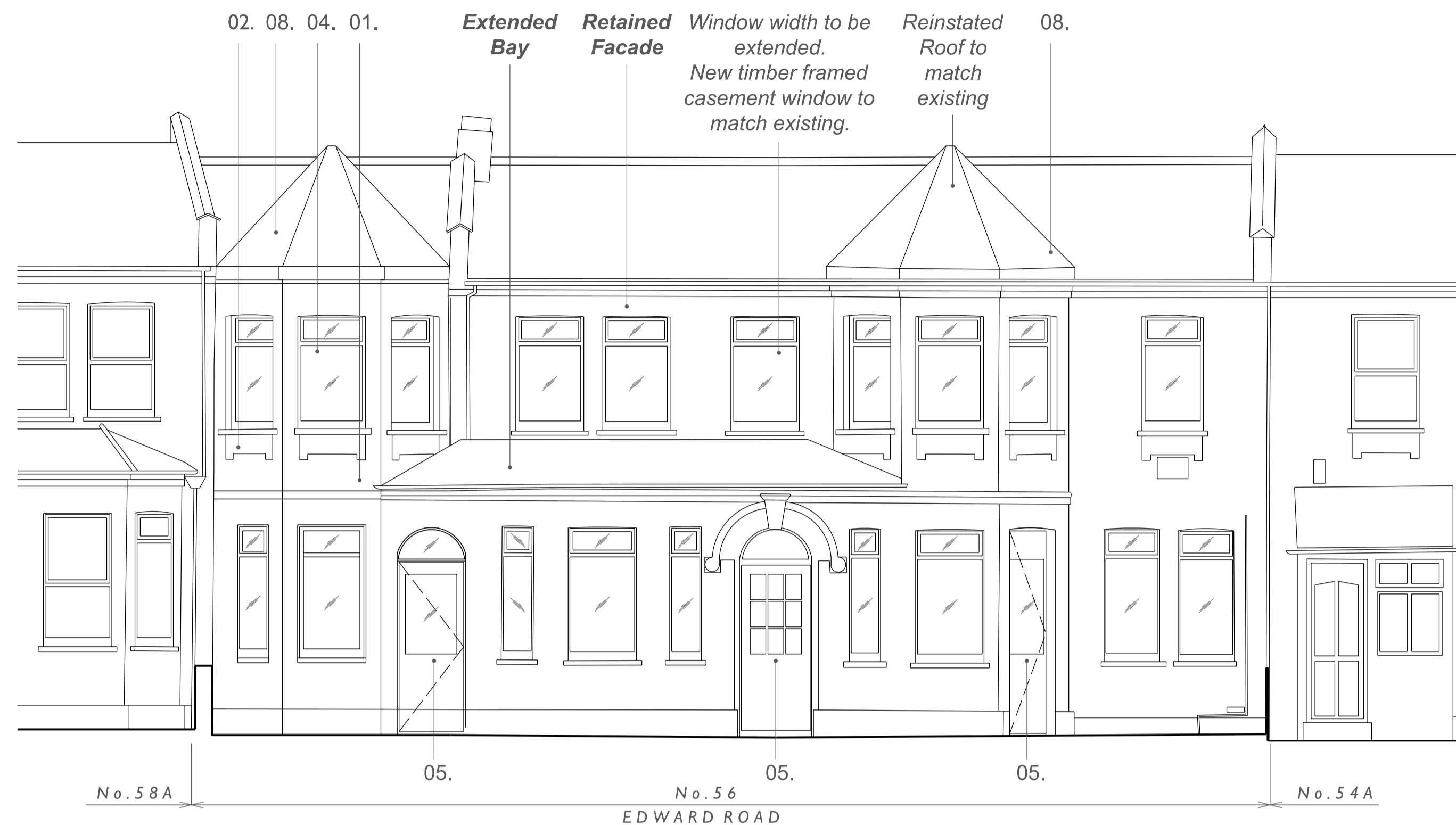

FRONT ELEVATION
Proposed

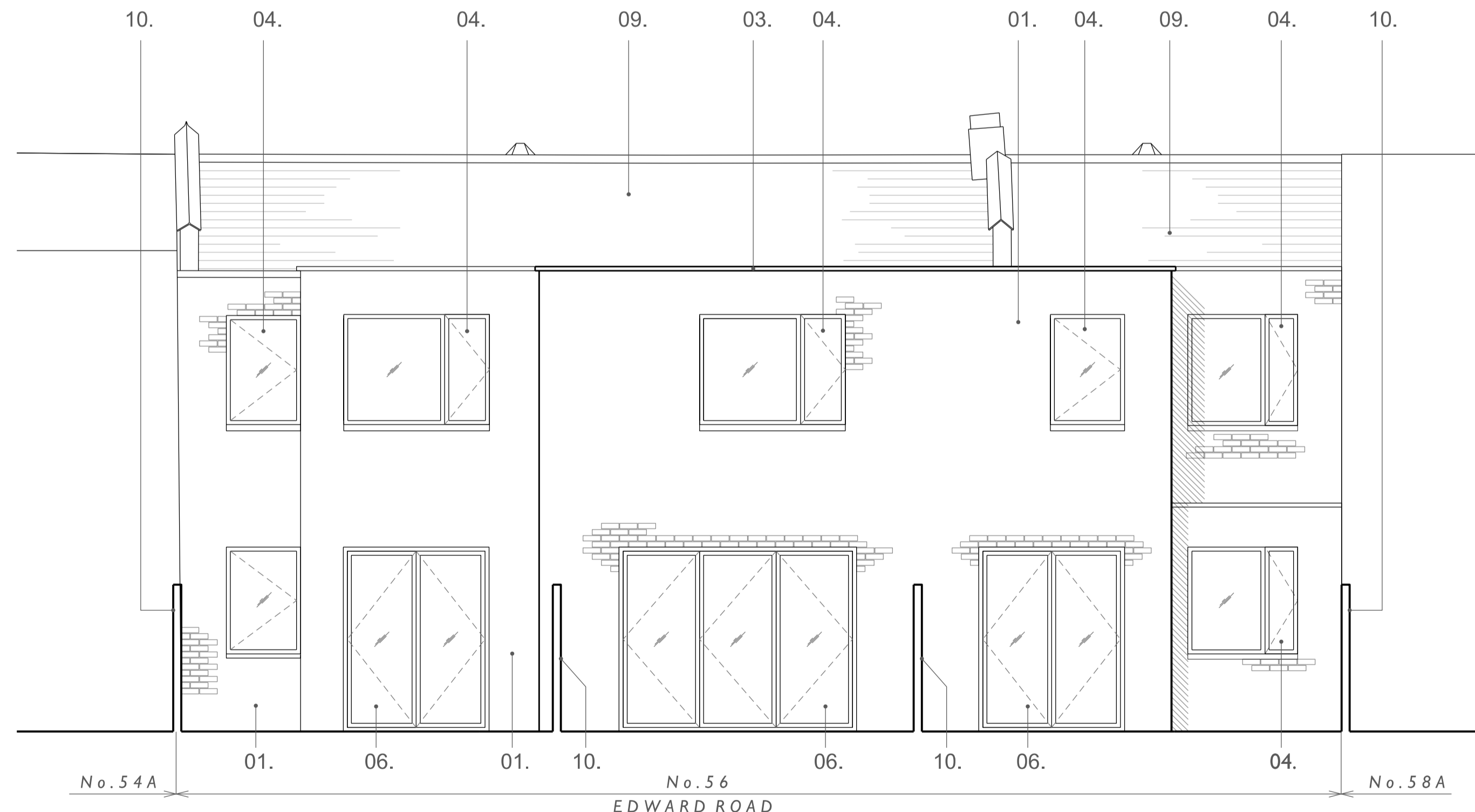

REAR ELEVATION
Proposed

NOTES
This drawing is not to be scaled for anything other than planning purposes only. It is not to be used for building regulations or construction purposes. All dimensions are to be confirmed on site. Architect to be informed of any discrepancies before any action is taken. This drawing is copyright © Smith & Newton Architects Ltd.

REV DATE	ISSUED BY - CK	Initial Issue
00	20.04.20 KP CS	Initial Issue
01	16.04.21 KP DN	Pre-Application Revision
02	05.05.21 KP DN	Pre-Application Revision
03	23.07.21 KP DN	Planning Application
04	14.09.21 KP DN	Revised Drawing

NOTES
Drawing Scales (for planning use only)
0 2m 4m
1:100

- DRAWING KEY**
- 01. Mixed London Stock Brickwork
 - 02. Red Brickwork [To match Red Brickwork window header & window surrounds]
 - 03. Coping Stone
 - 04. Aluminium framed, double glazed operable window
 - 05. Painted timber entrance door, with glazed vision panels
 - 06. Aluminium framed double glazed patio door/s
 - 07. Profiled concrete tiled roof
 - 08. Slate tiles to match existing
 - 09. Re-built pitched roof. Composite tile clad. [Marley Eternit or Equal Equivalent]
 - 10. Closed panel timber fence with concrete support posts & concrete gravel board

SMITH & NEWTON ARCHITECTS
A Studio 26, Hatherley Mews, Walthamstow, London, E17 4QP
T +44 (0)20 8520 3867
E info@smith-newton.com

Project Edward Road	Site Address 56 Edward Road, Walthamstow, E17 6LU
Drawing Title Front & Rear Elevation Proposed	
Status Planning	Scale(s) at A3 1:100
Drawing Reference 0439-02-0501	Revision 04

0 1m 2m 3m 4m 5m
1:100

NOTES
 This drawing is not to be scaled for anything other than planning purposes only. It is not to be used for building regulations or construction purposes. All dimensions are to be confirmed on site. Architect to be informed of any discrepancies before any action is taken. This drawing is copyright © Smith & Newton Architects Ltd.

REV DATE	ISSUED BY - CK
00	15.10.19 KP CS Initial Issue
01	20.04.20 KP CS Updated Issue
02	14.09.21 KP DN Revised Issue

NOTES
 Drawing Scales (for planning use only)

■ Cut through building

--- Dashed line to indicate fence height

- DRAWING KEY**
- 01. Mixed London Stock Brickwork
 - 02. Red Brickwork [To match Red Brickwork window header & window surrounds]
 - 03. Coping Stone
 - 04. Aluminium framed, double glazed openable window
 - 05. Painted timber entrance door, with glazed vision panels
 - 06. Aluminium framed double glazed patio door/s
 - 07. Profiled concrete tiled roof
 - 08. Slate tiles to match existing
 - 09. Re-built pitched roof. Composite tile clad. [Marley Eternit or Equal Equivalent]
 - 10. Closed panel timber fence with concrete support posts & concrete gravel board

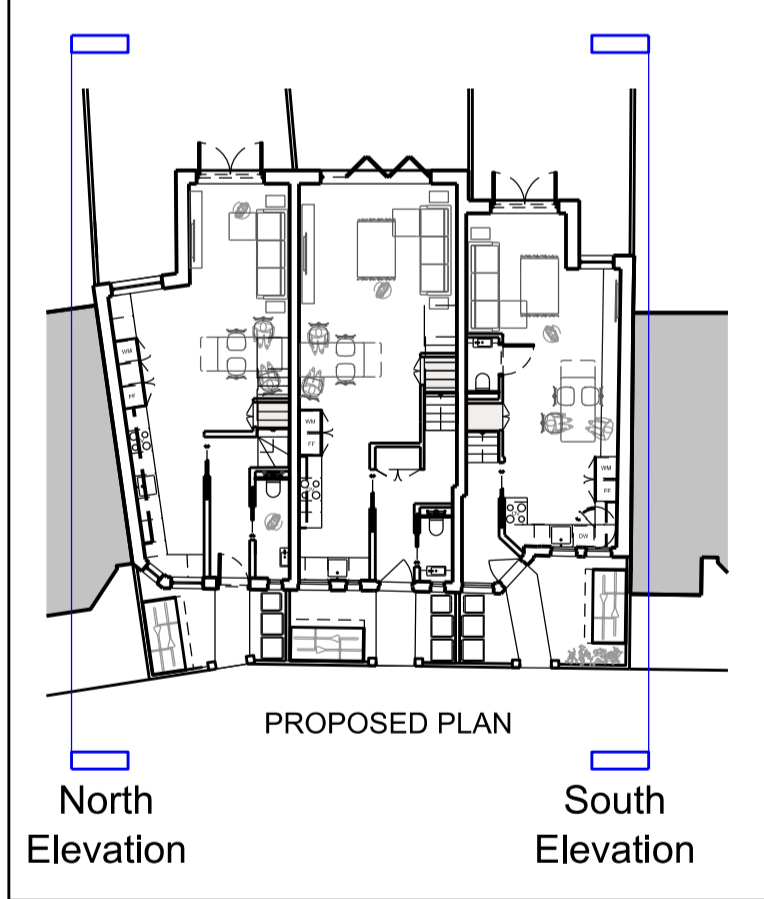

SMITH & NEWTON ARCHITECTS

A Studio 26, Hatherley Mews, Walthamstow, London, E17 4QP
 T +44 (0)20 8520 3867
 E info@smith-newton.com

Project Edward Road	Site Address 58 Edward Road, Walthamstow, E17 6LU
Drawing Title Side Elevations Existing & Proposed	
Status Preliminary	Scale(s) at A3 1:100
Drawing Reference 0439-02-0502	Revision 02

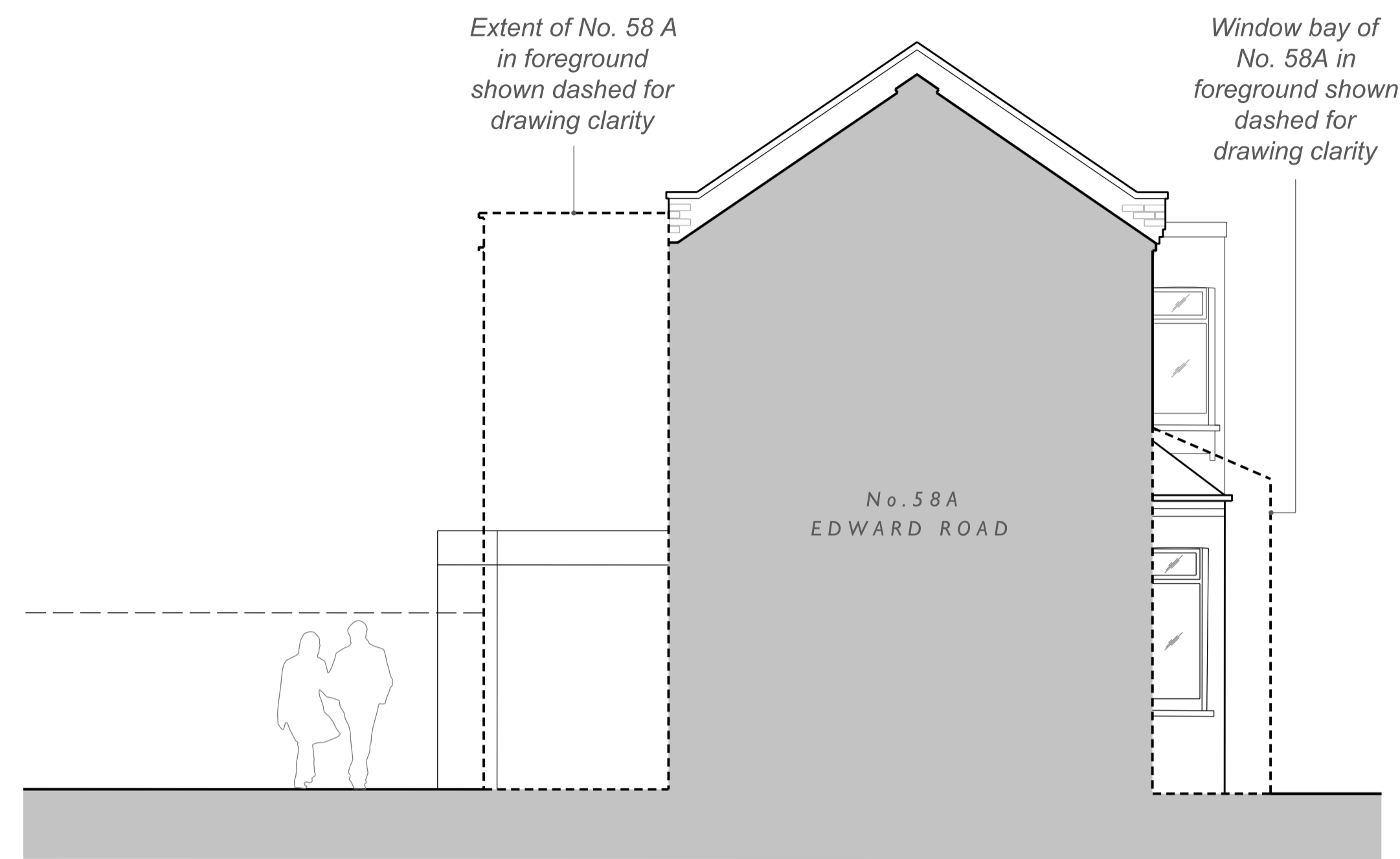

SIDE ELEVATION (NORTH)
Existing

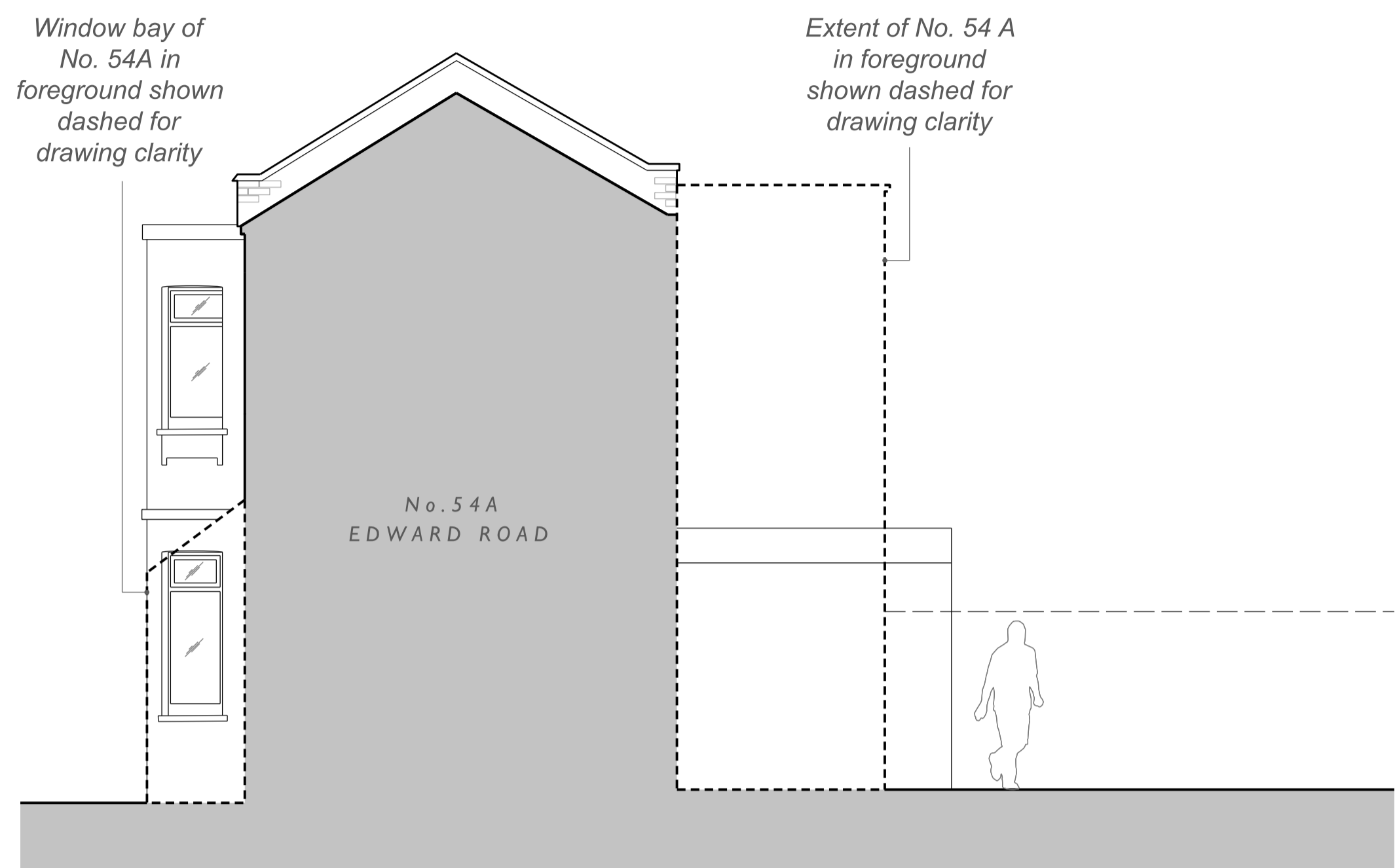

SIDE ELEVATION (SOUTH)
Existing

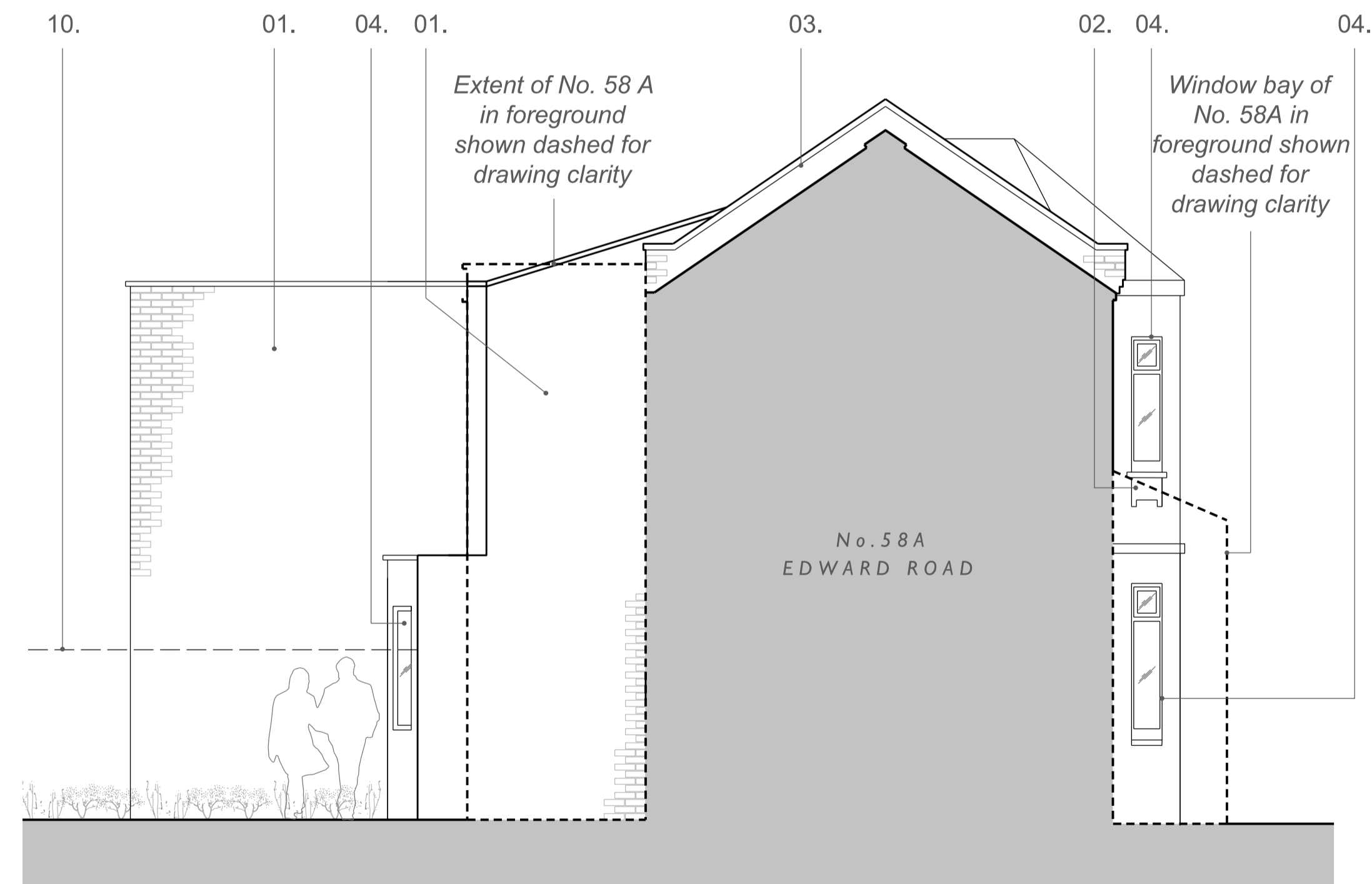

SIDE ELEVATION (NORTH)
Proposed

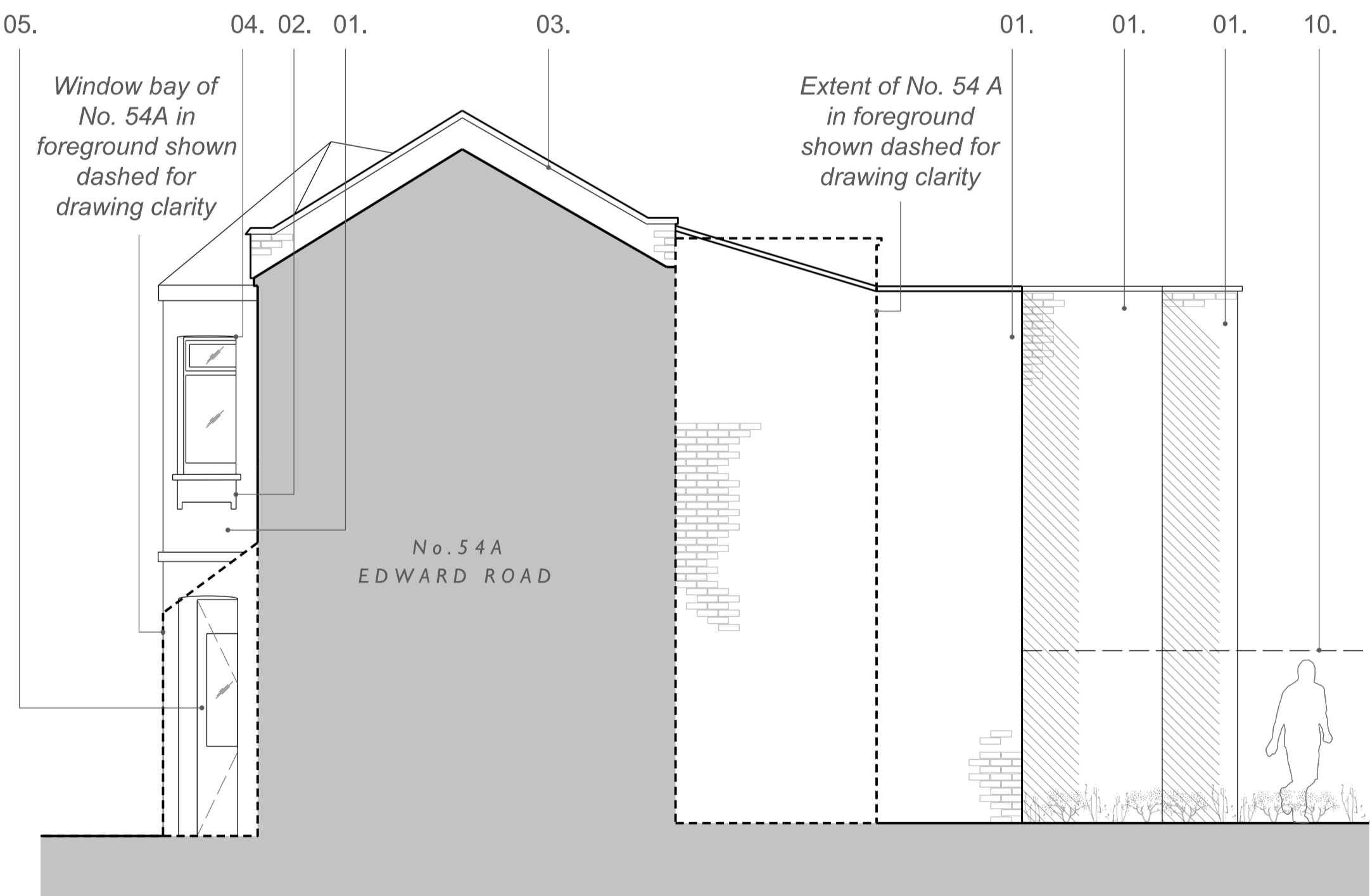

SIDE ELEVATION (SOUTH)
Proposed

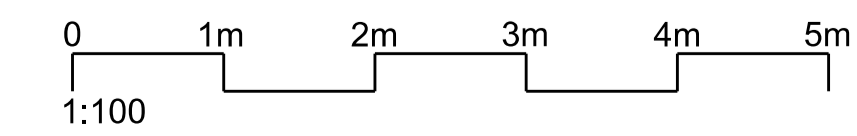

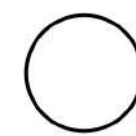

NOTES
 This drawing is not to be scaled for anything other than planning purposes only. It is not to be used for building regulations or construction purposes. All dimensions are to be confirmed on site. Architect to be informed of any discrepancies before any action is taken. This drawing is copyright © Smith & Newton Architects Ltd.

REV DATE	BY	CK	ISSUED
00	20.04.20	KP	CS Initial Issue
01	16.04.21	KP	DN Revised Issue
02	05.05.21	KP	DN Revised Issue

NOTES
 Drawing Scales (for planning use only)
 0 5m
 1:200



STREET ELEVATION
 Existing



STREET ELEVATION
 Proposed

SMITH & NEWTON ARCHITECTS

A Studio 26, Hatherley Mews, Walthamstow, London, E17 4QP
 T +44 (0)20 8520 3867
 E info@smith-newton.com

Project	Edward Road	Site Address	56 Edward Road, Walthamstow, E17 6LU
Drawing Title	Street Elevation Existing & Proposed		
Status	Preliminary	Scale(s) at A3	1:200
Drawing Reference	0439-02-0503	Revision	02

NOTES
 This drawing is not to be scaled for anything other than planning purposes only. It is not to be used for building regulations or construction purposes. All dimensions are to be confirmed on site. Architect to be informed of any discrepancies before any action is taken. This drawing is copyright © Smith & Newton Architects Ltd.

REV DATE	ISSUED BY - CK	DESCRIPTION
00	16.04.21	KP DN Pre-Application Revision
01	05.05.21	KP DN Pre-Application Revision

NOTES
 Drawing Scales (for planning use only)
 0 2m 4m
 1:100



FRONT ELEVATION
 Existing



FRONT ELEVATION
 Proposed

0 1m 2m 3m 4m 5m
 1:100

SMITH & NEWTON ARCHITECTS
 A Studio 26, Hatherley Mews, Walthamstow, London, E17 4QP
 T +44 (0)20 8520 3867
 E info@smith-newton.com

Project Edward Road	Site Address 56 Edward Road, Walthamstow, E17 6LU
Drawing Title Road Elevation Proposed	
Status Preliminary	Scale(s) at A3 1:100
Drawing Reference 0439-02-0550	Revision 01

This drawing is not to be scaled for anything other than planning purposes only. It is not to be used for building regulations or construction purposes. All dimensions are to be confirmed on site. Architect to be informed of any discrepancies before any action is taken. This drawing is copyright © Smith & Newton Architects Ltd.

REV	DATE	BY	CHK	ISSUED
00	15.12.21	DN	CS	Planning Issue
01	21.12.21	DN	CS	Planning Issue Update

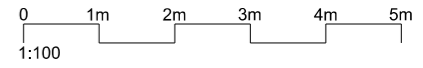

NOTES

Residential Extensions and Alterations Supplementary Planning Document

Extract from Page 40.

An extension should not exceed a line taken at 45 degrees from the edge of the nearest ground floor window if a habitable room in an adjoining property if the proposed extension is single storey. For extensions greater than one storey, the 45 degree line is taken from the centre of the nearest window of an adjoining property.

All existing drawings & levels based on measured survey drawings received from Lawson Surveying.

SMITH & NEWTON ARCHITECTS
 RIBA CHARTERED PRACTICE
 A 9 Shepherd's Lane, Homerton, London E9 6JJ
 T +44 (0)20 8520 3867
 E info@smith-newton.com W www.smith-newton.com

Project: Edward Road
 Site Address: 56 Edward Road, Walthamstow, E17 6LU
 Drawing Title: Part Plan & Rear Elevation Views Proposed

Status: Planning
 Scale(s) at A3: 1:100 @ A3

DRAWING: 0439-03-0560
 REVISION: 01



PART GROUND FLOOR PLAN
Proposed

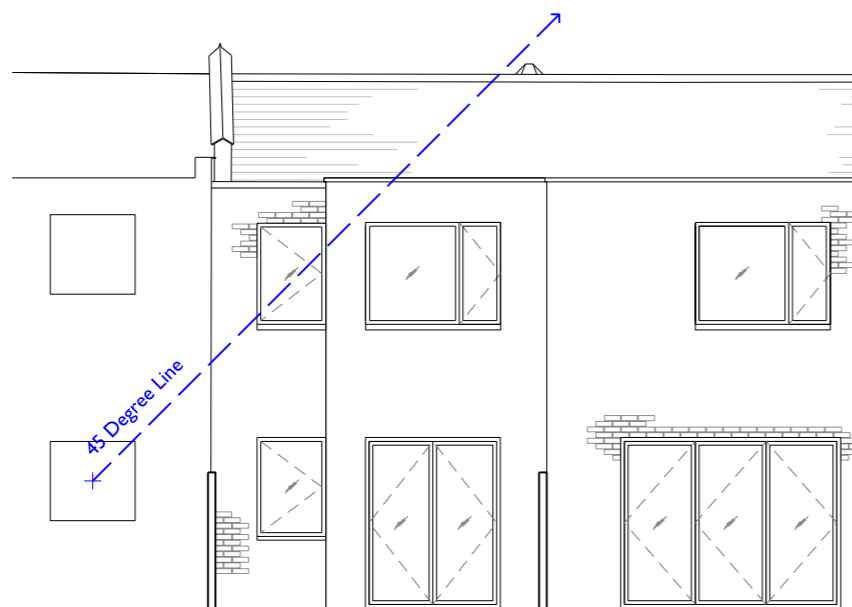

PART REAR ELEVATION VIEW-01
Proposed

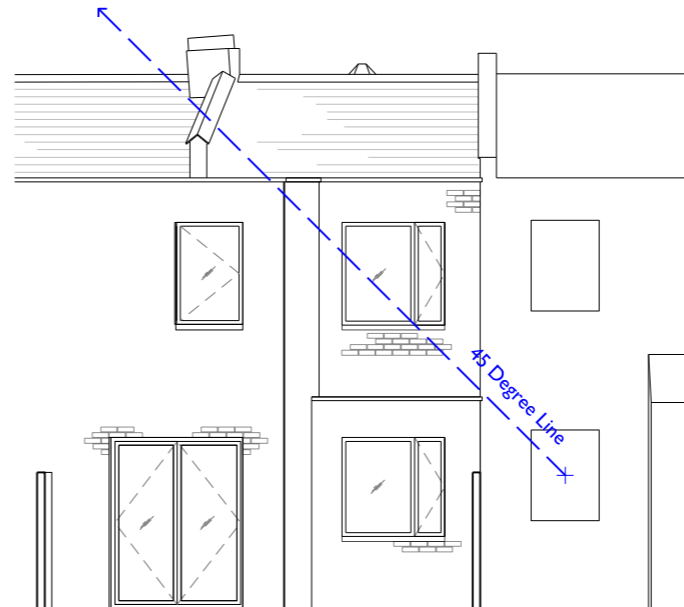

PART REAR ELEVATION VIEW-02
Proposed

This drawing is not to be scaled for anything other than planning purposes only. It is not to be used for building regulations or construction purposes. All dimensions are to be confirmed on site. Architect to be informed of any discrepancies before any action is taken. This drawing is copyright © Smith & Newton Architects Ltd.

REV DATE	BY	ISSUED
00	15.12.21	JC DN Preliminary Issue

NOTES



REAR MASSING VIEW - 01
Proposed



REAR MASSING VIEW - 02
Proposed



REAR MASSING VIEW - 03
Proposed



REAR MASSING VIEW - 04
Proposed

SMITH & NEWTON
ARCHITECTS
RIBA CHARTERED PRACTICE

A 9 Shepherd's Lane, Homerton, London E9 6JJ
T +44 (0)20 8520 3867
E info@smith-newton.com W www.smith-newton.com

Project	Site Address
Edward Road	56 Edward Road, Walthamstow, E17 6LU
Drawing Title	
Rear 3D Massing Views	
Proposed	

Status	Scale(s) at A3
Planning	Not To Scale

DRAWING	REVISION
0439-03-9000	00