

General Notes
 © Copyright Stephen Davy Peter Smith Architects 2018
 These proposals are subject to the approval of all Statutory Building Control requirements and the requirements of all Statutory Authorities and Service Providers.
 The site boundaries and surroundings are based on the following:
 • OS Map / Measured survey by Xxxxxxx
 The site boundaries are those described by the client.
 These drawings are to be read in conjunction with all other relevant documentation produced by Stephen Davy Peter Smith Architects and other consultants employed by the client.

Specific Notes

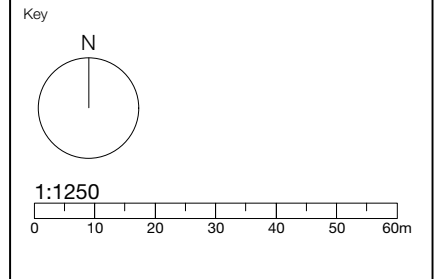

Rev	Drawn	Notes	Date
P0	SD		
Rev	Checked	Date	Approved

REVISIONS

Client	
Atlantis Highams Ltd	
A	APPROVED
B	APPROVED WITH COMMENTS
C	DO NOT USE

CLIENT APPROVAL

stephen davy architects
peter smith

Fanshaw House, Fanshaw Street, London N1 6HX
 Tel: 020 7739 2020 Fax: 020 7739 2021
 E-mail: sdpsa@davysmitharchitects.co.uk
 Website: www.davysmitharchitects.co.uk

Project
 Larkshall Road

Drawing Ref. LKR - DS - 00 - GF - DR - A - P001	Job No. 1820
Purpose of Issue PLANNING	Scale 1:1250 @ A3

Drawing Title
Location Plan

Project Ref - Drawing No - Status - Revision
LKR - P001 - S0 - P0

- ① **Brickwork:** Birtley Brown Waterstruck brick, stretcher bond.
- ② **Brickwork:** Flint Waterstruck brick, stretcher bond.
- ③ **Stone:** White reconstituted smooth finish stone panels, colour Portland.
- ④ **Stone:** White reconstituted smooth finish stone banding, colour Portland.
- ⑤ **Windows & Doors:** To be composite timber/powder coated aluminium, Anolok 543.
- ⑥ **Shop Front Glazing:** Anolok 543 to match windows & doors.
- ⑦ **Service Doors:** Steel louvred door, Anolok 543.
- ⑧ **Screen:** Pilkington Profilit U-shaped profiled glass.

- ⑨ **Balustrades:** Steel flats, Anolok 543.
- ⑩ **Solid Balcony Balustrades:** Steel flats, Anolok 543. Solid metal panel to inner face of balustrade.
- ⑪ **Gate:** Steel flats, Anolok 543.
- ⑫ **Coping:** Reconstituted stones copings, colour to match stone panels.
- ⑬ **New Trees.**
- ⑭ **Ceramic Tile.**
- ⑮ **Sawtooth decorative brick.**
- ⑯ **Sawtooth decorative stone panel.**

- ⑰ **Deck access balustrades:** U-shaped glass fixed within channel between anodised handrail support structure.
- ⑱ **Deck access screen:** Full height U-shaped glass spanning between walkway slabs.
- ⑲ **Deck access fins:** Full height metal fins spanning between walkway slabs, Anolok 543.

General Notes
 © Copyright Stephen Davy Peter Smith Architects 2021
 These proposals are subject to the approval of all Statutory Building Control requirements and the requirements of all Statutory Authorities and Service Providers.
 The site boundaries and surroundings are based on the following:
 • OS Map / Measured survey by Xxxxxxx
 The site boundaries are those described by the client.
 These drawings are to be read in conjunction with all other relevant documentation produced by Stephen Davy Peter Smith Architects and other consultants employed by the client.

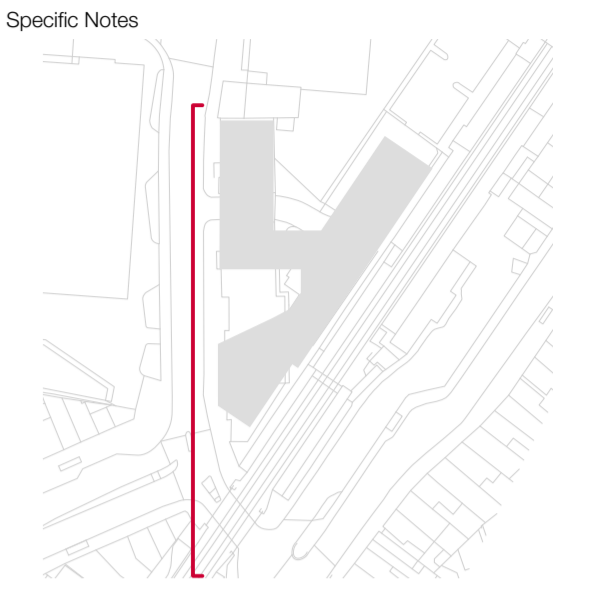

Legend

Key



P1 3	TK	Block B amended. Issued for planning.	09/11/21
P1 2	TK	Amended landscape. Issued for planning.	20/07/21
P1 1	TK	Elevation amended. Issued for planning.	05/07/21
Rev	Drawn	Notes	Date
SD	SD		
Rev	Checked	Date	Approved Date

Client
Atlantis Highams Ltd

A - APPROVED
B - APPROVED WITH COMMENTS
C - DO NOT USE

CLIENT APPROVAL
stephen davy architects peter smith
 Farshaw House, Farshaw Street, London N1 6HX
 Tel: 020 7739 2020 Fax: 020 7739 2021
 E-mail: sdpsa@daysmitharchitects.co.uk
 Website: www.daysmitharchitects.co.uk

Project
Larkshall Road

Drawing Ref. LKR - DS - 00 - ZZ - DR - A - D200	Job No. 1820
Purpose of Issue PLANNING	Scale 1:200 @ A1

Drawing Title
Front Elevation - Along Larkshall Road

Project Ref - Drawing No - Status - Revision
1 8 2 0 - D 2 0 0 - S 0 - P 1 3

- ① **Brickwork:** Birtley Brown Waterstruck brick, stretcher bond.
- ② **Brickwork:** Flint Waterstruck brick, stretcher bond.
- ③ **Stone:** White reconstituted smooth finish stone panels, colour Portland.
- ④ **Stone:** White reconstituted smooth finish stone banding, colour Portland.
- ⑤ **Windows & Doors:** To be composite timber/powder coated aluminium, Anolok 543.
- ⑥ **Shop Front Glazing:** Anolok 543 to match windows & doors.
- ⑦ **Service Doors:** Steel louvred door, Anolok 543.
- ⑧ **Screen:** Pilkington Profilit U-shaped profiled glass.

- ⑨ **Balustrades:** Steel flats, Anolok 543.
- ⑩ **Solid Balcony Balustrades:** Steel flats, Anolok 543. Solid metal panel to inner face of balustrade.
- ⑪ **Gate:** Steel flats, Anolok 543.
- ⑫ **Coping:** Reconstituted stones copings, colour to match stone panels.
- ⑬ **New Trees.**
- ⑭ **Ceramic Tile.**
- ⑮ **Sawtooth decorative brick.**
- ⑯ **Sawtooth decorative stone panel.**

- ⑰ **Deck access balustrades:** U-shaped glass fixed within channel between anodised handrail support structure.
- ⑱ **Deck access screen:** Full height U-shaped glass spanning between walkway slabs.
- ⑲ **Deck access fins:** Full height metal fins spanning between walkway slabs, Anolok 543.

General Notes
 © Copyright Stephen Davy Peter Smith Architects 2021
 These proposals are subject to the approval of all Statutory Building Control requirements and the requirements of all Statutory Authorities and Service Providers.
 The site boundaries and surroundings are based on the following:
 • OS Map / Measured survey by Xxxxxxx
 The site boundaries are those described by the client.
 These drawings are to be read in conjunction with all other relevant documentation produced by Stephen Davy Peter Smith Architects and other consultants employed by the client.



Legend

Key



Rev	Drawn	Notes	Date
P1 2	TK	Block B amended. Issued for planning.	09/11/21
P1 1	TK	Trees removed. Issued for planning.	20/07/21
P1 0	TK	Elevation amended. Issued for planning.	05/07/21

Rev	Checked	Date	Approved	Date
SD				

CLIENT APPROVAL

stephen davy architects
peter smith

Farshaw House, Farshaw Street, London N1 6HX
 Tel: 020 7739 0020 Fax: 020 7739 2021
 E-mail: sdpsa@dayvsmitharchitects.co.uk
 Website: www.dayvsmitharchitects.co.uk

Project
 Larkshall Road

Drawing Ref. LKR - DS - 00 - ZZ - DR - A - D201	Job No. 1820
Purpose of Issue PLANNING	Scale 1:100 @ A1
Drawing Title Rear Elevation along the railway	
Project Ref - Drawing No - Status - Revision 1 8 2 0 - D 2 0 1 - S 0 - P 1 2	

- ① **Brickwork:** Birtley Brown Waterstruck brick, stretcher bond.
- ② **Brickwork:** Flint Waterstruck brick, stretcher bond.
- ③ **Stone:** White reconstituted smooth finish stone panels, colour Portland.
- ④ **Stone:** White reconstituted smooth finish stone banding, colour Portland.
- ⑤ **Windows & Doors:** To be composite timber/powder coated aluminium, Anolok 543.
- ⑥ **Shop Front Glazing:** Anolok 543 to match windows & doors.
- ⑦ **Service Doors:** Steel louvred door, Anolok 543.
- ⑧ **Screen:** Pilkington Profilit U-shaped profiled glass.

- ⑨ **Balustrades:** Steel flats, Anolok 543.
- ⑩ **Solid Balcony Balustrades:** Steel flats, Anolok 543. Solid metal panel to inner face of balustrade.
- ⑪ **Gate:** Steel flats, Anolok 543.
- ⑫ **Coping:** Reconstituted stones copings, colour to match stone panels.
- ⑬ **New Trees.**
- ⑭ **Ceramic Tile.**
- ⑮ **Sawtooth decorative brick.**
- ⑯ **Sawtooth decorative stone panel.**

- ⑰ **Deck access balustrades:** U-shaped glass fixed within channel between anodised handrail support structure.
- ⑱ **Deck access screen:** Full height U-shaped glass spanning between walkway slabs.
- ⑲ **Deck access fins:** Full height metal fins spanning between walkway slabs, Anolok 543.

General Notes
 © Copyright Stephen Davy Peter Smith Architects 2021
 These proposals are subject to the approval of all Statutory Building Control requirements and the requirements of all Statutory Authorities and Service Providers.
 The site boundaries and surroundings are based on the following:
 • OS Map / Measured survey by Xxxxxxx
 The site boundaries are those described by the client.
 These drawings are to be read in conjunction with all other relevant documentation produced by Stephen Davy Peter Smith Architects and other consultants employed by the client.

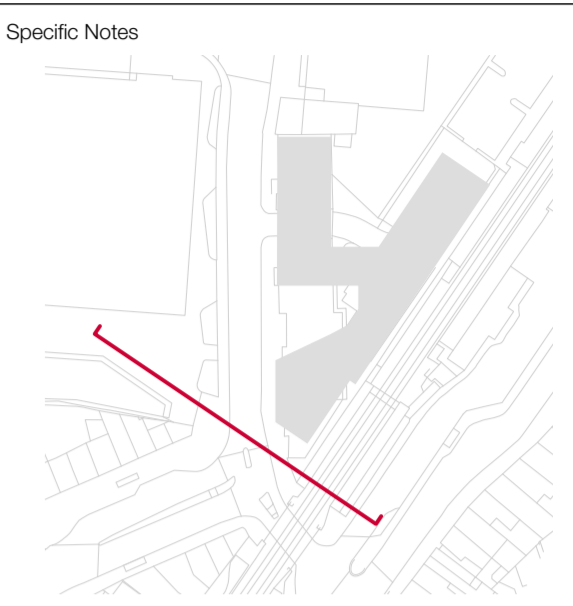

Legend

Key

Rev	Drawn	Notes	Date
P1	TK	Block B amended. Issued for planning.	09/11/21
P1	Q	Amended landscape. Issued for planning.	20/07/21
P9	TK	Elevation amended. Issued for planning.	05/07/21

Rev	Checked	Date	Approved	Date
SD				

REVISIONS

Client
Atlantis Highams Ltd

- A - APPROVED
- B - APPROVED WITH COMMENTS
- C - DO NOT USE

CLIENT APPROVAL

stephen davy architects
peter smith

Farshaw House, Farshaw Street, London N1 6HX
 Tel: 020 7739 2020 Fax: 020 7739 2021
 E-mail: sdpsa@davysmitharchitects.co.uk
 Website: www.davysmitharchitects.co.uk

Project
Larkshall Road

Drawing Ref.
LKR - DS - 00 - ZZ - DR - A - D202

Job No.
1820

Purpose of Issue
PLANNING

Scale
1:100 @ A1

Drawing Title
Front Elevation

Project Ref - Drawing No - Status - Revision
1 8 2 0 - D 2 0 2 - S 0 - P 1 1



- ① **Brickwork:** Birtley Brown Waterstruck brick, stretcher bond.
- ② **Brickwork:** Flint Waterstruck brick, stretcher bond.
- ③ **Stone:** White reconstituted smooth finish stone panels, colour Portland.
- ④ **Stone:** White reconstituted smooth finish stone banding, colour Portland.
- ⑤ **Windows & Doors:** To be composite timber/powder coated aluminium, Anolok 543.
- ⑥ **Shop Front Glazing:** Anolok 543 to match windows & doors.
- ⑦ **Service Doors:** Steel louvred door, Anolok 543.
- ⑧ **Screen:** Pilkington Profilit U-shaped profiled glass.
- ⑨ **Balustrades:** Steel flats, Anolok 543.
- ⑩ **Solid Balcony Balustrades:** Steel flats, Anolok 543. Solid metal panel to inner face of balustrade.
- ⑪ **Gate:** Steel flats, Anolok 543.
- ⑫ **Coping:** Reconstituted stones copings, colour to match stone panels.
- ⑬ **New Trees.**
- ⑭ **Ceramic Tile.**
- ⑮ **Sawtooth decorative brick.**
- ⑯ **Sawtooth decorative stone panel.**
- ⑰ **Deck access balustrades:** U-shaped glass fixed within channel between anodised handrail support structure.
- ⑱ **Deck access screen:** Full height U-shaped glass spanning between walkway slabs.
- ⑲ **Deck access fins:** Full height metal fins spanning between walkway slabs, Anolok 543.

General Notes
 © Copyright Stephen Davy Peter Smith Architects 2021
 These proposals are subject to the approval of all Statutory Building Control requirements and the requirements of all Statutory Authorities and Service Providers.
 The site boundaries and surroundings are based on the following:
 • OS Map / Measured survey by Xxxxxxxx
 The site boundaries are those described by the client.
 These drawings are to be read in conjunction with all other relevant documentation produced by Stephen Davy Peter Smith Architects and other consultants employed by the client.

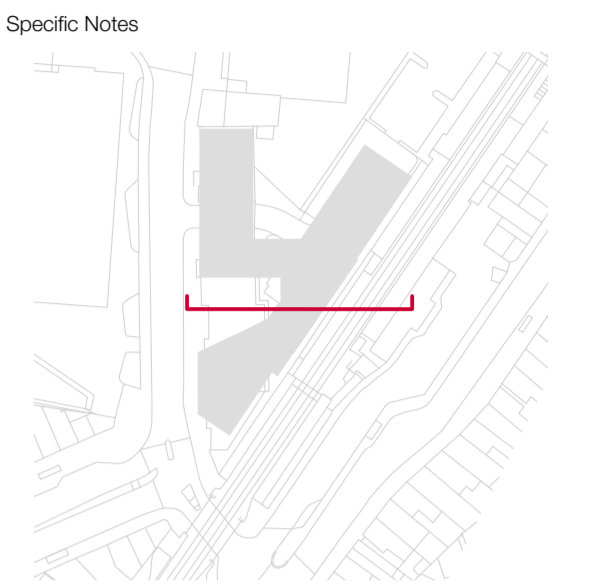

Legend

Key

Rev	Drawn	Notes	Date
SD	SD		
Rev	Checked	Date	Approved

REVISIONS

Client
Atlantis Highams Ltd

- A - APPROVED
- B - APPROVED WITH COMMENTS
- C - DO NOT USE

CLIENT APPROVAL

stephen davy architects
peter smith
 Farshaw House, Farshaw Street, London N1 6HX
 Tel: 020 7739 2020 Fax: 020 7739 2021
 E-mail: sdpsa@davysmitharchitects.co.uk
 Website: www.davysmitharchitects.co.uk

Project
 Larkshall Road

Drawing Ref. LKR - DS - 00 - ZZ - DR - A - D203	Job No. 1820
Purpose of Issue PLANNING	Scale 1:100 @ A1

Drawing Title
Section AA, through the square looking north

Project Ref - Drawing No - Status - Revision
1 8 2 0 - D 2 0 3 - S 0 - P 8

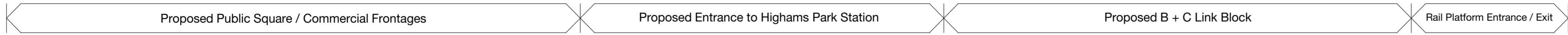

- 1 **Brickwork:** Birtley Brown Waterstruck brick, stretcher bond.
- 2 **Brickwork:** Flint Waterstruck brick, stretcher bond.
- 3 **Stone:** White reconstituted smooth finish stone panels, colour Portland.
- 4 **Stone:** White reconstituted smooth finish stone banding, colour Portland.
- 5 **Windows & Doors:** To be composite timber/powder coated aluminium, Anolok 543.
- 6 **Shop Front Glazing:** Anolok 543 to match windows & doors.
- 7 **Service Doors:** Steel louvred door, Anolok 543.
- 8 **Screen:** Pilkington Proflit U-shaped profiled glass.

- 9 **Balustrades:** Steel flats, Anolok 543.
- 10 **Solid Balcony Balustrades:** Steel flats, Anolok 543. Solid metal panel to inner face of balustrade.
- 11 **Gate:** Steel flats, Anolok 543.
- 12 **Coping:** Reconstituted stones copings, colour to match stone panels.
- 13 **New Trees.**
- 14 **Ceramic Tile.**
- 15 **Sawtooth decorative brick.**
- 16 **Sawtooth decorative stone panel.**

- 17 **Deck access balustrades:** U-shaped glass fixed within channel between anodised handrail support structure.
- 18 **Deck access screen:** Full height U-shaped glass spanning between walkway slabs.
- 19 **Deck access fins:** Full height metal fins spanning between walkway slabs, Anolok 543.

General Notes
 © Copyright Stephen Davy Peter Smith Architects 2021
 These proposals are subject to the approval of all Statutory Building Control requirements and the requirements of all Statutory Authorities and Service Providers.
 The site boundaries and surroundings are based on the following:
 • OS Map / Measured survey by Xxxxxxx
 The site boundaries are those described by the client.
 These drawings are to be read in conjunction with all other relevant documentation produced by Stephen Davy Peter Smith Architects and other consultants employed by the client.

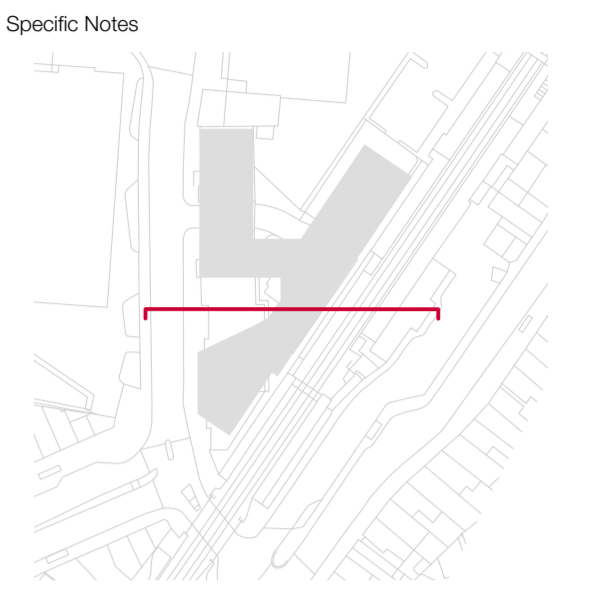

Legend

Key

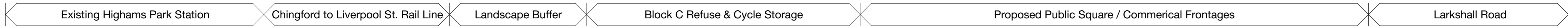

Rev	Drawn	Notes	Date	
P1	TK	Block B amended. Issued for planning.	09/11/21	
P1	Q	Amended landscape. Issued for planning.	20/07/21	
P9	TK	Elevation amended. Issued for planning.	05/07/21	
SD	SD			
Rev	Checked	Date	Approved	Date

REVISIONS

Client	
Atlantis Highams Ltd	
A - APPROVED	
B - APPROVED WITH COMMENTS	
C - DO NOT USE	

CLIENT APPROVAL

stephen davy architects
peter smith

Farshaw House, Farshaw Street, London N1 6HX
 Tel: 020 7739 2020 Fax: 020 7739 2021
 E-mail: sdpsa@dayvsmitharchitects.co.uk
 Website: www.dayvsmitharchitects.co.uk

Project Larkshall Road	
Drawing Ref. LKR - DS - 00 - ZZ - DR - A - D203	Job No. 1820
Purpose of Issue PLANNING	Scale 1:100 @ A1

Drawing Title
Section South Through Square

Project Ref - Drawing No - Status - Revision
1 8 2 0 - D 2 0 4 - S 0 - P 1 1

- ① **Brickwork:** Birtley Brown Waterstruck brick, stretcher bond.
- ② **Brickwork:** Flint Waterstruck brick, stretcher bond.
- ③ **Stone:** White reconstituted smooth finish stone panels, colour Portland.
- ④ **Stone:** White reconstituted smooth finish stone banding, colour Portland.
- ⑤ **Windows & Doors:** To be composite timber/powder coated aluminium, Anolok 543.
- ⑥ **Shop Front Glazing:** Anolok 543 to match windows & doors.
- ⑦ **Service Doors:** Steel louvred door, Anolok 543.
- ⑧ **Screen:** Pilkington Proflit U-shaped profiled glass.

- ⑨ **Balustrades:** Steel flats, Anolok 543.
- ⑩ **Solid Balcony Balustrades:** Steel flats, Anolok 543. Solid metal panel to inner face of balustrade.
- ⑪ **Gate:** Steel flats, Anolok 543.
- ⑫ **Coping:** Reconstituted stones copings, colour to match stone panels.
- ⑬ **New Trees.**
- ⑭ **Ceramic Tile.**
- ⑮ **Sawtooth decorative brick.**
- ⑯ **Sawtooth decorative stone panel.**

- ⑰ **Deck access balustrades:** U-shaped glass fixed within channel between anodised handrail support structure.
- ⑱ **Deck access screen:** Full height U-shaped glass spanning between walkway slabs.
- ⑲ **Deck access fins:** Full height metal fins spanning between walkway slabs, Anolok 543.

General Notes
 © Copyright Stephen Davy Peter Smith Architects 2020
 These proposals are subject to the approval of all Statutory Building Control requirements and the requirements of all Statutory Authorities and Service Providers.
 The site boundaries and surroundings are based on the following:
 • OS Map / Measured survey by Xxxxxxxx
 The site boundaries are those described by the client.
 These drawings are to be read in conjunction with all other relevant documentation produced by Stephen Davy Peter Smith Architects and other consultants employed by the client.

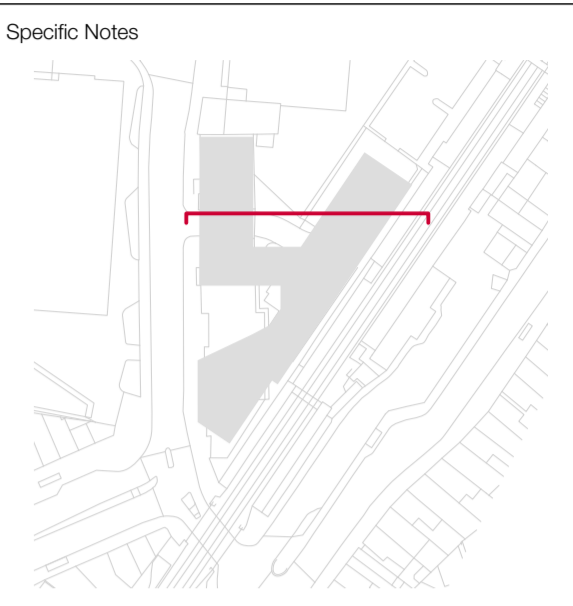

Legend

Key



Rev	Drawn	Notes	Date
P6	TK	Block B amended. Issued for planning.	09/11/21
P5	TK	Elevation amended. Issued for planning.	28/05/21
P4	TK	Elevation amended. Issued for planning.	04/02/21

Rev	Checked	Date	Approved	Date

REVISIONS

Client
Atlantis Highams Ltd

- A - APPROVED
- B - APPROVED WITH COMMENTS
- C - DO NOT USE

CLIENT APPROVAL

stephen davy architects
peter smith
 Farshaw House, Farshaw Street, London N1 6HX
 Tel: 020 7739 2020 Fax: 020 7739 2021
 E-mail: sdpsa@davysmitharchitects.co.uk
 Website: www.davysmitharchitects.co.uk

Project
Larkshall Road

Drawing Ref. LKR - DS - 00 - ZZ - DR - A - D203	Job No. 1820
Purpose of Issue PLANNING	Scale 1:100 @ A1

Drawing Title
Section South Through Blocks A and B

- 1 **Brickwork:** Birtley Brown Waterstruck brick, stretcher bond.
- 2 **Brickwork:** Flint Waterstruck brick, stretcher bond.
- 3 **Stone:** White reconstituted smooth finish stone panels, colour Portland.
- 4 **Stone:** White reconstituted smooth finish stone banding, colour Portland.
- 5 **Windows & Doors:** To be composite timber/powder coated aluminium, Anolok 543.
- 6 **Shop Front Glazing:** Anolok 543 to match windows & doors.
- 7 **Service Doors:** Steel louvred door, Anolok 543.
- 8 **Screen:** Pilkington Proflit U-shaped profiled glass.

- 9 **Balustrades:** Steel flats, Anolok 543.
- 10 **Solid Balcony Balustrades:** Steel flats, Anolok 543. Solid metal panel to inner face of balustrade.
- 11 **Gate:** Steel flats, Anolok 543.
- 12 **Coping:** Reconstituted stones copings, colour to match stone panels.
- 13 **New Trees.**
- 14 **Ceramic Tile.**
- 15 **Sawtooth decorative brick.**
- 16 **Sawtooth decorative stone panel.**

- 17 **Deck access balustrades:** U-shaped glass fixed within channel between anodised handrail support structure.
- 18 **Deck access screen:** Full height U-shaped glass spanning between walkway slabs.
- 19 **Deck access fins:** Full height metal fins spanning between walkway slabs, Anolok 543.

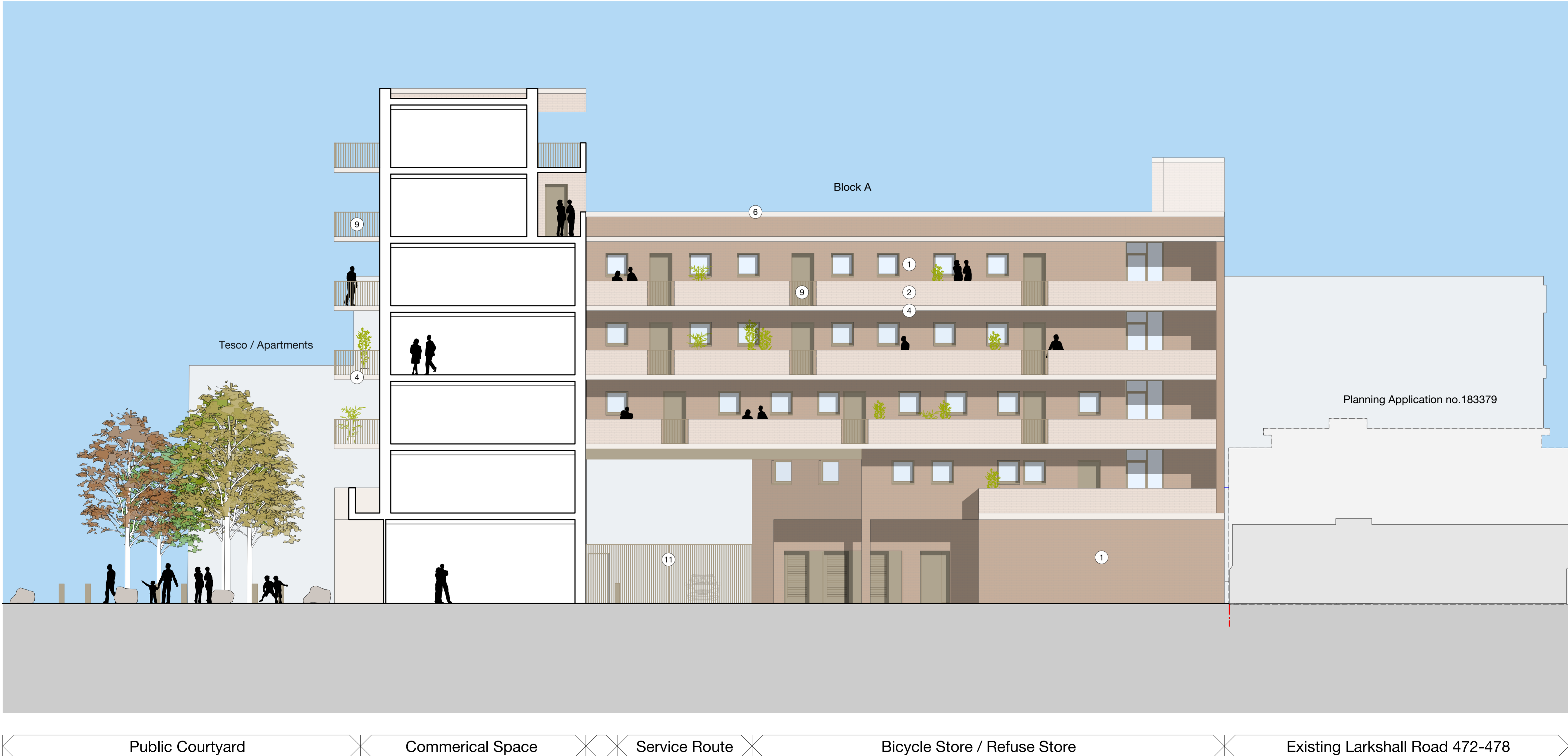

General Notes
 © Copyright Stephen Davy Peter Smith Architects 2020
 These proposals are subject to the approval of all Statutory Building Control requirements and the requirements of all Statutory Authorities and Service Providers.
 The site boundaries and surroundings are based on the following:
 • OS Map / Measured survey by Xxxxxxxx
 The site boundaries are those described by the client.
 These drawings are to be read in conjunction with all other relevant documentation produced by Stephen Davy Peter Smith Architects and other consultants employed by the client.

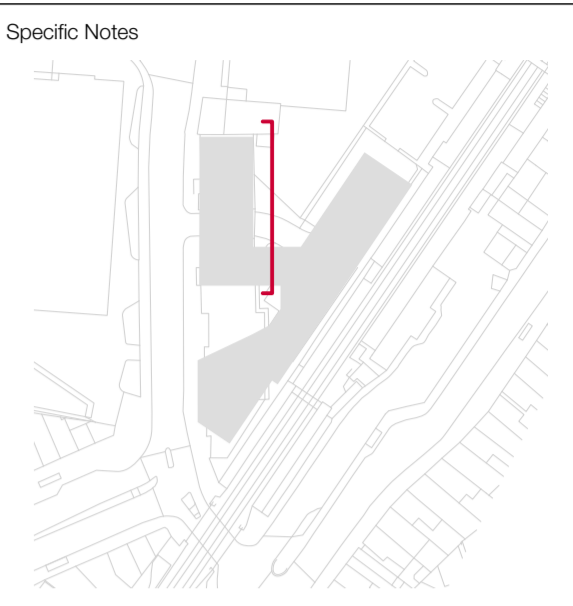

Legend

Key

Rev	Drawn	Notes	Date
P7	TK	Amended landscape. Issued for planning.	20/07/21
P6	TK	Elevation amended. Issued for planning.	28/05/21
P5	TK	Elevation amended. Issued for planning.	04/02/21

Rev	Checked	Date	Approved	Date
SD	SD			

REVISIONS

Client
Atlantis Highams Ltd

- A - APPROVED
- B - APPROVED WITH COMMENTS
- C - DO NOT USE

stephen davy architects
peter smith

Farshaw House, Farshaw Street, London N1 6HX
 Tel: 020 7739 2020 Fax: 020 7739 2021
 E-mail: sdpsa@davysmitharchitects.co.uk
 Website: www.davysmitharchitects.co.uk

Project
 Larkshall Road

Drawing Ref:
 LKR - DS - 00 - ZZ - DR - A - D203 Job No.
 1820

Purpose of Issue
PLANNING Scale
 1:100 @ A1

Drawing Title
Block A West Elevation

Project Ref - Drawing No - Status - Revision
1 8 2 0 - D 2 0 6 - S 0 - P 7

- ① **Brickwork:** Birtley Brown Waterstruck brick, stretcher bond.
- ② **Brickwork:** Flint Waterstruck brick, stretcher bond.
- ③ **Stone:** White reconstituted smooth finish stone panels, colour Portland.
- ④ **Stone:** White reconstituted smooth finish stone banding, colour Portland.
- ⑤ **Windows & Doors:** To be composite timber/powder coated aluminium, Anolok 543.
- ⑥ **Shop Front Glazing:** Anolok 543 to match windows & doors.
- ⑦ **Service Doors:** Steel louvred door, Anolok 543.
- ⑧ **Screen:** Pilkington Proflit U-shaped profiled glass.

- ⑨ **Balustrades:** Steel flats, Anolok 543.
- ⑩ **Solid Balcony Balustrades:** Steel flats, Anolok 543. Solid metal panel to inner face of balustrade.
- ⑪ **Gate:** Steel flats, Anolok 543.
- ⑫ **Coping:** Reconstituted stones copings, colour to match stone panels.
- ⑬ **New Trees.**
- ⑭ **Ceramic Tile.**
- ⑮ **Sawtooth decorative brick.**
- ⑯ **Sawtooth decorative stone panel.**

- ⑰ **Deck access balustrades:** U-shaped glass fixed within channel between anodised handrail support structure.
- ⑱ **Deck access screen:** Full height U-shaped glass spanning between walkway slabs.
- ⑲ **Deck access fins:** Full height metal fins spanning between walkway slabs, Anolok 543.



Planning Application
no. 191304

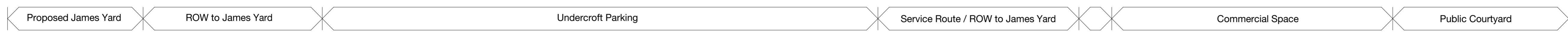

General Notes
© Copyright Stephen Davy Peter Smith Architects 2020
These proposals are subject to the approval of all Statutory Building Control requirements and the requirements of all Statutory Authorities and Service Providers.
The site boundaries and surroundings are based on the following:
• OS Map / Measured survey by Xxxxxxxx
The site boundaries are those described by the client.
These drawings are to be read in conjunction with all other relevant documentation produced by Stephen Davy Peter Smith Architects and other consultants employed by the client.

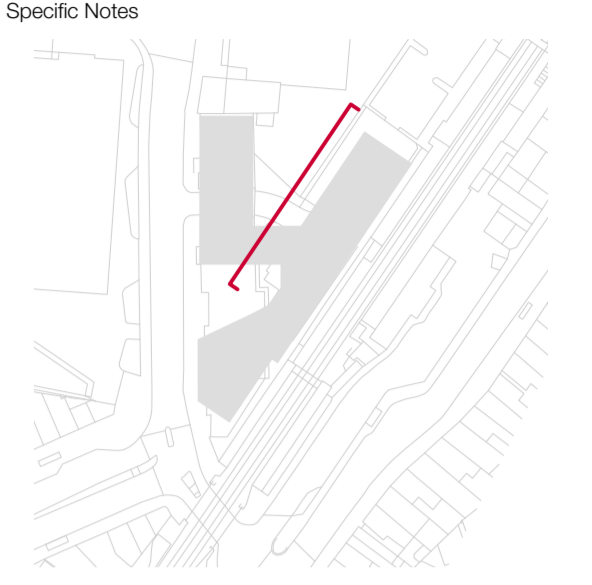

Legend

Key

Rev	Drawn	Notes	Date
P7	TK	Block B amended. Issued for planning.	09/11/21
P8	TK	Elevation amended. Issued for planning.	28/05/21
P9	TK	Elevation amended. Issued for planning.	04/02/21

Rev	Checked	Date	Approved	Date
SD				

REVISIONS

Client
Atlantis Highams Ltd

A - APPROVED
B - APPROVED WITH COMMENTS
C - DO NOT USE

CLIENT APPROVAL

stephen davy architects
peter smith
Farshaw House, Farshaw Street, London N1 6HX
Tel: 020 7739 2020 Fax: 020 7739 2021
E-mail: sdpsa@davysmitharchitects.co.uk
Website: www.davysmitharchitects.co.uk

Project Larkshall Road	
Drawing Ref. LKR - DS - 00 - ZZ - DR - A - D203	Job No. 1820
Purpose of Issue PLANNING	Scale 1:100 @ A1
Drawing Title Block B West Elevation	
Project Ref - Drawing No - Status - Revision 1 8 2 0 - D 2 0 7 - S 0 - P 7	

- ① **Brickwork:** Birtley Brown Waterstruck brick, stretcher bond.
- ② **Brickwork:** Flint Waterstruck brick, stretcher bond.
- ③ **Stone:** White reconstituted smooth finish stone panels, colour Portland.
- ④ **Stone:** White reconstituted smooth finish stone banding, colour Portland.
- ⑤ **Windows & Doors:** To be composite timber/powder coated aluminium, Anolok 543.
- ⑥ **Shop Front Glazing:** Anolok 543 to match windows & doors.
- ⑦ **Service Doors:** Steel louvred door, Anolok 543.
- ⑧ **Screen:** Pilkington Proflit U-shaped profiled glass.

- ⑨ **Balustrades:** Steel flats, Anolok 543.
- ⑩ **Solid Balcony Balustrades:** Steel flats, Anolok 543. Solid metal panel to inner face of balustrade.
- ⑪ **Gate:** Steel flats, Anolok 543.
- ⑫ **Coping:** Reconstituted stones copings, colour to match stone panels.
- ⑬ **New Trees.**
- ⑭ **Ceramic Tile.**
- ⑮ **Sawtooth decorative brick.**
- ⑯ **Sawtooth decorative stone panel.**

- ⑰ **Deck access balustrades:** U-shaped glass fixed within channel between anodised handrail support structure.
- ⑱ **Deck access screen:** Full height U-shaped glass spanning between walkway slabs.
- ⑲ **Deck access fins:** Full height metal fins spanning between walkway slabs, Anolok 543.

General Notes
 © Copyright Stephen Davy Peter Smith Architects 2021
 These proposals are subject to the approval of all Statutory Building Control requirements and the requirements of all Statutory Authorities and Service Providers.
 The site boundaries and surroundings are based on the following:
 • OS Map / Measured survey by Xxxxxxx
 The site boundaries are those described by the client.
 These drawings are to be read in conjunction with all other relevant documentation produced by Stephen Davy Peter Smith Architects and other consultants employed by the client.



Legend

Key

Rev	Drawn	Notes	Date
P9	TK	Block B amended. Issued for planning.	09/11/21
P8	TK	Tree removed. Issued for planning.	20/07/21
P7	TK	Elevation amended. Issued for planning.	28/05/21

REVISIONS

Client
Atlantis Highams Ltd

A - APPROVED
B - APPROVED WITH COMMENTS
C - DO NOT USE

CLIENT APPROVAL

stephen davy architects peter smith
 Farshaw House, Farshaw Street, London N1 6HX
 Tel: 020 7739 2020 Fax: 020 7739 2021
 E-mail: sdpsa@daysmitharchitects.co.uk
 Website: www.daysmitharchitects.co.uk

Project
 Larkshall Road

Drawing Ref. LKR - DS - 00 - ZZ - DR - A - D200	Job No. 1820
Purpose of Issue PLANNING	Scale 1:100 @ A1

Drawing Title
Section Across Station Entrance Courtyard

Project Ref - Drawing No - Status - Revision
1 8 2 0 - D 2 0 8 - S 0 - P 9



Protected
 Pedestrian
 Route

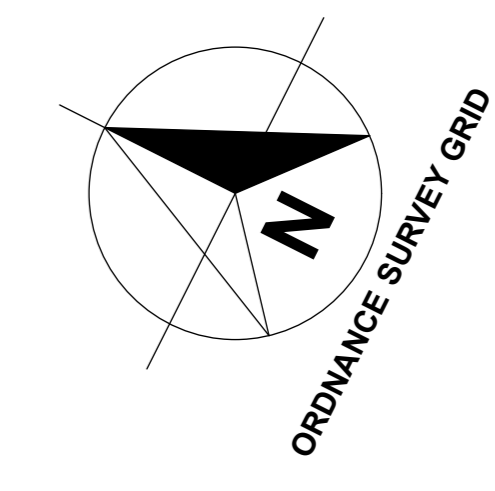

NOTES

- 1) ALL DIMENSIONS TO BE CHECKED ON SITE AND NOT SCALED FROM THIS DRAWING.
- 2) MALCOLM HOLLES SHALL BE INFORMED IN WRITING OF ANY DISCREPANCIES.
- 3) ALL DIMENSIONS ARE IN METRES ONLY.
- 4) THE ORIGIN AND ORIENTATION OF THE SURVEY GRID RELATE TO A GPS TIE TO ORDNANCE SURVEY GRID.
- 5) ALL LEVELS ARE BASED ON A GPS TIE TO OS LEVEL DATUM.

KEY

ACC	Accessories	BT	Iron Rolling Point
AC	Air Conditioning	BS	Ballroom Seat
AD	Arch Door	BS	Ballroom Seat
AD	Arch Spring	CB	Carriage Bolt
AD	Arch Spring	CB	Carriage Bolt
AD	Arch Spring	CB	Carriage Bolt
AD	Arch Spring	CB	Carriage Bolt
AD	Arch Spring	CB	Carriage Bolt
AD	Arch Spring	CB	Carriage Bolt
AD	Arch Spring	CB	Carriage Bolt
AD	Arch Spring	CB	Carriage Bolt

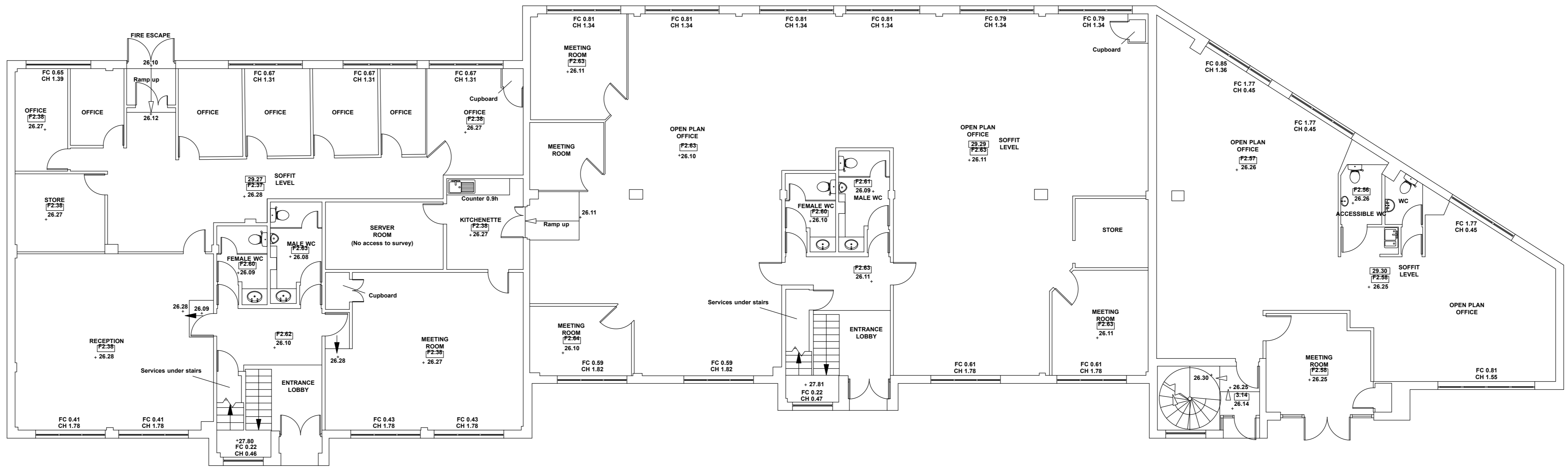
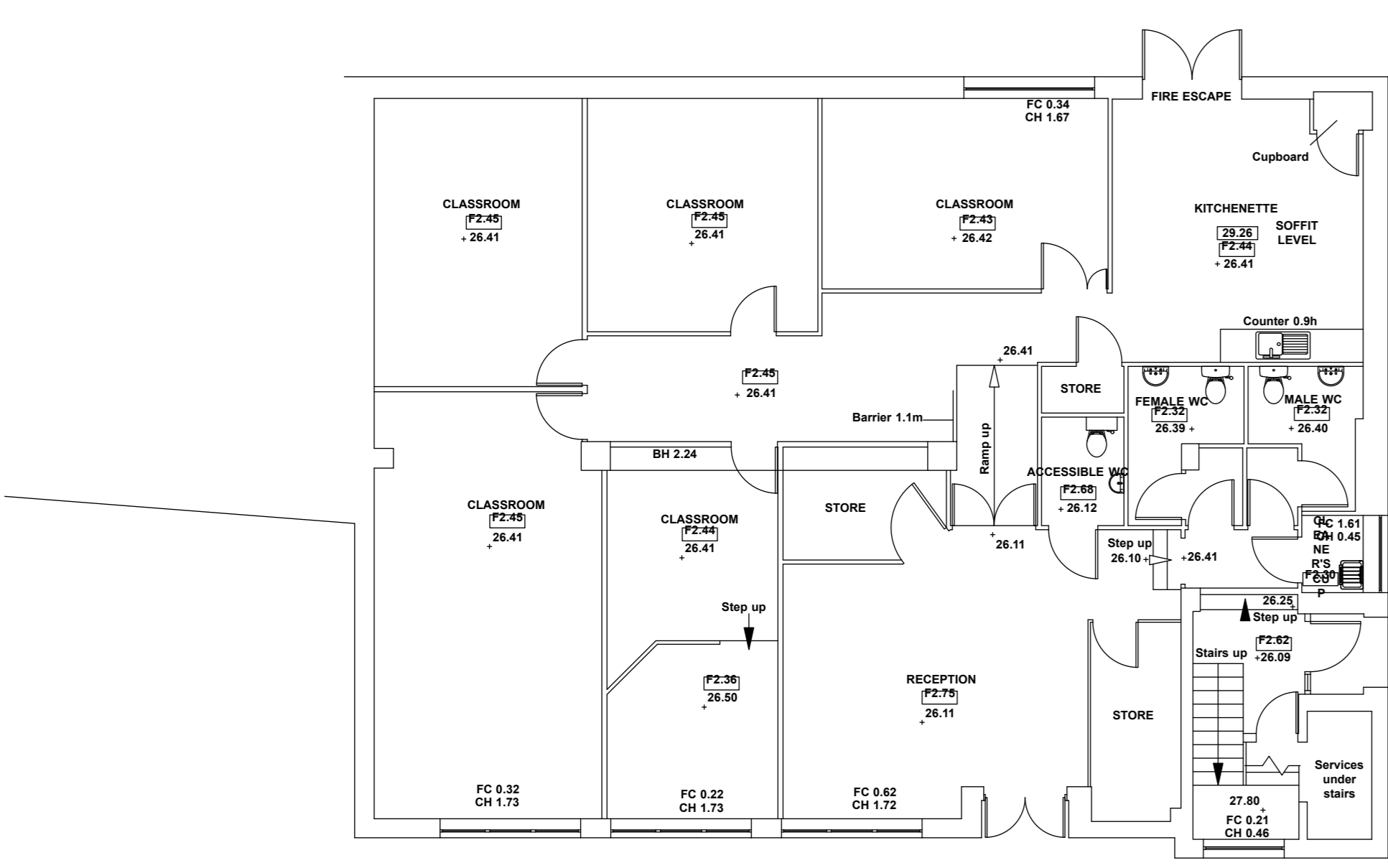

LARKSHALL ROAD

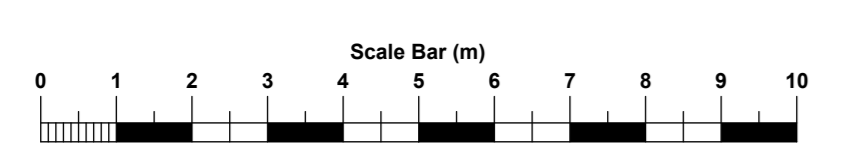

REVISIONS

No.	Date	Amendments	Initial

THIS DRAWING IS FOR THE FOLLOWING PURPOSE ONLY:
MEASURED SURVEY

TITLE
480-502 Larkshall Road
London

Ground Floor Plan

CLIENT
Hastings International
Saffron Wharf
20 Shad Tower
London, SE1 2YU

PROJECT NAME
480-502 Larkshall Road
London
E4 9HH



T 020 7622 9555
W malcolmhollis.com

DRAWN BY JH	DATE DEC 2017
SCALE 1:100 @A0	CHECKED TB
DRAWING NO. 63692-F-G	REV. NO. REV

Note: Station entrance extract, taken from feasibility study prepared on behalf of Waltham Forest.

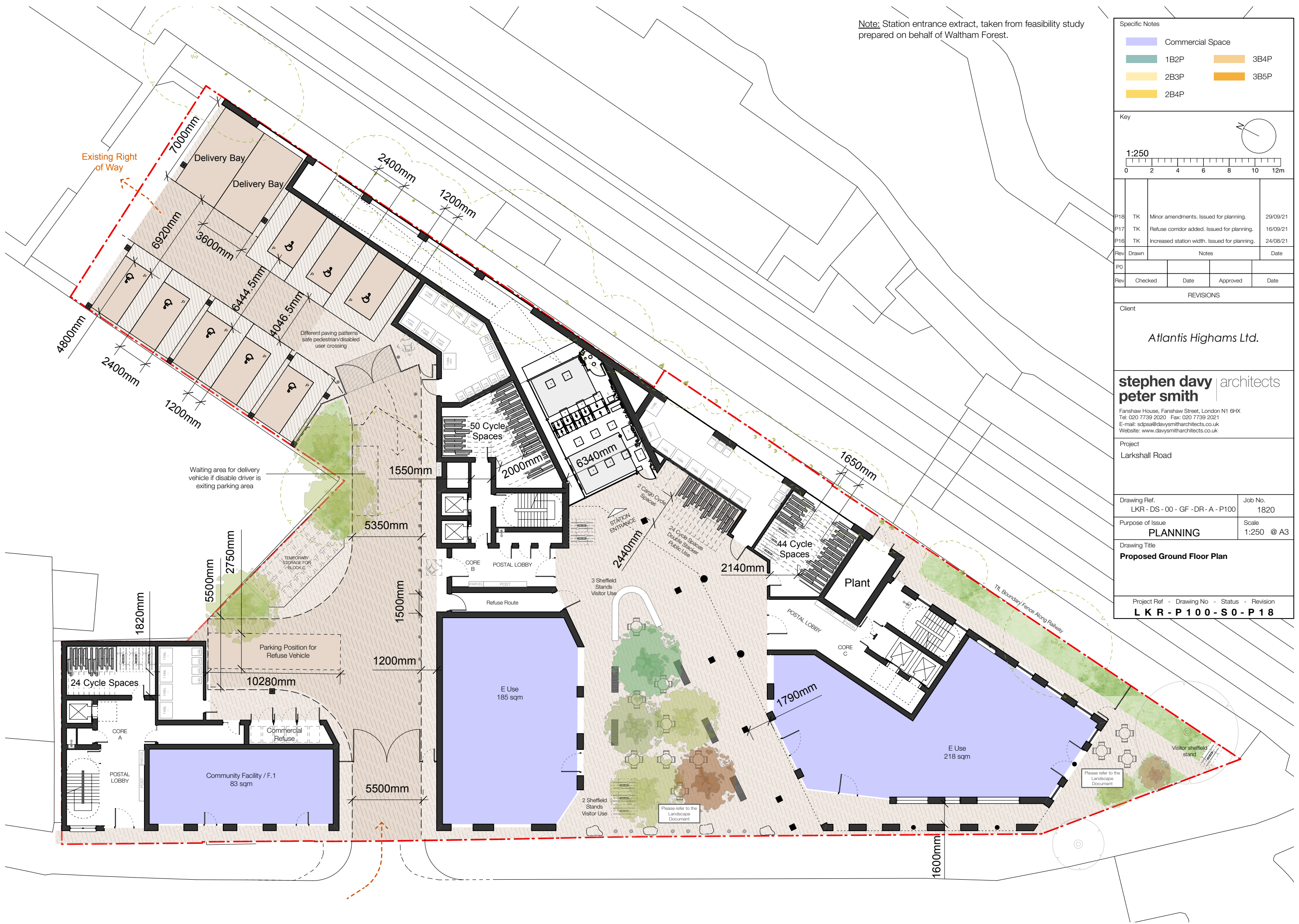

Specific Notes

- Commercial Space
- 1B2P
- 2B3P
- 2B4P
- 3B4P
- 3B5P

Key

1:250

0 2 4 6 8 10 12m

P18	TK	Minor amendments. Issued for planning.	29/09/21
P17	TK	Refuse corridor added. Issued for planning.	16/09/21
P16	TK	Increased station width. Issued for planning.	24/08/21
Rev	Drawn	Notes	Date
P0			
Rev	Checked	Date	Approved Date

REVISIONS

Client

Atlantis Highams Ltd.

stephen davy architects
peter smith

Fanshaw House, Fanshaw Street, London N1 6HX
Tel: 020 7739 2020 Fax: 020 7739 2021
E-mail: sdpsa@davysmitharchitects.co.uk
Website: www.davysmitharchitects.co.uk

Project
Larkshall Road

Drawing Ref. LKR - DS - 00 - GF - DR - A - P100	Job No. 1820
Purpose of Issue PLANNING	Scale 1:250 @ A3
Drawing Title Proposed Ground Floor Plan	
Project Ref - Drawing No - Status - Revision LKR - P100 - S0 - P18	



General Notes
 © Copyright Stephen Davy Peter Smith Architects 2021
 These proposals are subject to the approval of all Statutory Building Control requirements and the requirements of all Statutory Authorities and Service Providers.
 The site boundaries and surroundings are based on the following:
 • OS Map / Measured survey by Xxxxxxx
 The site boundaries are those described by the client.
 These drawings are to be read in conjunction with all other relevant documentation produced by Stephen Davy Peter Smith Architects and other consultants employed by the client.

Specific Notes

	Commercial Space
	1B2P
	2B3P
	3B4P
	3B5P

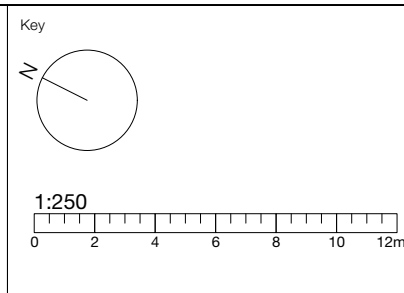

Rev	Drawn	Notes	Date
P15	TK	Unit B01.03 revised. Issued for planning.	09/11/21
P14	TK	Core B security doors. Issued for planning.	13/10/21
P13	TK	Unit A01.01 Private amenity amended. Issued for planning.	05/10/21

Rev	Checked	Date	Approved	Date
REVISIONS				

Client

Atlantis Highams Ltd.

A - APPROVED
B - APPROVED WITH COMMENTS
C - DO NOT USE

CLIENT APPROVAL

stephen davy peter smith architects
 Fanshawe House, Fanshawe Street, London N1 6HX
 Tel: 020 7739 2020 Fax: 020 7739 2021
 E-mail: sdpsa@davysmitharchitects.co.uk
 Website: www.davysmitharchitects.co.uk

Project
 Larkshall Road

Drawing Ref. LKR - DS - 00 - 01 - DR - A - P101	Job No. 1820
Purpose of Issue PLANNING	Scale 1:250 @ A3
Drawing Title Proposed First Floor Plan	
Project Ref - Drawing No - Status - Revision LKR - P101 - S0 - P14	



General Notes
 © Copyright Stephen Davy Peter Smith Architects 2021
 These proposals are subject to the approval of all Statutory Building Control requirements and the requirements of all Statutory Authorities and Service Providers.
 The site boundaries and surroundings are based on the following:
 • OS Map / Measured survey by Xxxxxxx
 The site boundaries are those described by the client.
 These drawings are to be read in conjunction with all other relevant documentation produced by Stephen Davy Peter Smith Architects and other consultants employed by the client.

Specific Notes

	Commercial Space
	1B2P
	2B3P
	2B4P
	3B4P
	3B5P

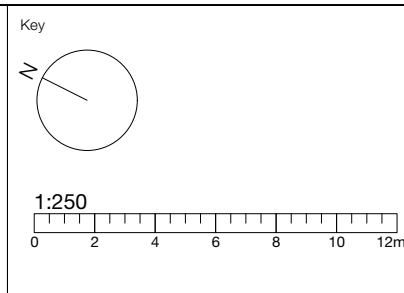

Rev	Drawn	Notes	Date
P12	TK	Green roof shape revised. Issued for planning.	09/11/21
P11	TK	Core B security doors. Issued for planning.	13/10/21
P10	TK	WHC unit relocated. Issued for planning.	17/09/21

Rev	Checked	Date	Approved	Date
REVISIONS				

Client

Atlantis Highams Ltd.

A - APPROVED
B - APPROVED WITH COMMENTS
C - DO NOT USE

CLIENT APPROVAL

stephen davy peter smith architects
 Fanshawe House, Fanshawe Street, London N1 6HX
 Tel: 020 7739 2020 Fax: 020 7739 2021
 E-mail: sdpsa@davysmitharchitects.co.uk
 Website: www.davysmitharchitects.co.uk







Project
 Larkshall Road

Drawing Ref. LKR - DS - 00 - 02 - DR - A - P102	Job No. 1820
Purpose of Issue PLANNING	Scale 1:250 @ A3
Drawing Title Proposed Second Floor Plan	
Project Ref - Drawing No - Status - Revision LKR - P102 - S0 - P12	



General Notes
 © Copyright Stephen Davy Peter Smith Architects 2021
 These proposals are subject to the approval of all Statutory Building Control requirements and the requirements of all Statutory Authorities and Service Providers.
 The site boundaries and surroundings are based on the following:
 • OS Map / Measured survey by Xxxxxxx
 The site boundaries are those described by the client.
 These drawings are to be read in conjunction with all other relevant documentation produced by Stephen Davy Peter Smith Architects and other consultants employed by the client.

Specific Notes

	Commercial Space
	1B2P
	2B3P
	2B4P
	3B4P
	3B5P

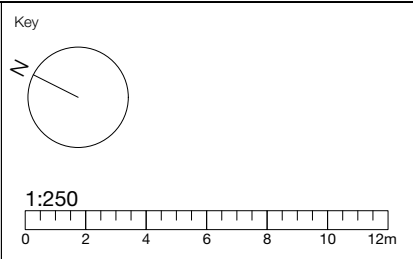

Rev	Drawn	Notes	Date
P1	TK	Block B amended. Issued for planning.	09/11/21
0	TK	Core B security doors. Issued for planning.	13/10/21
P9	TK	WCH unit relocated. Issued for planning.	17/09/21
P8	TK		

Rev	Checked	Date	Approved	Date
SD	SD			
Rev	Checked	Date	Approved	Date

REVISIONS

Client
Atlantis Highams Ltd.

stephen davy peter smith architects
 Fanshawe House, Fanshawe Street, London N1 6HX
 Tel: 020 7739 2020 Fax: 020 7739 2021
 E-mail: sdpsa@davysmitharchitects.co.uk
 Website: www.davysmitharchitects.co.uk

Project
 Larkshall Road

Drawing Ref. 1820 - DS - 00 - 03 - DR - A - P103	Job No. 1820
Purpose of Issue PLANNING	Scale 1:250 @ A3
Drawing Title Proposed Third Floor Plan	
Project Ref - Drawing No - Status - Revision LKR - P103 - S0 - P10	



General Notes
 © Copyright Stephen Davy Peter Smith Architects 2018
 These proposals are subject to the approval of all Statutory Building Control requirements and the requirements of all Statutory Authorities and Service Providers.
 The site boundaries and surroundings are based on the following:
 • OS Map / Measured survey by Xxxxxxx
 The site boundaries are those described by the client.
 These drawings are to be read in conjunction with all other relevant documentation produced by Stephen Davy Peter Smith Architects and other consultants employed by the client.

Specific Notes

 Commercial Space	
 1B2P	
 2B3P	 3B4P
 2B4P	 3B5P

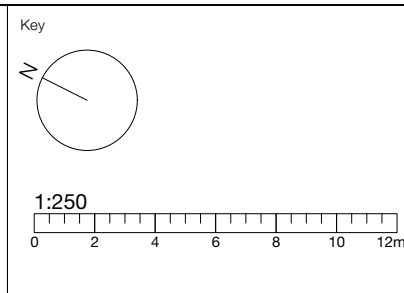

Rev	Drawn	Notes	Date
P10	TK	Core B security doors. Issued for planning.	13/10/21
P9	TK	WHC unit relocated. Issued for planning.	17/09/21
P8	CM	CO4.01 balcony amended. Issued for information	22/09/20

Rev	Checked	Date	Approved	Date
REVISIONS				

Client

Atlantis Highams Ltd.

A - APPROVED
B - APPROVED WITH COMMENTS
C - DO NOT USE

CLIENT APPROVAL

stephen davy peter smith architects
 Fanshawe House, Fanshawe Street, London N1 6HX
 Tel: 020 7739 2020 Fax: 020 7739 2021
 E-mail: sdpsa@davysmitharchitects.co.uk
 Website: www.davysmitharchitects.co.uk

Project
 Larkshall Road

Drawing Ref. LKR - DS - 00 - 04 - DR - A - P104	Job No. 1820
Purpose of Issue PLANNING	Scale 1:250 @ A3
Drawing Title Proposed Fourth Floor Plan	
Project Ref - Drawing No - Status - Revision LKR - P104 - S0 - P10	



General Notes
 © Copyright Stephen Davy Peter Smith Architects 2021
 These proposals are subject to the approval of all Statutory Building Control requirements and the requirements of all Statutory Authorities and Service Providers.
 The site boundaries and surroundings are based on the following:
 • OS Map / Measured survey by Xxxxxxx
 The site boundaries are those described by the client.
 These drawings are to be read in conjunction with all other relevant documentation produced by Stephen Davy Peter Smith Architects and other consultants employed by the client.

Specific Notes

	Commercial Space
	1B2P
	2B3P
	3B4P
	2B4P
	3B5P

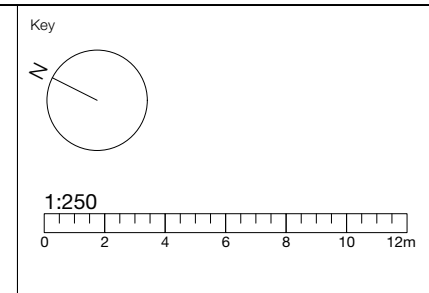

Rev	Drawn	Notes	Date
P15	TK	Core B security doors. Issued for planning.	13/10/21
P14	TK	Unit B05.05 converted to WHC. Issued for planning.	28/09/21
P13	TK	Unit B05.06 terrace reduced. Issued for planning.	23/09/21

Rev	Checked	Date	Approved	Date
REVISIONS				

Client

Atlantis Highams Ltd.

A - APPROVED
B - APPROVED WITH COMMENTS
C - DO NOT USE

CLIENT APPROVAL

stephen davy peter smith architects
 Fanshawe House, Fanshawe Street, London N1 6HX
 Tel: 020 7739 2020 Fax: 020 7739 2021
 E-mail: sdpsa@davysmitharchitects.co.uk
 Website: www.davysmitharchitects.co.uk

Project
 Larkshall Road

Drawing Ref. LKR - DS - 00 - 05 - DR - A - P105	Job No. 1820
Purpose of Issue PLANNING	Scale 1:250 @ A3
Drawing Title Proposed Fifth Floor Plan	
Project Ref - Drawing No - Status - Revision LKR - P105 - S0 - P14	



General Notes
 © Copyright Stephen Davy Peter Smith Architects 2021
 These proposals are subject to the approval of all Statutory Building Control requirements and the requirements of all Statutory Authorities and Service Providers.
 The site boundaries and surroundings are based on the following:
 • OS Map / Measured survey by Xxxxxxx
 The site boundaries are those described by the client.
 These drawings are to be read in conjunction with all other relevant documentation produced by Stephen Davy Peter Smith Architects and other consultants employed by the client.

Specific Notes

	Commercial Space
	1B2P
	2B3P
	3B4P
	2B4P
	3B5P

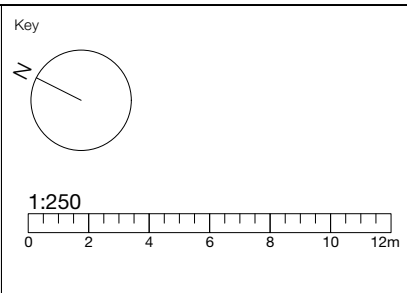

Rev	Drawn	Notes	Date
P13	TK	Unit B06.03 amenity revised. Issued for planning.	09/11/21
P12	TK	Core B security doors. Issued for planning.	13/10/21
P11	TK	Amended landscape. Issued for planning.	14/07/21

Rev	Checked	Date	Approved	Date
REVISIONS				

Client	
<i>Atlantis Highams Ltd.</i>	
A - APPROVED	Project
B - APPROVED WITH COMMENTS	Larkshall Road
C - DO NOT USE	
CLIENT APPROVAL	

stephen davy peter smith architects
 Fanshaw House, Fanshaw Street, London N1 6HX
 Tel: 020 7739 2020 Fax: 020 7739 2021
 E-mail: sdpsa@davysmitharchitects.co.uk
 Website: www.davysmitharchitects.co.uk

Drawing Ref. LKR - DS - 00 - 05 - DR - A - P106	Job No. 1820
Purpose of Issue PLANNING	Scale 1:250 @ A3
Drawing Title Proposed Sixth Floor Plan	
Project Ref - Drawing No - Status - Revision LKR - P106 - S0 - P13	

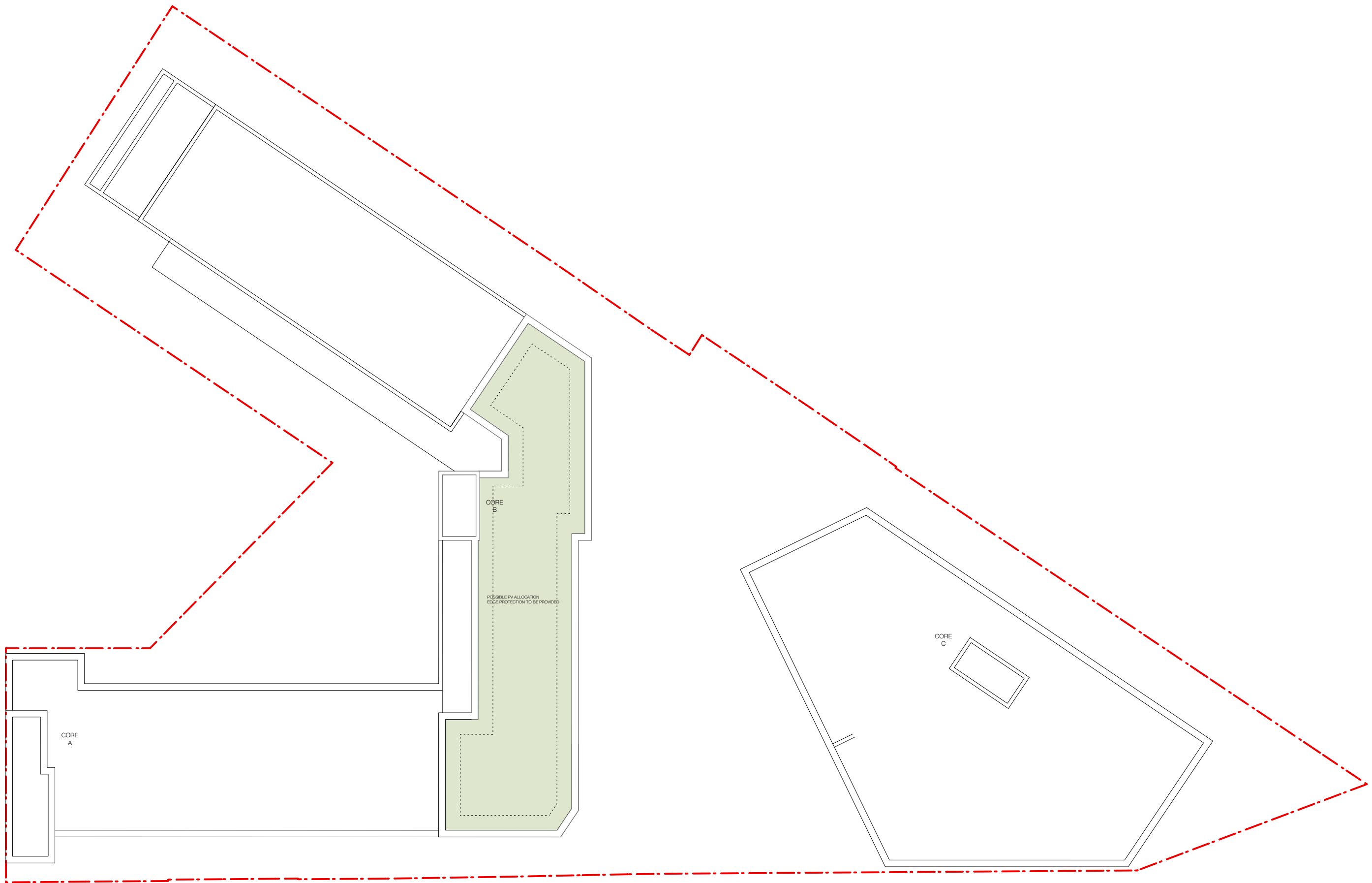

General Notes
 © Copyright Stephen Davy Peter Smith Architects 2021
 These proposals are subject to the approval of all Statutory Building Control requirements and the requirements of all Statutory Authorities and Service Providers.
 The site boundaries and surroundings are based on the following:
 • OS Map / Measured survey by Xxxxxxx
 The site boundaries are those described by the client.
 These drawings are to be read in conjunction with all other relevant documentation produced by Stephen Davy Peter Smith Architects and other consultants employed by the client.

Specific Notes

	Commercial Space
	1B2P
	2B3P
	2B4P
	3B4P
	3B5P

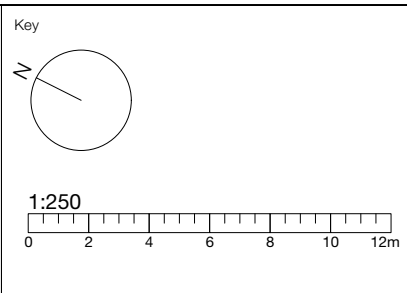

Rev	Drawn	Notes	Date
P8	TK	Roof shape revised. Issued for planning.	09/11/21
P7	TK	Issued for planning.	12/08/21
P6	TK	Issued for planning	15/02/21

Rev	Checked	Date	Approved	Date
REVISIONS				

Client

Atlantis Highams Ltd.

A - APPROVED
B - APPROVED WITH COMMENTS
C - DO NOT USE

CLIENT APPROVAL

stephen davy peter smith architects
 Fanshaw House, Fanshaw Street, London N1 6HX
 Tel: 020 7739 2020 Fax: 020 7739 2021
 E-mail: sdpsa@davysmitharchitects.co.uk
 Website: www.davysmitharchitects.co.uk

Project
 Larkshall Road

Drawing Ref. LKR - DS - 00 - 07 - DR - A - P107	Job No. 1820
Purpose of Issue PLANNING	Scale 1:250 @ A3
Drawing Title Proposed Roof Plan	
Project Ref - Drawing No - Status - Revision LKR - P107 - S0 - P8	