

Appendix A

Assets already sold or approved to be marketed (i.e. declared 'surplus')

HRA Non-Residential Surplus Assets
July 2024 Cabinet

Site Name	Original Use	Current Use	Sale Price (£)	Sold
546 Bath Road	Development	Development	£503,500	Y
Akzo Nobel	Development	Development	£143,750,000	Y
Merry Makers + 313/323 Trelawney Av	Public House	Development	£2,910,000	Y
Lavender Farm	Development	Development	£1,775,000	Y
Earl Of Cornwall Public House	Public House	Public House	£831,000	Y
Land at Uxbridge (Demolished Rochfords Canteen)	Development	Development		Under Offer
Former Police Station Trelawney Av	Police Station	Development		Under Offer
Sheehy Way	Car Park	Land		Under Offer
Land at Langley College	Development	Development		N
Cippenham Green	Community	Land		N
Stile Road Garage Compound	Garages	Development		N
Goldsworthy Way Garage Compound	Garages	Development		N
Churchill Road Garage Compound	Garages	Development		N
Land at High Street Chalvey / Spack	Land	Development		N
Northborough Road	Land	Development		N
Land to Rear Knolton Way Shops	Land	Development		N
Garage No 103, Trelawney Avenue	Garage	Development		N

Appendix B

Assets proposed as 'surplus' that do not require resident consultation

HRA Non-Residential Surplus Assets

July 2024 Cabinet

Site Name	Original Use	Current Use	Justification for Proposed 'Surplus' Status
Shops At Trelawney Avenue - Long leasehold	Retail	Retail	Retail units not required to be kept as shops connected
74 , 80,82,86,88,90,96,98 And 104 Knolton Way - Lon	Retail	Retail	Retail units not required to be kept as shops connected to housing estate and can be disposed of on long lease. Residential units above and freehold title will remain in Council ownership.
5,7,9,11 And 13 Harrison Way - Long leasehold	Retail	Retail	Retail units not required to be kept as shops connected to housing estate and can be disposed of on long lease. Residential units above and freehold title will remain in Council ownership.
84 Saint Andrews Way - Long leasehold	Retail	Retail	Retail units not required to be kept as shops connected to housing estate and can be disposed of on long lease. Residential units above and freehold title will remain in Council ownership.
55 & 61 Cheviot Road - Long leasehold	Retail	Retail	Retail units not required to be kept as shops connected to housing estate and can be disposed of on long lease. Residential units above and freehold title will remain in Council ownership.
53 & 59 Cheviot Road - Long leasehold	Retail	Retail	Retail units not required to be kept as shops connected to housing estate and can be disposed of on long lease. Residential units above and freehold title will remain in Council ownership.
51 Cheviot Road - Long leasehold	Retail	Retail	Retail units not required to be kept as shops connected to housing estate and can be disposed of on long lease. Residential units above and freehold title will remain in Council ownership.
9 Minster Way - Long leasehold	Retail	Retail	Retail units not required to be kept as shops connected to housing estate and can be disposed of on long lease. Residential units above and freehold title will remain in Council ownership.
2 And 6 Stoneymeade - Long leasehold	Retail	Retail	Retail units not required to be kept as shops connected to housing estate and can be disposed of on long lease. Residential units above and freehold title will remain in Council ownership.
9-14 Anslow Place Shops - Long leasehold	Retail	Retail	Retail units not required to be kept as shops connected to housing estate and can be disposed of on long lease. Residential units above and freehold title will remain in Council ownership.
Langley Kederminster, 1-14 & 126-141 Trelawney Avenue	Garages	Development	Beyond economic repair. Not in use. Does not generate any revenue. Site Plan in Appendix D
Langley Kederminster, 102-125 Trelawney Avenue	Garages	Development	Garages demolished. Does not generate any revenue. Site Plan in Appendix D
Britwell and Northborough, 694- 704 Fairview Road	Garages	Development	Garages demolished. Does not generate any revenue. Site Plan in Appendix D
Foxborough, 108-129 Grampian Way	Garages	Development	Beyond economic repair. Not in use. Does not generate any revenue. Site Plan in Appendix D
Baylis Stoke, 1- 13 Hawthorne Crescent of Stewart Avenue	Garages	Development	Beyond economic repair. Not in use. Does not generate any revenue. Site Plan in Appendix D
Baylis Stoke, 30-33 Hawthorne Crescent of Stewart Avenue	Garages	Development	Beyond economic repair. Not in use. Site Plan in Appendix D
HR	Land	Land	Beyond economic repair. Not in use. Does not generate any revenue. Site Plan in Appendix D
Tower and Ashbourne House	Housing	Development	Both blocks demolished. Site Plan in Appendix D

Appendix C

Assets proposed as 'surplus' that are likely to require resident consultation

HRA Non-Residential Surplus Assets

July 2024 Cabinet

Site Name	Original Use	Current Use	Reason for Resident Consultation Being Required	Justification for Proposed 'Surplus' Status
1-28 Keel Drive- Cippenham Meadows (Site Plan in Appendix D)	Land	Land	It's an open space	Vacant land. No Housing use.
Foxborough, Slough Gateway J5 M4	Land	Development	Might be regarded as an open space	Vacant land. No Housing use.
Greenside, Farnham (Site Plan in Appendix D)	Land	Land	Might be regarded as an open space	Vacant land. No Housing use.
1- 41 Minster Way Langley St Marys (Site Plan in Appendix D)	Land	Land	Might be regarded as an open space	Vacant land. No Housing use.
Britwell and Northborough, 571-581 Long Furlong Drive (Site Plan in Appendix D)	Land	Land	Might be regarded as an open space	Vacant land. No Housing use.
Mercian Way, Cippenham Green (Site Plan in Appendix D)	Parks House	Development	Might be regarded as an open space	Vacant land. No Housing use.

HRA Non-Residential Surplus Assets
May 2024 Cabinet

Appendix B Site plans



Shops At Trelawney Avenue - Long leasehold

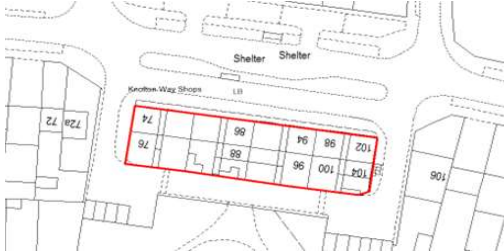

74 , 80,82,86,88,90,96,98 And 104 Knolton Way - Long leasehold



5,7,9,11 And 13 Harrison Way - Long leasehold

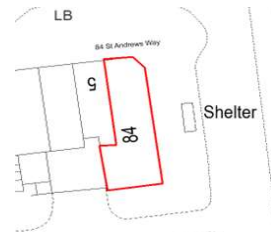

84 Saint Andrews Way - Long leasehold

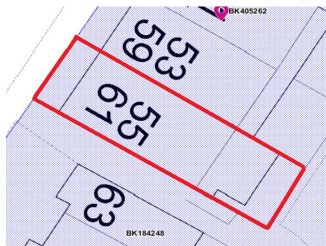

55 & 61 Cheviot Road - Long leasehold

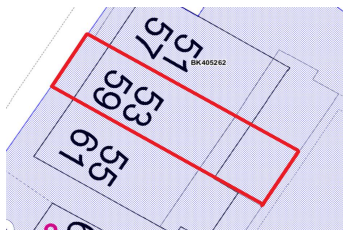

53 & 59 Cheviot Road - Long leasehold

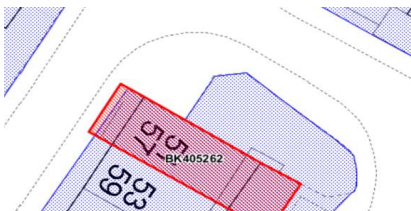

51 Cheviot Road - Long leasehold

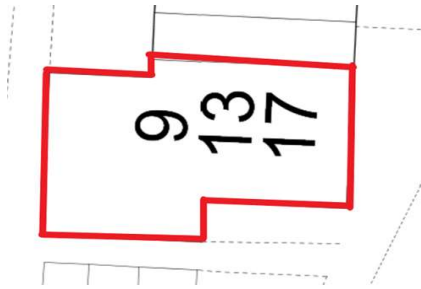

9 Minster Way - Long leasehold

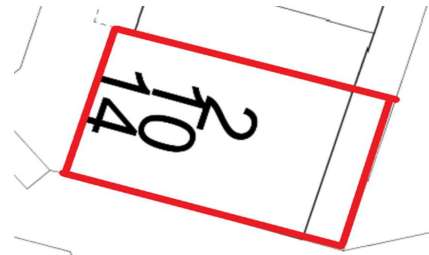

2 And 6 Stoneymeade - Long leasehold

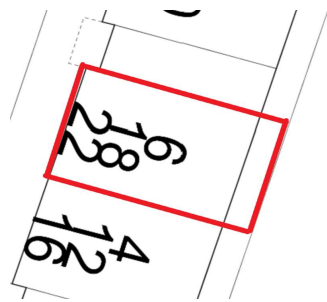

9-14 Anslow Place Shops - Long leasehold



Langley Kederminster, 1-14 & 126-141 Trelawney Avenue



Langley Kederminster, 102-125 Trelawney Avenue



Britwell and Northborough, 694- 704 Fairview Road

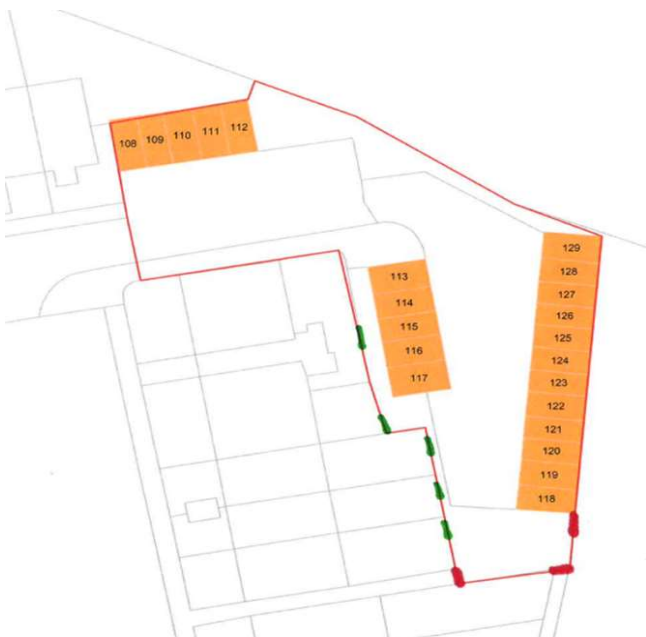

Foxborough, 108-129 Grampian Way

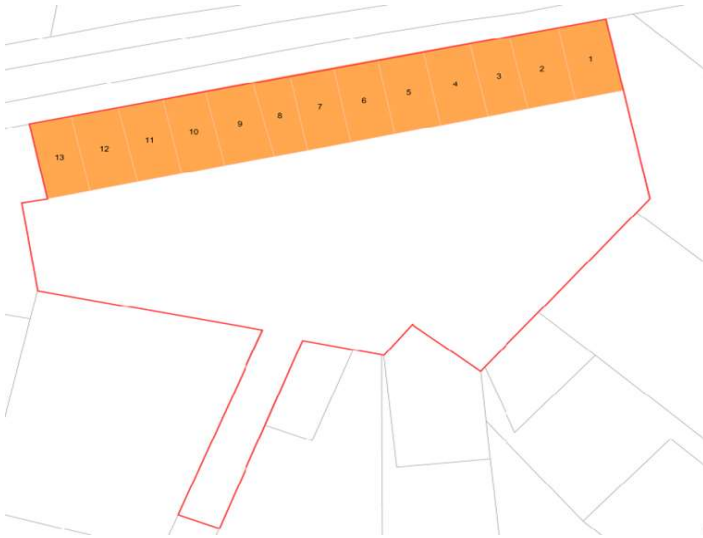

1- 13 Hawthorne Crescent of Stewart Avenue

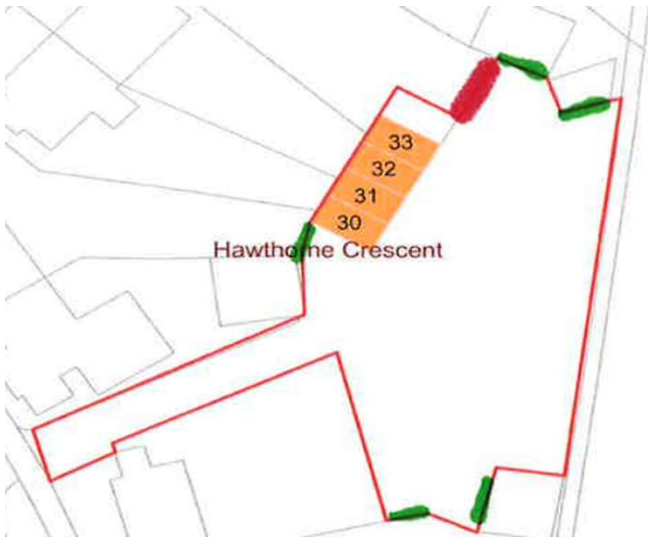

30-33 Hawthorne Crescent

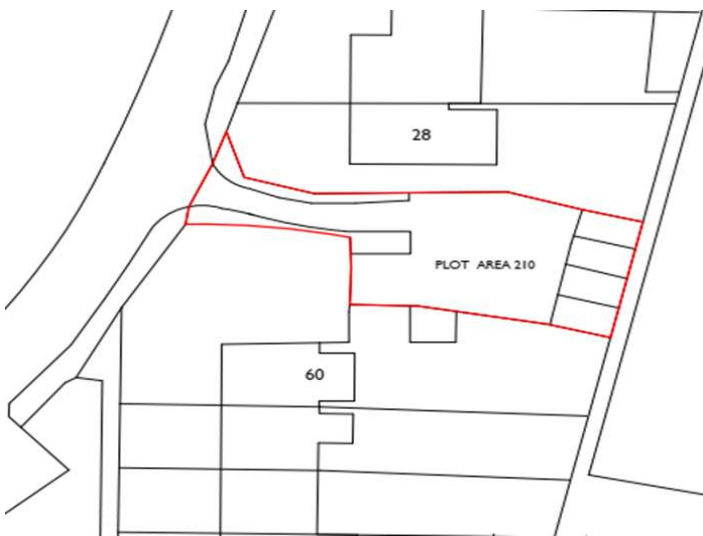

Lynch Hill Lane



Tower and Ashbourne House



Appendix C Site Plans

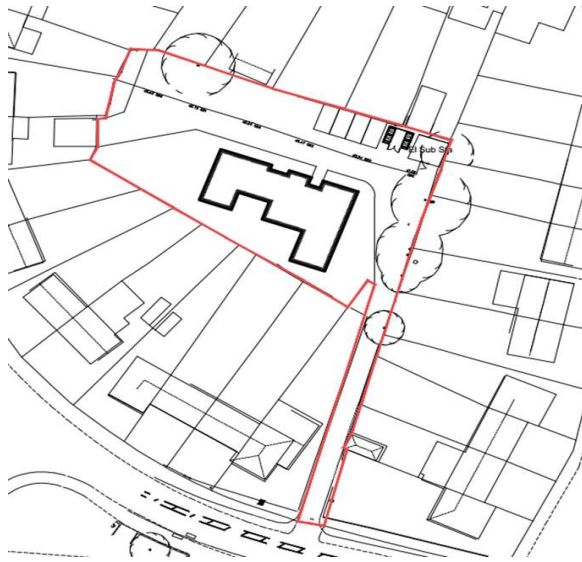

1-28 Keel Drive- Cippenham Meadows

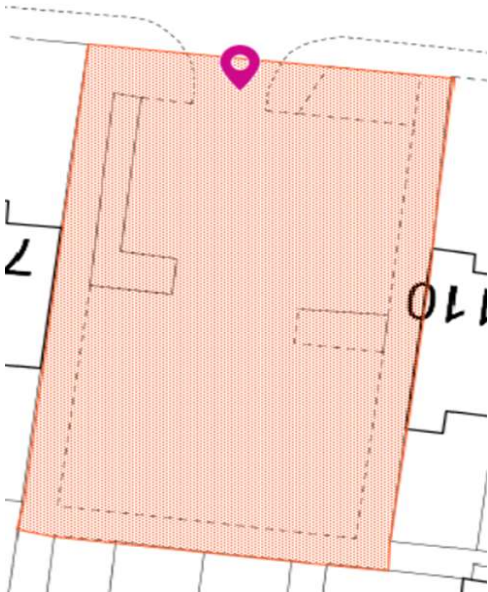

Greenside, Farnham



1- 41 Minster Way Langley St Marys

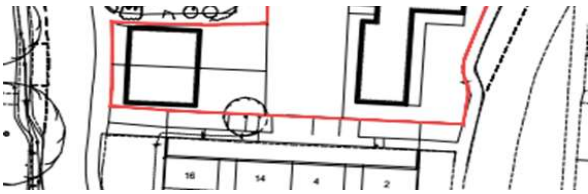

Britwell and Northborough, 571-581 Long Furlong Drive

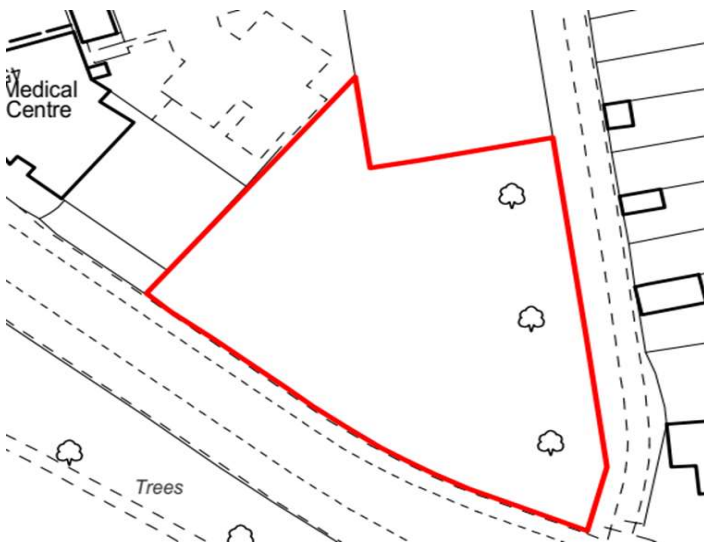

Mercian Way, Cippenham Green