

Notes

Any structure shown is intent only and shown indicatively and all subject to detailed design by others.

Any discrepancies are to be reported before any works commence. Where discrepancies do occurs between CMP and other consultants information, the consultants reports and specifications should take precedence when the information is specifically related.

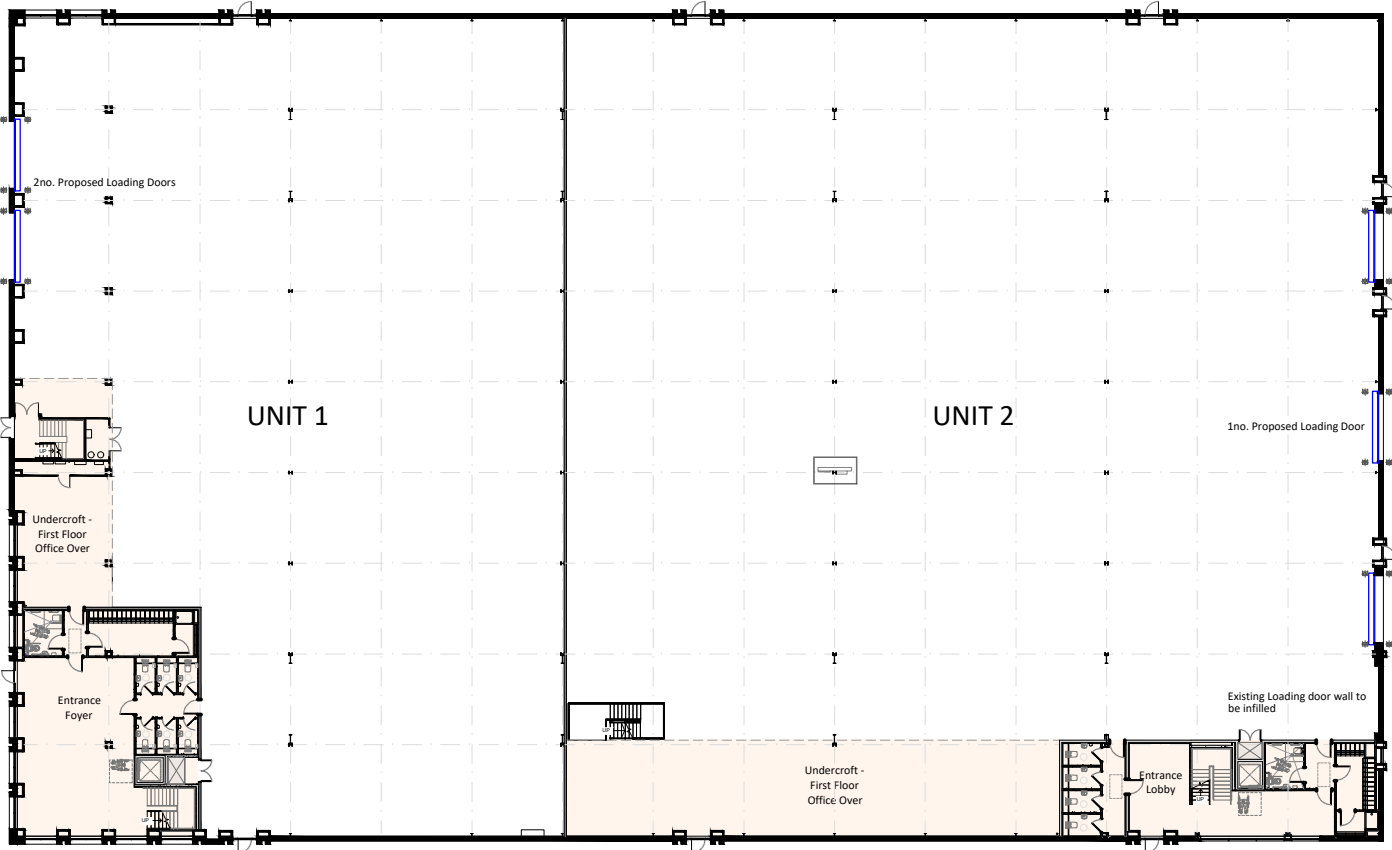

PL1 Planning Issue

CF - 18.09.25

Drawing Status:  
**PLANNING**

**CMP**  
Architects

Client  
HINES

Project  
Kings Hill, Birmingham

Title  
Proposed GFL GA Plan

Scale @ A3	Drawn	Date	Revision
1:500	CF	05.09.2025	PL1

Drg.No.

**B120-CMP-XX-00-DR-A-01100**

Subject to accurate site survey. All dimensions to be checked and verified for any discrepancies. All drawings to be read in conjunction with all CMP Architects and other consultants' contract documentation. Any discrepancies to be reported before any work commences. All items installed by others are to be fully site coordinated and programmed with the Contractor. All products to be installed to manufacturers recommendations. ©Copyright CMP Architects Ltd