

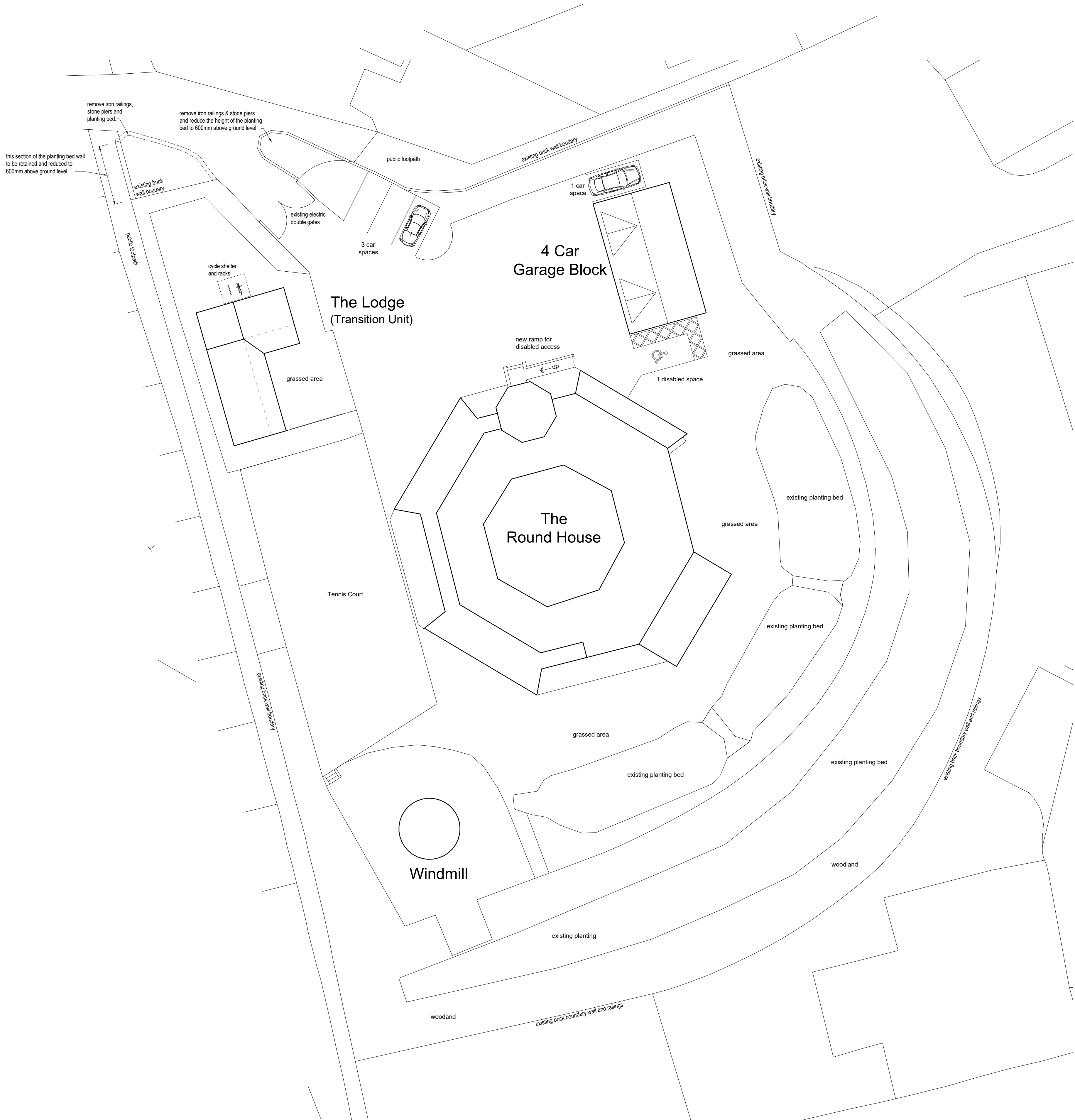

GENERAL NOTES:

1. This drawing is copyright © and remains the property of KEY architectural design limited.
2. Any discrepancies in dimensions or details between the various drawings should be reported immediately.
3. All dimensions are in millimeters and all levels are in metres.
4. The builder and any other contractor employed to undertake the works described shall ensure the stability of the existing and the new structure at all times.



Proposed Site Plan

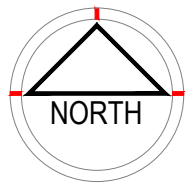

Rev	Note	Date
-----	------	------



Client
Gracebridge Care

Project
Proposed Change of Use from C3 to C2

at Reservoir Passage, Wednesbury, West Midlands. WS10 9DH

drawing title
Proposed Site Plan

scale 1:200@A1	drawn by DKT	project no. 25-123	rev -
date 16.06.2025	checked by DKT	dwg no. P03	